

PM SERIES: PRIMETRIC™ PLANETARY GEARHEADS

SINGLE, DOUBLE, TRIPLE STAGE PRECISION HIGH PERFORMANCE GEARHEADS

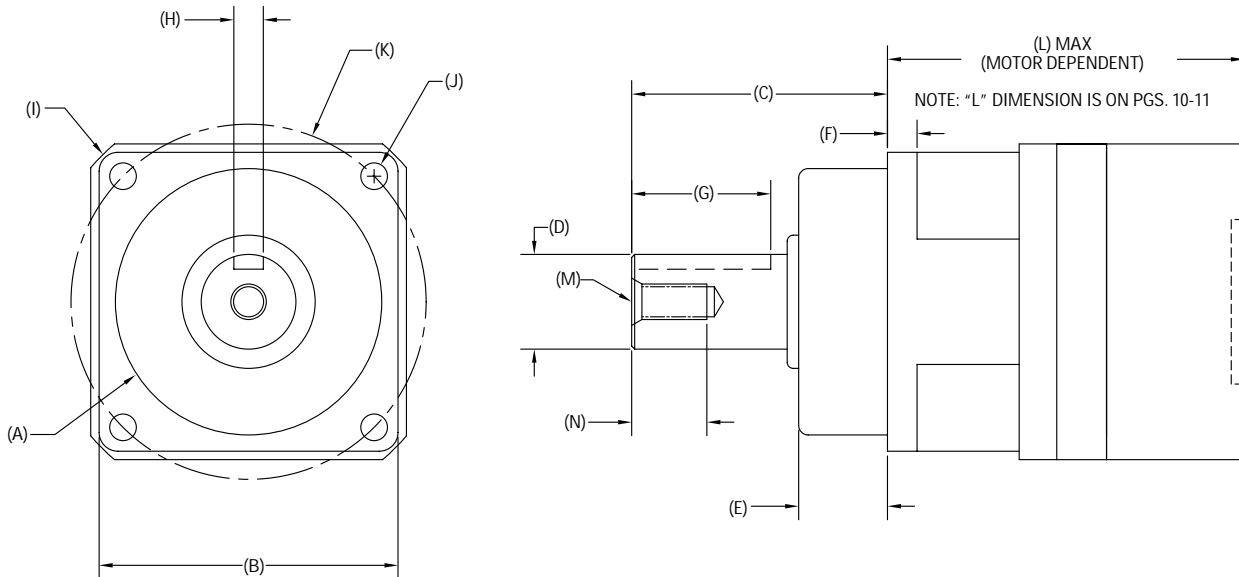

PART NUMBER	A PILOT DIAMETER mm (in.)	B SQUARE FLANGE mm (in.)	C SHAFT LENGTH mm (in.)	D SHAFT DIAMETER mm (in.)	E PILOT LENGTH mm (in.)	F FLANGE THICKNESS mm (in.)	G KEY LENGTH mm (in.)
040PMX	40.0 (1.575)	42.0 (1.654)	30.0 (1.181)	13.00 (.5118)	12.0 (.472)	5.0 (.197)	16.0 (.62)
060PMX	60.0 (2.362)	62.0 (2.441)	47.0 (1.850)	16.00 (.6299)	20.0 (.787)	6.0 (.236)	20.0 (.79)
075PMX	70.0 (2.756)	76.0 (2.992)	56.0 (2.205)	22.00 (.8661)	20.0 (.787)	7.0 (.276)	30.0 (1.18)
100PMX	90.0 (3.543)	101.0 (3.976)	86.5 (3.406)	32.00 (1.2598)	30.0 (1.181)	10.0 (.394)	47.0 (1.85)
140PMX	130.0 (5.118)	141.0 (5.551)	112.0 (4.409)	40.00 (1.5748)	30.0 (1.181)	19.0 (.748)	47.0 (1.85)
180PMX	160.0 (6.299)	182.0 (7.165)	112.0 (4.409)	55.00 (2.1654)	30.0 (1.181)	22.2 (.874)	60.0 (2.36)

PART NUMBER	H KEY WIDTH mm (in.)	I HOUSING DIAMETER mm (in.)	J BOLT HOLE DIAMETER mm (in.)	K BOLT HOLE CIRCLE mm (in.)	M THREAD	N THREAD DEPTH mm (in.)	RADIAL & AXIAL SHAFT LOADING (LBS.)
040PMX	5.0 (.197)	52.0 (2.047)	4.5 (.177)	30.0 (1.181)	M4 x 0.7	12.0 (.472)	SEE PAGE 16
060PMX	5.0 (.197)	85.0 (3.346)	5.5 (.217)	68.0 (2.677)	M5 x 0.8	12.7 (.500)	
075PMX	8.0 (.315)	111.0 (4.370)	6.6 (.260)	85.0 (3.346)	M8 x 1.25	16.0 (.630)	
100PMX	10.0 (.394)	140.0 (5.512)	9.0 (.354)	120.0 (4.724)	M12 x 1.75	25.4 (1.000)	
140PMX	12.0 (.472)	200.0 (7.874)	11.0 (.433)	165.0 (6.496)	M16 x 1.5	32.0 (1.260)	
180PMX	16.0 (.630)	245.0 (9.646)	13.0 (.512)	215.0 (8.465)	M20 x 1.5	42.0 (1.654)	

AVAILABLE RATIOS	EFFICIENCY	SPECIFICATIONS
SINGLE STAGE : 3:1 / 4:1 / 5:1 / 5.5:1 / 7:1 / 10:1	90%	Input RPM: 6500 Max.
DOUBLE STAGE : 15:1/16:1/20:1/22:1/25:1/28:1/30:1/40:1/49:1/50:1/55:1/70:1/100:1	85%	Operating Temperature Range -60°F to +255°F
TRIPLE STAGE : 160:1 / 280:1 / 400:1 / 550:1 / 700:1 OTHER RATIOS AVAILABLE	80%	Motor Mounting Hardware Supplied

NEW METRIC DESIGN.



ALL SPECIFICATIONS SUBJECT TO CHANGE.

PM SERIES: PRIMETRIC™ PLANETARY GEARHEADS

SINGLE, DOUBLE, TRIPLE STAGE

MODEL	RATIO	TORQUE RATING		INERTIA		BACKLASH	GEARHEAD	L
		T _c IN LBS.	T _{PEAK} IN LBS.	INPUT PINION OZ IN SEC ²	GEARHEAD OZ IN SEC ²	STD/ LOW ARC MINUTES	WEIGHT LBS.	GEARHEAD LENGTH
040PMX	3:1	167	261	2.163E-04	1.669E-04	6 / 3	1.0	2.74
040PMX	4:1	158	248	1.352E-04	1.053E-04	6 / 3	1.0	2.74
040PMX	5:1	148	231	1.203E-04	6.954E-05	6 / 3	1.0	2.74
040PMX	5.5:1	143	223	1.174E-04	5.870E-05	6 / 3	1.0	2.74
040PMX	7:1	119	158	1.143E-04	3.692E-05	6 / 3	1.0	2.74
040PMX	10:1	56	84	1.132E-04	1.833E-05	6 / 3	1.0	2.74
040PMX	15:1	178	277	1.203E-04	7.482E-05	10 / 5	1.6	3.28
040PMX	16:1	169	264	1.352E-04	1.045E-04	10 / 5	1.6	3.28
040PMX	20:1	170	266	1.203E-04	6.906E-05	10 / 5	1.6	3.28
040PMX	22:1	171	267	1.174E-04	5.830E-05	10 / 5	1.6	3.28
040PMX	25:1	159	247	1.203E-04	6.699E-05	10 / 5	1.6	3.28
040PMX	28:1	172	269	1.143E-04	3.667E-05	10 / 5	1.6	3.28
040PMX	30:1	183	285	1.132E-04	1.965E-05	10 / 5	1.6	3.28
040PMX	40:1	174	272	1.132E-04	1.821E-05	10 / 5	1.6	3.28
040PMX	49:1	127	199	1.143E-04	3.479E-05	10 / 5	1.6	3.28
040PMX	50:1	161	251	1.132E-04	1.770E-05	10 / 5	1.6	3.28
040PMX	55:1	156	243	1.132E-04	1.755E-05	10 / 5	1.6	3.28
040PMX	70:1	128	201	1.132E-04	1.729E-05	10 / 5	1.6	3.28
040PMX	100:1	52	77	1.132E-04	1.708E-05	10 / 5	1.6	3.28
040PMX	160:1	181	283	1.132E-04	1.812E-05	14 / 7	2.2	3.89
040PMX	280:1	183	286	1.132E-04	1.725E-05	14 / 7	2.2	3.89
040PMX	400:1	185	286	1.132E-04	1.706E-05	14 / 7	2.2	3.89
040PMX	550:1	165	257	1.132E-04	1.705E-05	14 / 7	2.2	3.89
040PMX	700:1	136	212	1.132E-04	1.705E-05	14 / 7	2.2	3.89
060PMX	3:1	380	594	1.194E-03	4.866E-04	6 / 3	1.8	2.74
060PMX	4:1	360	562	9.502E-04	3.113E-04	6 / 3	1.8	2.74
060PMX	5:1	331	518	9.044E-04	2.064E-04	6 / 3	1.8	2.74
060PMX	5.5:1	317	496	8.969E-04	1.746E-04	6 / 3	1.8	2.74
060PMX	7:1	263	411	8.880E-04	1.100E-04	6 / 3	1.8	2.74
060PMX	10:1	119	179	8.846E-04	5.471E-05	6 / 3	1.8	2.74
060PMX	15:1	396	619	9.044E-04	2.355E-04	10 / 5	2.8	3.56
060PMX	16:1	376	587	9.502E-04	3.287E-04	10 / 5	2.8	3.56
060PMX	20:1	378	591	9.044E-04	2.175E-04	10 / 5	2.8	3.56
060PMX	22:1	380	594	8.969E-04	1.838E-04	10 / 5	2.8	3.56
060PMX	25:1	347	543	9.044E-04	2.110E-04	10 / 5	2.8	3.56
060PMX	28:1	384	600	8.880E-04	1.157E-04	10 / 5	2.8	3.56
060PMX	30:1	408	639	8.846E-04	6.200E-05	10 / 5	2.8	3.56
060PMX	40:1	388	607	8.846E-04	5.749E-05	10 / 5	2.8	3.56
060PMX	49:1	286	447	8.880E-04	1.098E-04	10 / 5	2.8	3.56
060PMX	50:1	361	564	8.846E-04	5.586E-05	10 / 5	2.8	3.56
060PMX	55:1	347	542	8.846E-04	5.543E-05	10 / 5	2.8	3.56
060PMX	70:1	288	450	8.846E-04	5.460E-05	10 / 5	2.8	3.56
060PMX	100:1	110	164	8.846E-04	5.393E-05	10 / 5	2.8	3.56
060PMX	160:1	404	631	8.846E-04	5.723E-05	14 / 7	3.8	4.35
060PMX	280:1	409	640	8.846E-04	5.449E-05	14 / 7	3.8	4.35
060PMX	400:1	406	608	8.846E-04	5.388E-05	14 / 7	3.8	4.35
060PMX	550:1	368	575	8.846E-04	5.386E-05	14 / 7	3.8	4.35
060PMX	700:1	303	473	8.846E-04	5.385E-05	14 / 7	3.8	4.35
075PMX	3:1	1285	2008	4.901E-03	4.672E-03	6 / 3	7.0	4.15
075PMX	4:1	1219	1905	2.522E-03	2.833E-03	6 / 3	7.0	4.15
075PMX	5:1	1148	1795	2.115E-03	1.875E-03	6 / 3	7.0	4.15
075PMX	5.5:1	1113	1740	2.040E-03	1.585E-03	6 / 3	7.0	4.15
075PMX	7:1	935	1461	1.955E-03	9.983E-04	6 / 3	7.0	4.15
075PMX	10:1	552	828	1.923E-03	4.961E-04	6 / 3	7.0	4.15
075PMX	15:1	1381	2158	2.115E-03	2.033E-03	10 / 5	8.0	5.28
075PMX	16:1	1315	2055	2.522E-03	2.824E-03	10 / 5	8.0	5.28
075PMX	20:1	1324	2069	2.115E-03	1.869E-03	10 / 5	8.0	5.28
075PMX	22:1	1333	2083	2.040E-03	1.580E-03	10 / 5	8.0	5.28
075PMX	25:1	1244	1945	2.115E-03	1.810E-03	10 / 5	8.0	5.28
075PMX	28:1	1346	2103	1.955E-03	9.952E-04	10 / 5	8.0	5.28
075PMX	30:1	1430	2235	1.923E-03	5.355E-04	10 / 5	8.0	5.28
075PMX	40:1	1364	2132	1.923E-03	4.946E-04	10 / 5	8.0	5.28
075PMX	49:1	1015	1587	1.955E-03	9.417E-04	10 / 5	8.0	5.28
075PMX	50:1	1267	1980	1.923E-03	4.799E-04	10 / 5	8.0	5.28
075PMX	55:1	1232	1925	1.923E-03	4.759E-04	10 / 5	8.0	5.28
075PMX	70:1	1027	1605	1.923E-03	4.684E-04	10 / 5	8.0	5.28
075PMX	100:1	507	761	1.923E-03	4.623E-04	10 / 5	8.0	5.28
075PMX	160:1	1424	2226	1.923E-03	4.905E-04	14 / 7	9.0	6.50
075PMX	280:1	1445	2258	1.923E-03	4.668E-04	14 / 7	9.0	6.50
075PMX	400:1	1458	2278	1.923E-03	4.615E-04	14 / 7	9.0	6.50
075PMX	550:1	1311	2048	1.923E-03	4.613E-04	14 / 7	9.0	6.50
075PMX	700:1	1090	1703	1.923E-03	4.613E-04	14 / 7	9.0	6.50

ALL SPECIFICATIONS SUBJECT TO CHANGE.

PM SERIES: PRIMETRIC™ PLANETARY GEARHEADS

SINGLE, DOUBLE, TRIPLE STAGE

MODEL	RATIO	TORQUE RATING		INERTIA		BACKLASH	GEARHEAD	L
		T _c IN LBS.	T _{PEAK} IN LBS.	INPUT PINION OZ IN SEC ²	GEARHEAD OZ IN SEC ²	STD/ LOW ARC MINUTES	WEIGHT LBS.	GEARHEAD LENGTH
100PMX	3:1	2301	3597	1.680E-02	1.641E-02	6 / 3	11.5	4.75
100PMX	4:1	2195	3430	1.032E-02	1.049E-02	6 / 3	11.5	4.75
100PMX	5:1	2079	3249	9.201E-03	6.945E-03	6 / 3	11.5	4.75
100PMX	5.5:1	2021	3159	8.997E-03	5.878E-03	6 / 3	11.5	4.75
100PMX	7:1	1711	2673	8.766E-03	3.704E-03	6 / 3	11.5	4.75
100PMX	10:1	1122	1684	8.680E-03	1.841E-03	6 / 3	11.5	4.75
100PMX	15:1	2485	3884	9.201E-03	7.783E-03	10 / 5	18.0	6.38
100PMX	16:1	2379	3717	1.032E-02	1.101E-02	10 / 5	18.0	6.38
100PMX	20:1	2397	3745	9.201E-03	7.286E-03	10 / 5	18.0	6.38
100PMX	22:1	2414	3772	8.997E-03	6.156E-03	10 / 5	18.0	6.38
100PMX	25:1	2263	3536	9.201E-03	7.101E-03	10 / 5	18.0	6.38
100PMX	28:1	2438	3811	8.766E-03	3.875E-03	10 / 5	18.0	6.38
100PMX	30:1	2579	4032	8.680E-03	2.050E-03	10 / 5	18.0	6.38
100PMX	40:1	2473	3865	8.680E-03	1.925E-03	10 / 5	18.0	6.38
100PMX	49:1	1867	2918	8.766E-03	3.706E-03	10 / 5	18.0	6.38
100PMX	50:1	2308	3606	8.680E-03	1.879E-03	10 / 5	18.0	6.38
100PMX	55:1	2250	3516	8.680E-03	1.866E-03	10 / 5	18.0	6.38
100PMX	70:1	1890	2953	8.680E-03	1.843E-03	10 / 5	18.0	6.38
100PMX	100:1	1031	1547	8.680E-03	1.823E-03	10 / 5	18.0	6.38
100PMX	160:1	2587	4044	8.680E-03	1.931E-03	14 / 7	18.5	7.95
100PMX	280:1	2627	4105	8.680E-03	1.844E-03	14 / 7	18.5	7.95
100PMX	400:1	2651	4142	8.680E-03	1.824E-03	14 / 7	18.5	7.95
100PMX	550:1	2400	3750	8.680E-03	1.823E-03	14 / 7	18.5	7.95
100PMX	700:1	2009	3140	8.680E-03	1.823E-03	14 / 7	18.5	7.95
140PMX	3:1	5169	8078	5.794E-02	7.141E-02	6 / 3	28.0	7.06
140PMX	4:1	4946	7730	3.123E-02	4.524E-02	6 / 3	28.0	7.06
140PMX	5:1	4693	7335	2.647E-02	2.991E-02	6 / 3	28.0	7.06
140PMX	5.5:1	4567	7137	2.564E-02	2.527E-02	6 / 3	28.0	7.06
140PMX	7:1	3888	6076	2.470E-02	1.590E-02	6 / 3	28.0	7.06
140PMX	10:1	2767	4150	2.435E-02	7.899E-03	6 / 3	28.0	7.06
140PMX	15:1	5619	8781	2.647E-02	3.315E-02	10 / 5	43.0	9.19
140PMX	16:1	5396	8433	3.123E-02	4.702E-02	10 / 5	43.0	9.19
140PMX	20:1	5439	8500	2.647E-02	3.105E-02	10 / 5	43.0	9.19
140PMX	22:1	5482	8567	2.564E-02	2.621E-02	10 / 5	43.0	9.19
140PMX	25:1	5143	8038	2.647E-02	3.026E-02	10 / 5	43.0	9.19
140PMX	28:1	5542	8661	2.470E-02	1.648E-02	10 / 5	43.0	9.19
140PMX	30:1	5850	9142	2.435E-02	8.708E-03	10 / 5	43.0	9.19
140PMX	40:1	5627	8794	2.435E-02	8.184E-03	10 / 5	43.0	9.19
140PMX	49:1	4273	6677	2.470E-02	1.576E-02	10 / 5	43.0	9.19
140PMX	50:1	5253	8210	2.435E-02	7.986E-03	10 / 5	43.0	9.19
140PMX	55:1	5127	8012	2.435E-02	7.932E-03	10 / 5	43.0	9.19
140PMX	70:1	4328	6763	2.435E-02	7.830E-03	10 / 5	43.0	9.19
140PMX	100:1	2543	3814	2.435E-02	7.746E-03	10 / 5	43.0	9.19
140PMX	160:1	5904	9227	2.435E-02	8.201E-03	14 / 7	58.0	11.30
140PMX	280:1	5998	9374	2.435E-02	7.835E-03	14 / 7	58.0	11.30
140PMX	400:1	6055	9463	2.435E-02	7.749E-03	14 / 7	58.0	11.30
140PMX	550:1	5486	8574	2.435E-02	7.747E-03	14 / 7	58.0	11.30
140PMX	700:1	4616	7213	2.435E-02	7.746E-03	14 / 7	58.0	11.30
180PMX	3:1	13339	20009	1.936E-01	2.930E-01	6 / 3	77.0	9.62
180PMX	4:1	12713	19868	6.554E-02	1.889E-01	6 / 3	77.0	9.62
180PMX	5:1	12748	19923	4.403E-02	1.254E-01	6 / 3	77.0	9.62
180PMX	5.5:1	12765	19950	4.015E-02	1.062E-01	6 / 3	77.0	9.62
180PMX	7:1	10809	16892	3.574E-02	6.702E-02	6 / 3	77.0	9.62
180PMX	10:1	7016	10524	3.410E-02	3.335E-02	6 / 3	77.0	9.62
180PMX	15:1	15924	24048	4.403E-02	1.372E-01	10 / 5	116.0	12.51
180PMX	16:1	15298	23907	6.554E-02	1.928E-01	10 / 5	116.0	12.51
180PMX	20:1	15430	24113	4.403E-02	1.279E-01	10 / 5	116.0	12.51
180PMX	22:1	15561	24318	4.015E-02	1.083E-01	10 / 5	116.0	12.51
180PMX	25:1	15333	23962	4.403E-02	1.246E-01	10 / 5	116.0	12.51
180PMX	28:1	15746	24608	3.574E-02	6.831E-02	10 / 5	116.0	12.51
180PMX	30:1	16632	25155	3.410E-02	3.629E-02	10 / 5	116.0	12.51
180PMX	40:1	16006	25014	3.410E-02	3.398E-02	10 / 5	116.0	12.51
180PMX	49:1	11968	18704	3.574E-02	6.523E-02	10 / 5	116.0	12.51
180PMX	50:1	14447	22577	3.410E-02	3.314E-02	10 / 5	116.0	12.51
180PMX	55:1	14464	22604	3.410E-02	3.291E-02	10 / 5	116.0	12.51
180PMX	70:1	12134	18962	3.410E-02	3.247E-02	10 / 5	116.0	12.51
180PMX	100:1	6447	9671	3.410E-02	3.212E-02	10 / 5	116.0	12.51

ALL SPECIFICATIONS SUBJECT TO CHANGE.

NOTES: Other ratios are also available, consult factory.
T_c: Output torque is rated at 3000 RPM, and a minimum life of 20,000 hours.
Bearing load ratings are based on a minimum life of 20,000 hours.