

Metal Bellows Coupling

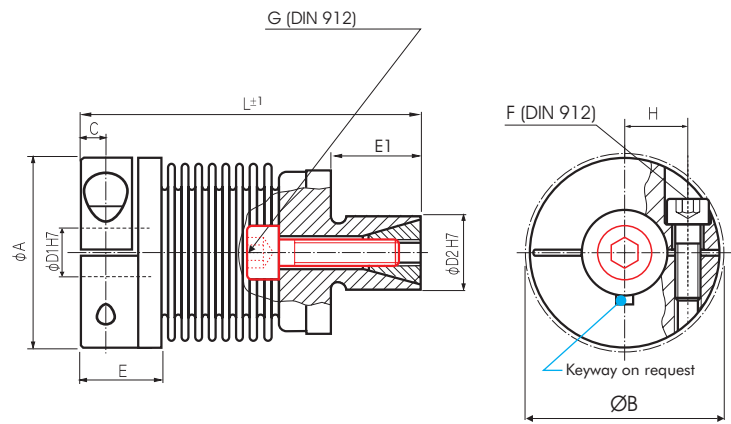

Order Code: KB 3 / 45 - 52 - 10 - S

Type / Size

Length L

Ø D1
(H7)

Options

	Torque T _{KN} (Nm)	Dimensions (mm)										Technical Ratings								
		L Length (±1)	Ø A Outer Ø	Bore Sizes (H7) min ~ max		D2 Bore Size (H7)	Ø B Max. Ø	H	C	E	E1	F/G Screw (DIN 912) T _A (Nm)	Mass (g)	Moment of Inertia J (g cm ²)	Spring Stiffness			Misalignment		
				torsional C _T (Nm/rad)	radial C _R (N/mm)										axial C _A (N/mm)	radial ΔK _r (mm)	axial ΔK _a (mm)	angular ΔK _w (°)		
KB3/5	0.5	28	15.5	3-7	8	17,5	5.2	2.5	8	8	M2/M3	12.8	2.9	260	43	13	0.1	0.2	1	
		32		3*							0.3/1	13.2	3.1	200	18	10	0.15	0.3	1.5	
		35		6*							0.3/1	13.5	3.2	160	9	8	0.2	0.4	2	
KB3/10	1	30	15.5	3-7	8	17,5	5.2	2.5	8	8	M2/M3	14.1	3.3	510	74	27	0.1	0.2	1	
		34		6*							0.3/1	14.6	3.4	380	31	20	0.15	0.3	1.5	
		38		6*							0.3/1	15.3	3.6	310	16	16	0.2	0.4	2	
KB3/15	1.5	37	20	3-10	10	21	7	3	9	12	M2.5/M4	27.2	11	750	59	15	0.1	0.3	1.5	
		41		6*							0.8/3	29.3	12	700	20	9	0.15	0.4	2	
KB3/20	2	40	25	3-12.7	10	27	9	3.5	11	12	M3/M4	40.1	25	1500	67	12	0.15	0.3	1.5	
		46		6/10*							1/3	43.2	29	1300	21	11	0.2	0.4	1.5	
		50		6/10*							1/3	49.1	30	1050	11	9	0.25	0.5	2	
KB3/45	4.5	52	32.5	6-16	14	34	12	5	14	16	M4/M5	86.5	98	6500	168	32	0.1	0.3	1.5	
		60		10*							3/5.9	92.9	110	4200	41	20	0.2	0.5	2	
KB3/100	10	61	40.5	6-22	16	41,5	15.5	5	14	20	M4/M6	135	235	8100	120	27	0.15	0.4	1.5	
		71		10*							3/10	154	292	6800	29	17	0.3	0.6	2	

*Standard Bore Sizes (H7)

Speed: max. 15000 min⁻¹

Hub: Bore Tolerance: H7 Keyway acc. DIN 6885 optional

Material: Bellows - Stainless Steel
Hub - Aluminium (also available in Stainless Steel)

Temperature Range: -30° ~ 120° C