

1000-0250 SRT RH / EK / 4N / 41.87 / SBN7508 / FS

INCH BALL SCREW AND NUT TECHNICAL DATA

BALL SCREW

Thread Form Codes

Part#	Dia. - Lead	Part#	Dia. - Lead
0375-0125	= 0.375-0.125	1500-0200	= 1.500-0.200
0500-0200	= 0.500-0.200	1500-0250	= 1.500-0.250
0500-0500	= 0.500-0.500	1500-0473	= 1.500-0.473
0631-0200	= 0.631-0.200	1500-0500	= 1.500-0.500
0631-0500	= 0.631-0.500	1500-1000	= 1.500-1.000
0750-0200	= 0.750-0.200	1500-1875	= 1.500-0.875
0750-0500	= 0.750-0.500	1750-0250	= 1.750-0.250
0875-0200	= 0.875-0.200	2000-0200	= 2.000-0.200
1000-0200	= 1.000-0.200	2000-0400	= 2.000-0.400
1000-0250	= 1.000-0.250	2250-0500	= 2.250-0.500
1000-0500	= 1.000-0.500	2250-1000	= 2.250-1.000
1000-1000	= 1.000-1.000	2500-0250	= 2.500-0.250
1150-0200	= 1.150-0.200	2500-0500	= 2.500-0.500
1171-0413	= 1.171-0.413	3000-0660	= 3.000-0.660
1250-0200	= 1.250-0.200	3000-1500	= 3.000-1.500
1250-0500	= 1.250-0.500	4000-1000	= 4.000-1.000

PRECISION

SRT = Standard Rolled Thread ±0.004"/ft.
XPR = Precision Rolled Thread ±0.001"/ft.
SGT = Precision ground Thread ±0.0005"/ft.

NOTE:
Not all precisions are available for all sizes.

MATERIAL

RH = Right Hand Thread SS = Stainless Steel
LH = Left Hand Thread

NOTE:
Not all materials/threads are available for all sizes.

FIRST END CONFIGURATION

EZZE-MOUNT™ / End Machining

(see page 214 & 212)

- 1 = Type 1 3 = Type 3
- 2 = Type 2 4 = Type 4

B = Universal Double Bearing Support End Cap Facing Screw Thread

C = Universal Single Bearing Support

D = Flanged Single Bearing Support Flange Facing Screw Thread

E = Universal Double Bearing Support End Cap Facing Away From Screw Thread

F = Flanged Double Bearing Support Flange Facing Screw Thread

G = Flanged Single Bearing Support Flange Facing Away From Screw Thread

H = Flanged Double Bearing Support Flange Facing Away From Screw Thread

U = Universal Double Bearing Support with Motor Mount (see page 217)

Y = Flanged Double Bearing Support with Motor Mount (see page 218)

00 = No End Machining (Screw will be cut to desired length).

XX = Custom Machining (Print or specified data must be provided).

EK

EK = Universal Double Bearing Support, with Keyway

Shaft Extension
(see page 212)

- K** = Shaft Extension with Keyway
- L** = Shaft Extension without Keyway
- Q** = HandWheel Extension
- N** = No Shaft Extension

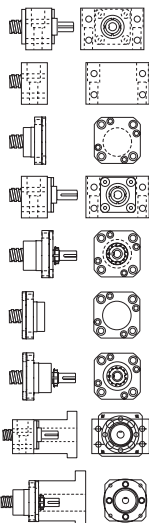

NOTE: Both Ends must be specified.

Single Bearing Supports are used in conjunction with Type 1N end machining.

Double Bearing Supports are used in conjunction with Type 3K, 3L, or 3N end machining.

SECOND END CONFIGURATION

Refer to the First End Configuration section above.

NOTE: Both Ends must be specified.

OVER - ALL - LENGTH (OAL)

Length in inches, 2 place decimal

BALL NUT

Nut will be installed with flange or threaded end toward first end designation. 00000 = No Nut

MODIFIER LIST

F, B, and/or W Optional
F = Round Flange **B** = Boot
W = Wiper

S or M Required
S = Standard, no additional description required
M = Modified, additional description required

Standard Screw Lengths	PART NUMBERS		
	RH	LH	RHSS
2 FT.	SRT9420	SRT8528	SRT6536
4 FT.	SRT7538	SRT8532	SRT6540

Custom cut lengths available up to 12'. For longer lengths contact Customer Service.

0375-0125 SRT

LEAD ACCURACY: ±0.004 in./ft.

Single Start

- 0.375** Ball Circle Diameter
- 0.125** Lead
- 0.300** Root Diameter
- 0.0625** Nominal Ball Diameter
- 0.31** Screw Weight (lbs./ft.)

SBN Single Circuit Ball Nut				60 bearing balls total per nut
PRODUCT SPECIFICATIONS	RH	LH	RHSS	
Dynamic Load (lbs.)	136	136	24	
Static Load (lbs.)	1,415	1,415	255	
Torque to Raise 1 lb. (in.-lb.)	.022	.022	.022	
Nut Weight (lbs.)	.13	.13	.13	
Ball Nut Number	SBN9574	SBN9576	SBN9578	
Flange Part Number	FLG6751	FLG6751	—	
Wiper Kit Part Number	—	—	—	

SBN Double Circuit Ball Nut				60 bearing balls per circuit - 120 total per nut
PRODUCT SPECIFICATIONS	RH	LH	RHSS	
Dynamic Load (lbs.)	272	272	50	
Static Load (lbs.)	2,830	2,830	509	
Torque to Raise 1 lb. (in.-lb.)	.022	.022	.022	
Nut Weight (lbs.)	.21	.21	.21	
Ball Nut Number	SBN7502	SBN8282	SBN7643	
Flange Part Number	FLG6751	FLG6751	—	
Wiper Kit Part Number	—	—	—	

SEL Preload Ball Nut				60 bearing balls per circuit - 120 total per nut
PRODUCT SPECIFICATIONS	RH	LH	RHSS	
Dynamic Load (lbs.)	136	—	—	
Static Load (lbs.)	1,415	—	—	
Torque to Raise 1 lb. (in.-lb.)	.022	—	—	
Preload (lbs.)	10	—	—	
Nut Weight (lbs.)	.21	—	—	
Ball Nut Number	SEL0375	—	—	
Flange Part Number	FLG6751	—	—	
Wiper Kit Part Number	—	—	—	

Flange - FLG6751

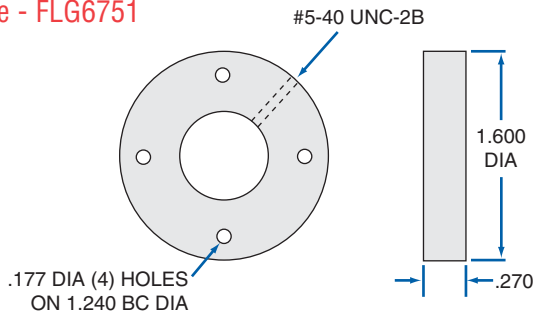

TWIN-LEAD SCREW

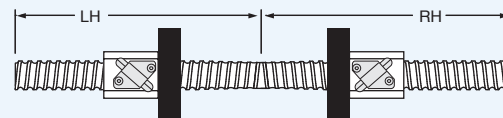

See page 148 for complete product details.

EZZE-MOUNT™ END BEARING SUPPORTS

A convenient solution for mounting ball screw assemblies.



Single or Double Bearing Universal Mount Single or Double Bearing Flange Mount

See page 214 for complete product details.

0500-0200 SRT

LEAD ACCURACY: ±0.004 in./ft.

Single Start

- 0.500** Ball Circle Diameter
- 0.200** Lead
- 0.405** Root Diameter
- 0.125** Nominal Ball Diameter
- 0.50** Screw Weight (lbs./ft.)

Standard Screw Lengths	PART NUMBERS
	RH
2 FT.	SRT5224
4 FT.	SRT5248
6 FT.	SRT5272

Custom cut lengths available up to 12'. For longer lengths contact Customer Service.

INCH BALL SCREW AND NUT TECHNICAL DATA

SBN Double Circuit Ball Nut		40 bearing balls per circuit - 80 total per nut
PRODUCT SPECIFICATIONS	RH	
Dynamic Load (lbs.)	973	
Static Load (lbs.)	7,071	
Torque to Raise 1 lb. (in.-lb.)	.035	
Nut Weight (lbs.)	.51	
Ball Nut Number	SBN10094	
Flange Part Number	FLG7570	
Wiper Kit Part Number	—	

SEL Adjustable Preload Ball Nut		40 bearing balls per circuit - 160 total per nut
PRODUCT SPECIFICATIONS	RH	
Dynamic Load (lbs.)	973	
Static Load (lbs.)	7,071	
Torque to Raise 1 lb. (in.-lb.)	.035	
Preload Range (lbs.)	97-292	
Nut Weight (lbs.)	1.1	
Ball Nut Number	SEL10103	
Flange Part Number	FLG7570	
Wiper Kit Part Number	—	

Flange - FLG7570

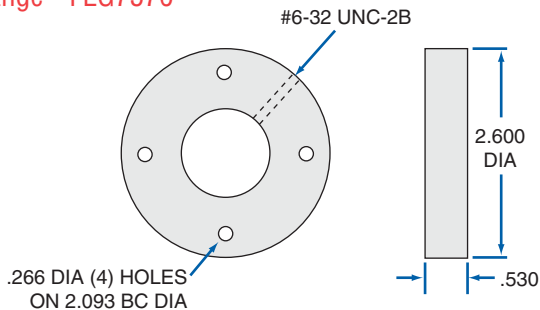

BALL SCREW ASSEMBLIES

These assemblies are shipped with screw, nut, flange, and bearing supports.

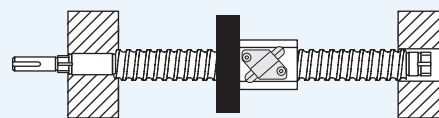

See page 145 for complete product details.

EZZE-MOUNT™ END BEARING SUPPORTS

A convenient solution for mounting ball screw assemblies.

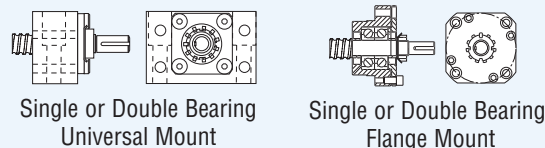

See page 214 for complete product details.

LUBRICANT

Prolong ball screw and nut performance with this special lubricant.

E-900 12oz. Spray or 32oz. Liquid
See page 95 for complete product details.



Standard Screw Lengths	PART NUMBERS	
	RH	RHSS
2 FT.	SRT6736	SRT6700
4 FT.	SRT6740	SRT6704
6 FT.	SRT6744	SRT6846

Custom cut lengths available up to 24' for alloy, up to 12' for stainless.
For longer lengths contact Customer Service.

0500-0500 SRT

LEAD ACCURACY: ±0.004 in./ft.

Double Start

- 0.500** Ball Circle Diameter
- 0.500** Lead
- 0.360** Root Diameter
- 0.125** Nominal Ball Diameter
- 0.50** Screw Weight (lbs./ft.)

SBN Double Circuit Ball Nut			30 bearing balls per circuit - 60 total per nut
PRODUCT SPECIFICATIONS	RH	RH Nickel Plated	
Dynamic Load (lbs.)	786	786/141*	
Static Load (lbs.)	4,131	4,131/744*	
Torque to Raise 1 lb. (in.-lb.)	.088	.088	
Nut Weight (lbs.)	.27	.27	
Ball Nut Number	SBN9582	SBN9582E	
Flange Part Number	FLG7570	FLG7570	
Wiper Kit Part Number	—	—	

*Load rating for stainless steel screw

SBN Double Circuit Ball Nut		30 bearing balls per circuit - 60 total per nut
PRODUCT SPECIFICATIONS	RH	
Dynamic Load (lbs.)	786	
Static Load (lbs.)	4,131	
Torque to Raise 1 lb. (in.-lb.)	.088	
Nut Weight (lbs.)	.26	
Ball Nut Number	SBN7506	
Flange Part Number	—	
Wiper Kit Part Number	—	

Flange - FLG7570

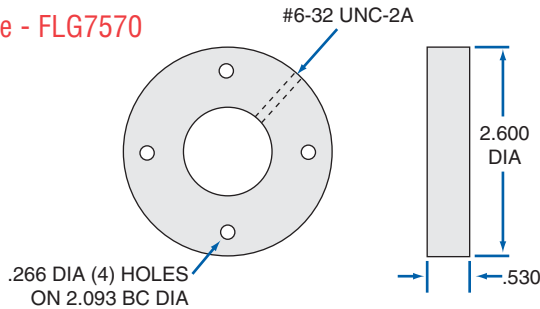

BALL SCREW ASSEMBLIES

These assemblies are shipped with screw, nut, flange, and bearing supports.

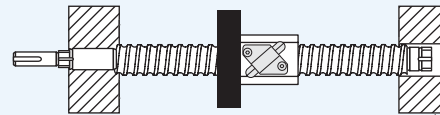

See page 145 for complete product details.

EZZE-MOUNT™ END BEARING SUPPORTS

A convenient solution for mounting ball screw assemblies.

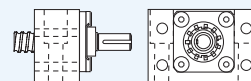

Single or Double Bearing
Universal Mount

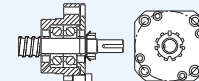

Single or Double Bearing
Flange Mount

See page 214 for complete product details.

LUBRICANT

Prolong ball screw and nut performance with this special lubricant.



E-900 12oz. Spray or 32oz. Liquid
See page 95 for complete product details.



0631-0200 SRT

LEAD ACCURACY: ±0.004 in./ft.

Single Start

- 0.631** Ball Circle Diameter
- 0.200** Lead
- 0.500** Root Diameter
- 0.125** Nominal Ball Diameter
- 0.82** Screw Weight (lbs./ft.)

Standard Screw Lengths	PART NUMBERS		
	RH	LH	RHSS
2 FT.	SRT9392	SRT9562	SRT5359
4 FT.	SRT9987	SRT5092	SRT5648
6 FT.	SRT7540	SRT7541	SRT5378

Custom cut lengths available up to 24' for alloy, up to 12' for stainless.
For longer lengths contact Customer Service.

INCH BALL SCREW AND NUT TECHNICAL DATA

SBN Single Circuit Ball Nut

68 bearing balls total per nut

PRODUCT SPECIFICATIONS	RH	LH	RHSS
Dynamic Load (lbs.)	—	—	140
Static Load (lbs.)	—	—	1,149
Torque to Raise 1 lb. (in.-lb.)	—	—	.035
Nut Weight (lbs.)	—	—	.27
Ball Nut Number	—	—	SBN7645
Flange Part Number	—	—	—
Wiper Kit Part Number	—	—	—

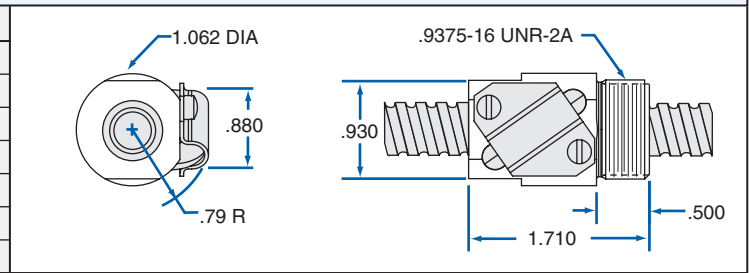

SBN Single Circuit Ball Nut with Wrench Flats

68 bearing balls total per nut

PRODUCT SPECIFICATIONS	RH	LH	RHSS
Dynamic Load (lbs.)	815	815	—
Static Load (lbs.)	6,384	6,384	—
Torque to Raise 1 lb. (in.-lb.)	.035	.035	—
Nut Weight (lbs.)	.27	.27	—
Ball Nut Number	SBN10325	SBN10409	—
Flange Part Number	FLG7570	FLG7570	—
Wiper Kit Part Number	WKB10407	WKB10407	—

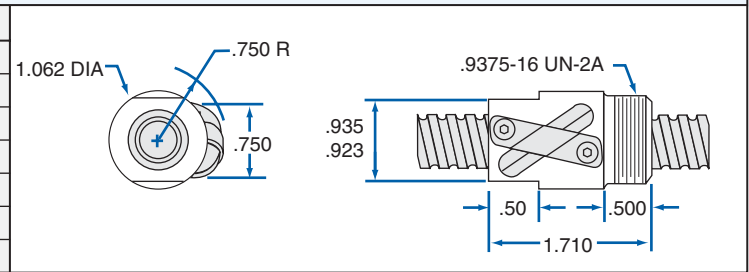

Flange - FLG7570

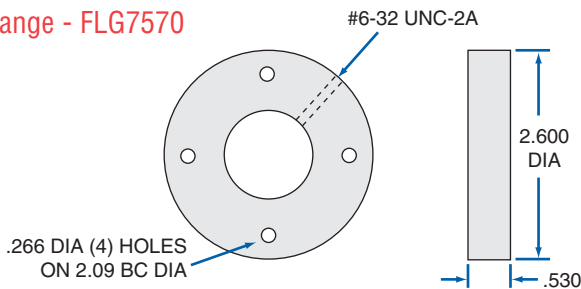

Brush Wiper Kit - WKB10407

2 wipers and 1 retainer

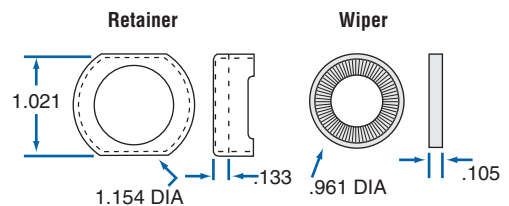

Standard Screw Lengths	PART NUMBERS		
	RH	LH	RHSS
2 FT.	SRT9392	SRT9562	SRT5359
4 FT.	SRT9987	SRT5092	SRT5648
6 FT.	SRT7540	SRT7541	SRT5378
Custom cut lengths available up to 24' for alloy, up to 12' for stainless. For longer lengths contact Customer Service.			

0631-0200 SRT continued

LEAD ACCURACY: ±0.004 in./ft.

Single Start

- 0.631** Ball Circle Diameter
- 0.200** Lead
- 0.500** Root Diameter
- 0.125** Nominal Ball Diameter
- 0.82** Screw Weight (lbs./ft.)

SBN Internal Return Ball Nut				64 bearing balls total per nut
PRODUCT SPECIFICATIONS	RH	LH	RHSS	
Dynamic Load (lbs.)	712	712	—	
Static Load (lbs.)	5,250	5,250	—	
Torque to Raise 1 lb. (in.-lb.)	.035	.035	—	
Nut Weight (lbs.)	.27	.27	—	
Ball Nut Number	SBN10263	SBN10264	—	
Flange Part Number	FLG7570	FLG7570	—	
Wiper Kit Part Number	—	—	—	

SEL Adjustable Preload Ball Nut with Wrench Flats				68 bearing balls per circuit - 136 total per nut
PRODUCT SPECIFICATIONS	RH	LH	RHSS	
Dynamic Load (lbs.)	815	815	—	
Static Load (lbs.)	6,384	6,384	—	
Torque to Raise 1 lb. (in.-lb.)	.035	.035	—	
Preload Range (lbs.)	78-233	78-233	—	
Nut Weight (lbs.)	.65	.65	—	
Ball Nut Number	SEL10408	SEL10410	—	
Flange Part Number	FLG7570	FLG7570	—	
Wiper Kit Part Number	WKB10407	WKB10407	—	

BALL SCREW ASSEMBLIES

These assemblies are shipped with screw, nut, flange, and bearing supports.

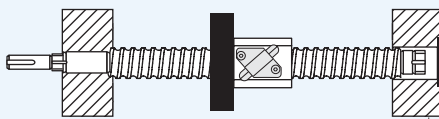

See page 145 for complete product details.

EZZE-MOUNT™ END BEARING SUPPORTS

A convenient solution for mounting ball screw assemblies.

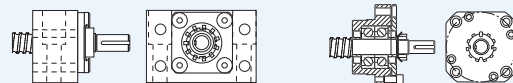

Single or Double Bearing
Universal Mount

Single or Double Bearing
Flange Mount

See page 214 for complete product details.

TWIN-LEAD SCREW

Single piece twin-lead screws offer opposing motion through a single drive system.

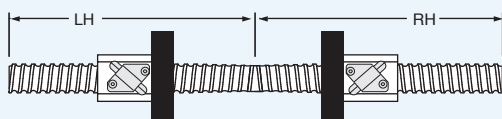

See page 148 for complete product details.

LUBRICANT

Prolong ball screw and nut performance with this special lubricant.



E-900 12oz. Spray or 32oz. Liquid
See page 95 for complete product details.

0631-0200 XPR and SGT

LEAD ACCURACY: XPR ±0.001 in./ft. SGT ±0.0005 in./ft.

Single Start

- 0.631** Ball Circle Diameter
- 0.200** Lead
- 0.500** Root Diameter
- 0.125** Nominal Ball Diameter
- 0.86** Screw Weight (lbs./ft.)

Standard Screw Lengths	PART NUMBERS		
	XPR RH	SGT RH	SGT LH
4 FT.	XPR6320R48	GT06320R48	GT06320L48
6 FT.	XPR6320R72	—	—

XPR custom cut lengths available up to 12',
SGT custom cut lengths available up to 6', contact Customer Service.

INCH BALL SCREW AND NUT TECHNICAL DATA

PRN Preloaded Ball Nut with Wipers

30 bearing balls per circuit - 60 total per nut

PRODUCT SPECIFICATIONS	RH
Dynamic Load (lbs.)	440
Static Load (lbs.)	2,110
Torque to Raise 1 lb. (in.-lb.)	.035
Spring Rate x 10 ⁶ (lb./in.)	1.6
Nut Weight (lbs.)	.98
Ball Nut Number	PRN10108
Flange Part Number	FLG7555
Wiper Type	ELASTOMER

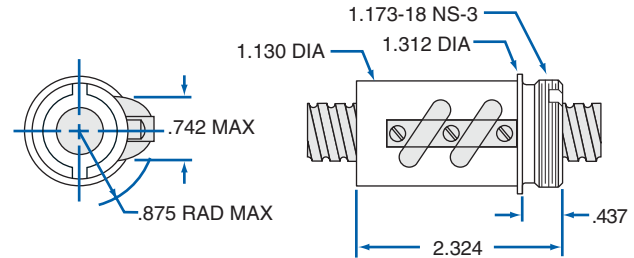

SGN Ball Nut

30 bearing balls per circuit - 60 total per nut

PRODUCT SPECIFICATIONS	RH	LH
Dynamic Load (lbs.)	700	700
Static Load (lbs.)	3,360	3,360
Torque to Raise 1 lb. (in.-lb.)	.035	.035
Nut Weight (lbs.)	.80	.80
Ball Nut Number	SGN10083	SGN10253
Flange Part Number	FLG7570	FLG7570
Wiper Kit Part Number	—	—

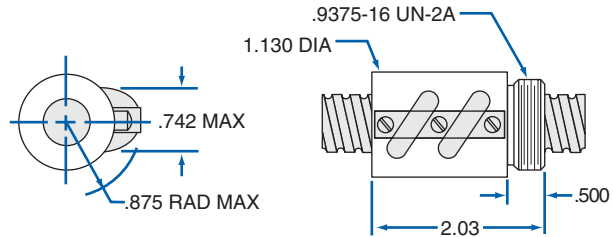

PRN Preloaded Ball Nut

30 bearing balls per circuit - 60 total per nut

PRODUCT SPECIFICATIONS	RH
Dynamic Load (lbs.)	350
Static Load (lbs.)	1,680
Torque to Raise 1 lb. (in.-lb.)	.035
Spring Rate x 10 ⁶ (lb./in.)	1.0
Nut Weight (lbs.)	.80
Ball Nut Number	PRN10106
Flange Part Number	FLG7570
Wiper Kit Part Number	—

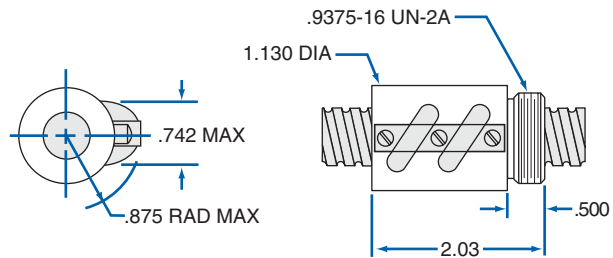

SSN Preloaded Flanged Ball Nut with Wipers

30 bearing balls per circuit - 60 total per nut

PRODUCT SPECIFICATIONS	RH
Dynamic Load (lbs.)	440
Static Load (lbs.)	2,110
Torque to Raise 1 lb. (in.-lb.)	.035
Spring Rate x 10 ⁶ (lb./in.)	1.6
Nut Weight (lbs.)	1.2
Ball Nut Number	SSN0389
Flange	INTEGRAL
Wiper Type	ELASTOMER

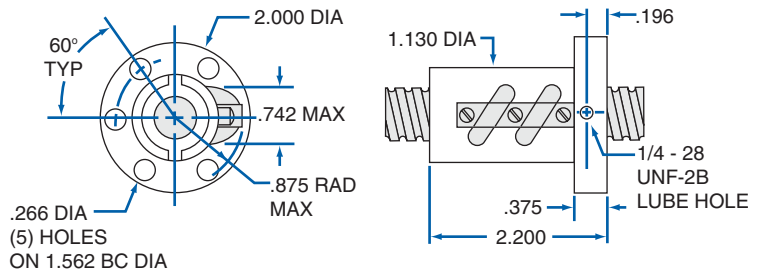

Standard Screw Lengths	PART NUMBERS	
	XPR RH	SGT RH
4 FT.	XPR6320R48	GT06320R48
6 FT.	XPR6320R72	—

XPR custom cut lengths available up to 12',
SGT custom cut lengths available up to 4', contact Customer Service.

0631-0200 XPR and SGT

LEAD ACCURACY: XPR ±0.001 in./ft. SGT ±0.0005 in./ft.

Single Start

- 0.631** Ball Circle Diameter
- 0.200** Lead
- 0.500** Root Diameter
- 0.125** Nominal Ball Diameter
- 0.86** Screw Weight (lbs./ft.)

SSN Preloaded Internal Return Ball Nut with Wipers 64 bearing balls total per nut

PRODUCT SPECIFICATIONS	RH
Dynamic Load (lbs.)	450
Static Load (lbs.)	2,115
Torque to Raise 1 lb. (in.-lb.)	.035
Spring Rate x 10 ⁶ (lb./in.)	1.5
Nut Weight (lbs.)	.27
Ball Nut Number	SSN10274
Flange Part Number	FLG7570
Wiper Type	ELASTOMER

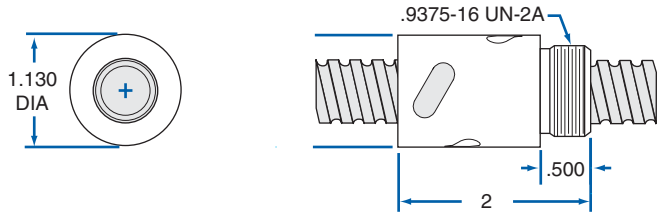

SSN Preloaded Flanged Internal Return Ball Nut with Wipers 64 bearing balls total per nut

PRODUCT SPECIFICATIONS	RH
Dynamic Load (lbs.)	450
Static Load (lbs.)	2,115
Torque to Raise 1 lb. (in.-lb.)	.035
Spring Rate x 10 ⁶ (lb./in.)	1.5
Nut Weight (lbs.)	.45
Ball Nut Number	SSN10304
Flange	INTEGRAL
Wiper Type	ELASTOMER

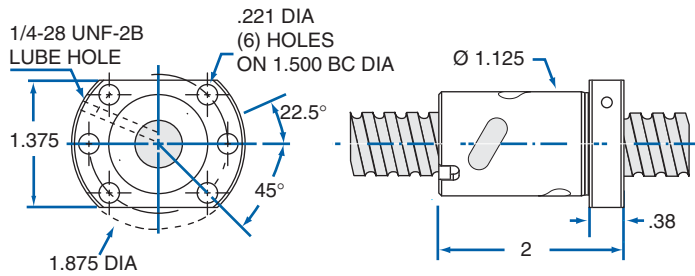

BALL SCREW ASSEMBLIES

These assemblies are shipped with screw, nut, flange, and bearing supports.

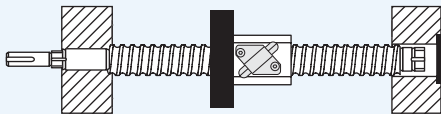

See page 145 for complete product details.

EZZE-MOUNT™ END BEARING SUPPORTS

A convenient solution for mounting ball screw assemblies.

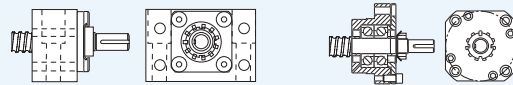

Single or Double Bearing
Universal Mount

Single or Double Bearing
Flange Mount

See page 214 for complete product details.

TWIN-LEAD SCREW

Single piece twin-lead screws offer opposing motion through a single drive system.

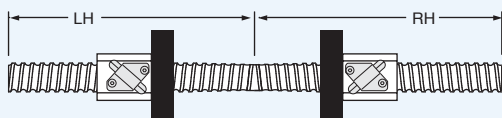

See page 148 for complete product details.

LUBRICANT

Prolong ball screw and nut performance with this special lubricant.



E-900 12oz. Spray or 32oz. Liquid
See page 95 for complete product details.



0631-0500 SRT

LEAD ACCURACY: ±0.004 in./ft.

Double Start

- 0.631** Ball Circle Diameter
- 0.500** Lead
- 0.500** Root Diameter
- 0.125** Nominal Ball Diameter
- 0.82** Screw Weight (lbs./ft.)

Standard Screw Lengths	PART NUMBERS
	RH
2 FT.	SRT6524
4 FT.	SRT6548
6 FT.	SRT6572

Custom cut lengths available up to 12'. For longer lengths contact Customer Service.

INCH BALL SCREW AND NUT TECHNICAL DATA

SBN Double Circuit Ball Nut

37 bearing balls per circuit - 74 total per nut

PRODUCT SPECIFICATIONS	RH
Dynamic Load (lbs.)	960
Static Load (lbs.)	5,565
Torque to Raise 1 lb. (in.-lb.)	.088
Nut Weight (lbs.)	.27
Ball Nut Number	SBN10113
Flange Part Number	FLG7570

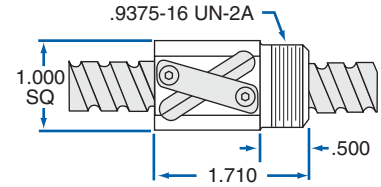
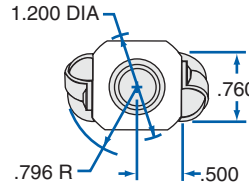

SEL Adjustable Preload Ball Nut

37 bearing balls per circuit - 148 total per nut

PRODUCT SPECIFICATIONS	RH
Dynamic Load (lbs.)	960
Static Load (lbs.)	5,565
Torque to Raise 1 lb. (in.-lb.)	.088
Preload Range (lbs.)	96-288
Nut Weight (lbs.)	.65
Ball Nut Number	SEL10182
Flange Part Number	FLG7570

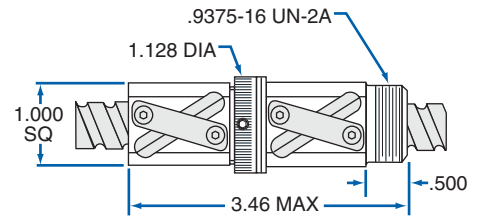
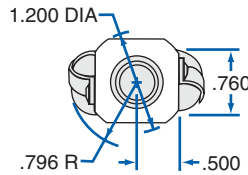

Flange - FLG7570

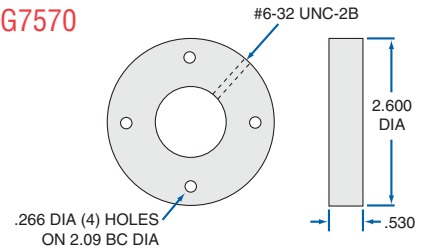

0631-1000 SRT

LEAD ACCURACY: ±0.004 in./ft.

Double Start

- 0.631** Ball Circle Diameter
- 1.000** Lead
- 0.500** Root Diameter
- 0.125** Nominal Ball Diameter
- 0.82** Screw Weight (lbs./ft.)

Standard Screw Lengths	PART NUMBERS
	RH
2 FT.	SRT6124
4 FT.	SRT6148
6 FT.	SRT6172

Custom cut lengths available up to 12'. For longer lengths contact Customer Service.

SBN Double Circuit Ball Nut

21 bearing balls per circuit - 42 total per nut

PRODUCT SPECIFICATIONS	RH
Dynamic Load (lbs.)	620
Static Load (lbs.)	2580
Torque to Raise 1 lb. (in.-lb.)	0.177
Nut Weight (lbs.)	0.28
Ball Nut Number	SBN10392*
Flange Part Number	FLG 7570

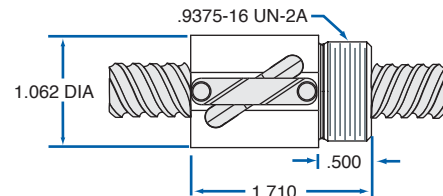
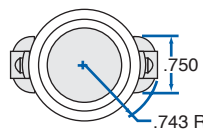

* High capacity 4 circuit available—consult engineers

Standard Screw Lengths	PART NUMBERS
	RH
4 FT.	SRT7248
8 FT.	SRT7296
12 FT.	SRT7244

Custom cut lengths available up to 24'. For longer lengths contact Customer Service.

0750-0200 SRT

LEAD ACCURACY: ±0.004 in./ft.

Single Start

- 0.750** Ball Circle Diameter
- 0.200** Lead
- 0.602** Root Diameter
- 0.141** Nominal Ball Diameter
- 1.22** Screw Weight (lbs./ft.)

SBN Single Circuit Ball Nut		70 bearing balls total per nut
PRODUCT SPECIFICATIONS	RH	
Dynamic Load (lbs.)	1,100	
Static Load (lbs.)	8,569	
Torque to Raise 1 lb. (in.-lb.)	.035	
Nut Weight (lbs.)	.5	
Ball Nut Number	SBN7201	
Flange Part Number	FLG7555	
Wiper Kit Part Number	WKB7200	

SBN Double Circuit Ball Nut		70 bearing balls per circuit - 140 total per nut
PRODUCT SPECIFICATIONS	RH	
Dynamic Load (lbs.)	2,200	
Static Load (lbs.)	17,138	
Torque to Raise 1 lb. (in.-lb.)	.035	
Nut Weight (lbs.)	.8	
Ball Nut Number	SBN7202	
Flange Part Number	FLG7555	
Wiper Kit Part Number	WKB7200	

SEL Adjustable Preload Ball Nut		70 bearing balls per circuit - 280 total per nut
PRODUCT SPECIFICATIONS	RH	
Dynamic Load (lbs.)	2,200	
Static Load (lbs.)	17,138	
Torque to Raise 1 lb. (in.-lb.)	.035	
Preload Range (lbs.)	220-660	
Nut Weight (lbs.)	2.1	
Ball Nut Number	SEL10057	
Flange Part Number	FLG7555	
Wiper Kit Part Number	WKB7200	

Flange - FLG7555

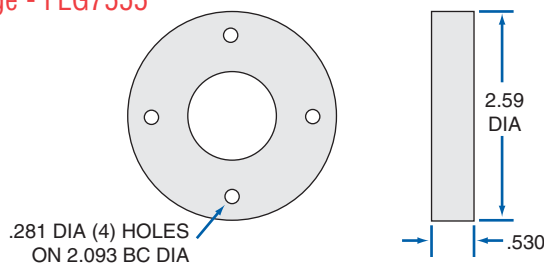

Brush Wiper Kit - WKB7200

2 wipers and 1 retainer

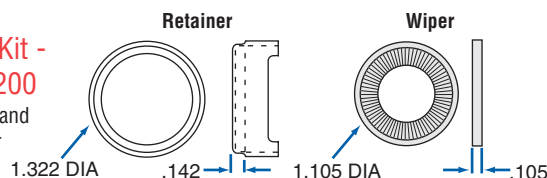

BALL SCREW ASSEMBLIES

These assemblies are shipped with screw, nut, flange, and bearing supports.

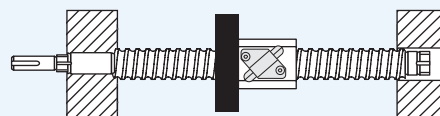

See page 145 for complete product details.

0750-0200 XPR and SGT

LEAD ACCURACY: XPR ±0.001 in./ft. SGT ±0.0005 in./ft.

Single Start

- 0.750 Ball Circle Diameter
- 0.200 Lead
- 0.602 Root Diameter
- 0.141 Nominal Ball Diameter
- 1.2 Screw Weight (lbs./ft.)

Standard Screw Lengths	PART NUMBERS	
	XPR RH	SGT RH
4 FT.	XPR7520R48	GT07520R48
8 FT.	XPR7520R96	—

XPR custom cut lengths available up to 12',
SGT custom cut lengths available up to 5', contact Customer Service.

INCH BALL SCREW AND NUT TECHNICAL DATA

PRN Preloaded Ball Nut with Wipers

71 bearing balls per circuit - 142 total per nut

PRODUCT SPECIFICATIONS	RH
Dynamic Load (lbs.)	1,473
Static Load (lbs.)	9,916
Torque to Raise 1 lb. (in.-lb.)	.035
Spring Rate x 10 ⁶ (lb./in.)	2.75
Nut Weight (lbs.)	1.0
Ball Nut Number	PRN10109
Flange Part Number	FLG8281
Wiper Type	ELASTOMER

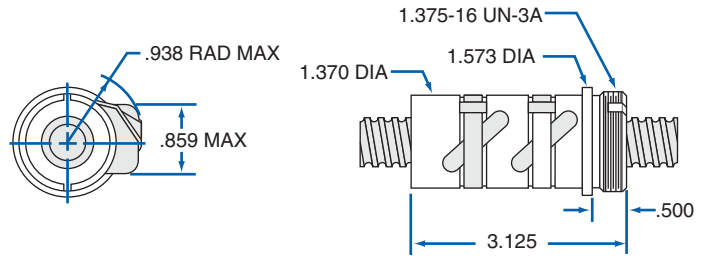

SSN Preloaded Flanged Ball Nut with Wipers

71 bearing balls per circuit - 142 total per nut

PRODUCT SPECIFICATIONS	RH
Dynamic Load (lbs.)	1,473
Static Load (lbs.)	9,916
Torque to Raise 1 lb. (in.-lb.)	.035
Spring Rate x 10 ⁶ (lb./in.)	2.75
Nut Weight (lbs.)	1.2
Ball Nut Number	SSN0390
Flange	INTEGRAL
Wiper Type	ELASTOMER

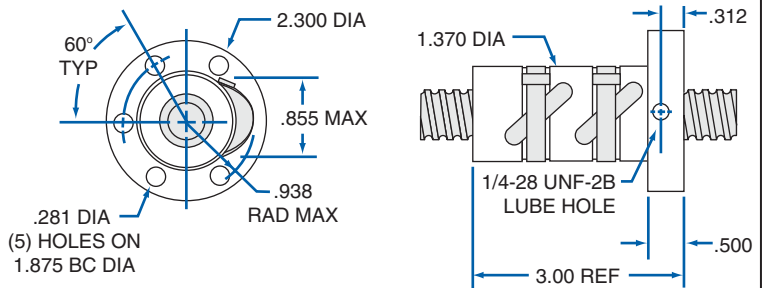

BALL SCREW ASSEMBLIES

These assemblies are shipped with screw, nut, flange, and bearing supports.

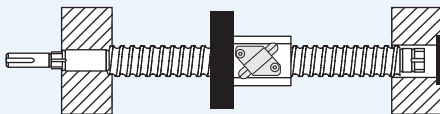

See page 145 for complete product details.

EZZE-MOUNT™

END BEARING SUPPORTS

A convenient solution for mounting ball screw assemblies.

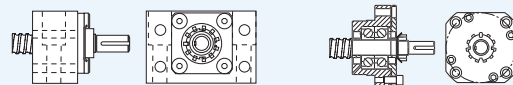

Single or Double Bearing
Universal Mount

Single or Double Bearing
Flange Mount

See page 214 for complete product details.

END MACHINING

Machining for Nook standard ends or custom requirement available.

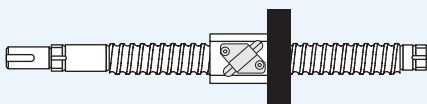

See page 212 for complete product details.

LUBRICANT

Prolong ball screw and nut performance with this special lubricant.



E-900 12oz. Spray or 32oz. Liquid
See page 95 for complete product details.

Standard Screw Lengths	PART NUMBERS
	RH
4 FT.	SRT7552
8 FT.	SRT7596
12 FT.	SRT7292

Custom cut lengths available up to 24'. For longer lengths contact Customer Service.

0750-0500 SRT

LEAD ACCURACY: ±0.004 in./ft.

Double Start

- 0.750** Ball Circle Diameter
- 0.500** Lead
- 0.602** Root Diameter
- 0.141** Nominal Ball Diameter
- 1.22** Screw Weight (lbs./ft.)

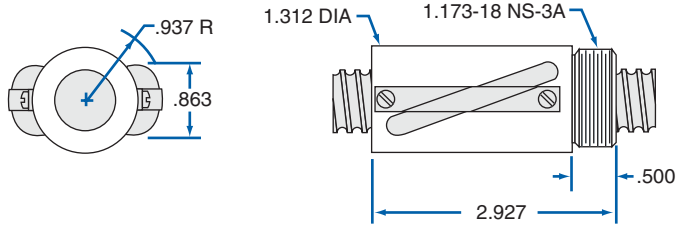
SBN Double Circuit Ball Nut		78 bearing balls per circuit - 156 total per nut
PRODUCT SPECIFICATIONS	RH	
Dynamic Load (lbs.)	2,723	
Static Load (lbs.)	17,425	
Torque to Raise 1 lb. (in.-lb.)	.088	
Nut Weight (lbs.)	.8	
Ball Nut Number	SBN7500	
Flange Part Number	FLG7555	
Wiper Kit Part Number	WKB7200	

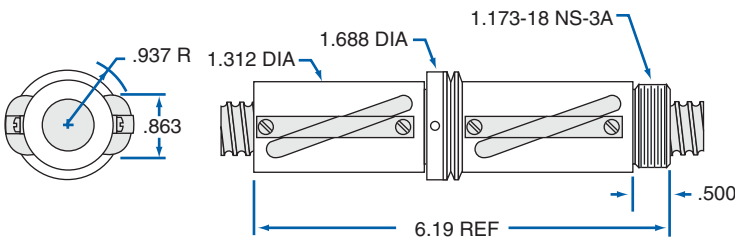
SEL Adjustable Preload Ball Nut		78 bearing balls per circuit - 312 total per nut
PRODUCT SPECIFICATIONS	RH	
Dynamic Load (lbs.)	2,723	
Static Load (lbs.)	17,425	
Torque to Raise 1 lb. (in.-lb.)	.088	
Preload Range (lbs.)	272-817	
Nut Weight (lbs.)	.8	
Ball Nut Number	SEL10058	
Flange Part Number	FLG7555	
Wiper Kit Part Number	WKB7200	

Flange - FLG7555

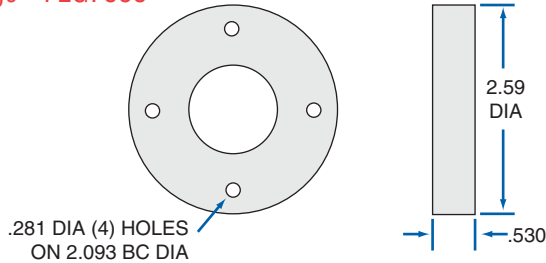

Brush Wiper Kit - WKB7200

2 wipers and
1 retainer

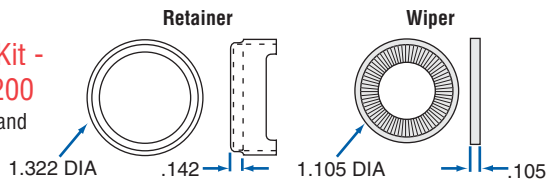

BALL SCREW ASSEMBLIES

These assemblies are shipped with screw, nut, flange, and bearing supports.

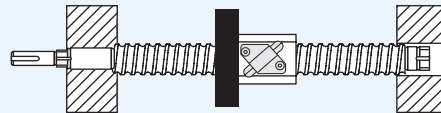

See page 145 for complete product details.

EZZE-MOUNT™ END BEARING SUPPORTS

A convenient solution for mounting ball screw assemblies.

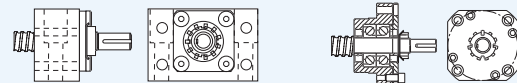

Single or Double Bearing
Universal Mount

Single or Double Bearing
Flange Mount

See page 214 for complete product details.

0875-0200 SRT

LEAD ACCURACY: ±0.004 in./ft.

Single Start

0.875 Ball Circle Diameter

0.200 Lead

0.735 Root Diameter

0.125 Nominal Ball Diameter

1.78 Screw Weight (lbs./ft.)

Standard Screw Lengths	PART NUMBERS
	RH
4 FT.	SRT8541
8 FT.	SRT8553
12 FT.	SRT8859

Custom cut lengths available up to 24'. For longer lengths contact Customer Service.

INCH BALL SCREW AND NUT TECHNICAL DATA

SBN Double Circuit Ball Nut

91 bearing balls per circuit - 182 total per nut

PRODUCT SPECIFICATIONS	RH
Dynamic Load (lbs.)	1,942
Static Load (lbs.)	18,063
Torque to Raise 1 lb. (in.-lb.)	.035
Nut Weight (lbs.)	.7
Ball Nut Number	SBN8277
Flange Part Number	FLG8281
Wiper Kit Part Number	WKB2648

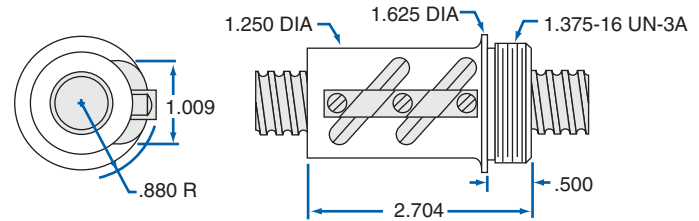

SAR Adjustable Preload Ball Nut with Wipers

91 bearing balls per circuit - 182 total per nut

PRODUCT SPECIFICATIONS	RH
Dynamic Load (lbs.)	971
Static Load (lbs.)	9,482
Torque to Raise 1 lb. (in.-lb.)	.035
Preload (lbs.)	97-291
Nut Weight (lbs.)	1.8
Ball Nut Number	SAR3040
Flange	INTEGRAL
Wiper Type	FELT

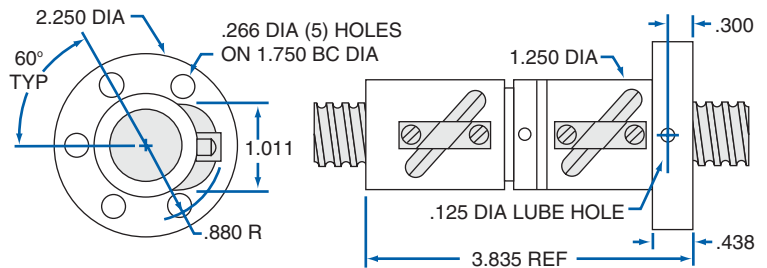

Flange - FLG8281

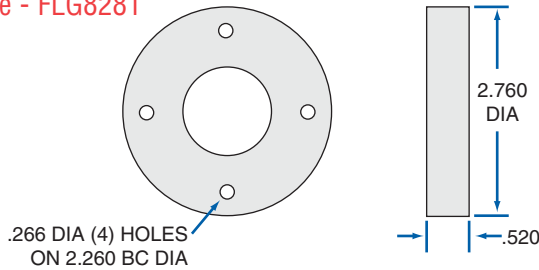

BALL SCREW ASSEMBLIES

These assemblies are shipped with screw, nut, flange, and bearing supports.

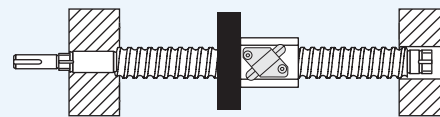

See page 145 for complete product details.

Brush Wiper Kit - WKB2648

2 wipers and
1 retainer

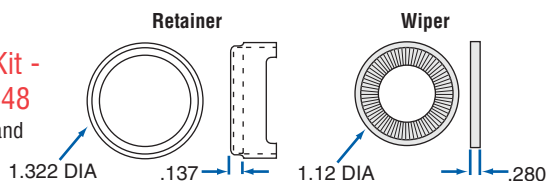

EZZE-MOUNT™ END BEARING SUPPORTS

A convenient solution for mounting ball screw assemblies.

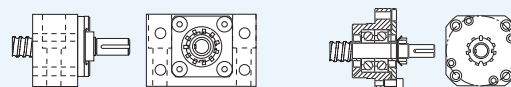

Single or Double Bearing
Universal Mount

Single or Double Bearing
Flange Mount

See page 214 for complete product details.

Standard Screw Lengths	PART NUMBERS	
	XPR RH	SGT RH
4 FT.	XPR8720R48	GT08720R48
8 FT.	XPR8720R96	—

XPR custom cut lengths available up to 12',
SGT custom cut lengths available up to 5', contact Customer Service.

0875-0200 XPR and SGT

LEAD ACCURACY: XPR ± 0.001 in./ft. SGT ± 0.0005 in./ft.

Single Start

- 0.875** Ball Circle Diameter
- 0.200** Lead
- 0.735** Root Diameter
- 0.125** Nominal Ball Diameter
- 1.8** Screw Weight (lbs./ft.)

PRN Preloaded Ball Nut with Wipers		93 bearing balls per circuit - 186 total per nut
PRODUCT SPECIFICATIONS	RH	
Dynamic Load (lbs.)	1,375	
Static Load (lbs.)	10,780	
Torque to Raise 1 lb. (in.-lb.)	.035	
Spring Rate x 10 ⁶ (lb./in.)	3.10	
Nut Weight (lbs.)	1.1	
Ball Nut Number	PRN10110	
Flange Part Number	FLG8281	
Wiper Type	ELASTOMER	

SSN Preloaded Flanged Ball Nut with Wipers		93 bearing balls per circuit - 186 total per nut
PRODUCT SPECIFICATIONS	RH	
Dynamic Load (lbs.)	1,375	
Static Load (lbs.)	10,780	
Torque to Raise 1 lb. (in.-lb.)	.035	
Spring Rate x 10 ⁶ (lb./in.)	3.10	
Nut Weight (lbs.)	1.4	
Ball Nut Number	SSN0388	
Flange	INTEGRAL	
Wiper Type	ELASTOMER	

SAG Adjustable Preload Flanged Ball Nut with Wipers		93 bearing balls per circuit - 186 total per nut
PRODUCT SPECIFICATIONS	RH	
Dynamic Load (lbs.)	1,375	
Static Load (lbs.)	10,780	
Torque to Raise 1 lb. (in.-lb.)	.035	
Preload (lbs.)	220	
Nut Weight (lbs.)	1.8	
Ball Nut Number	SAG0702	
Flange	INTEGRAL	
Wiper Type	FELT	

BALL SCREW ASSEMBLIES

These assemblies are shipped with screw, nut, flange, and bearing supports.

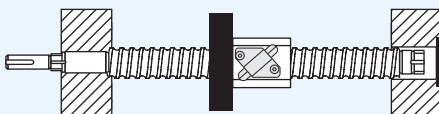

See page 145 for complete product details.

EZZE-MOUNT™ END BEARING SUPPORTS

A convenient solution for mounting ball screw assemblies.

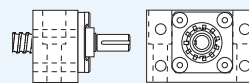

Single or Double Bearing
Universal Mount

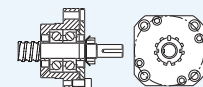

Single or Double Bearing
Flange Mount

See page 214 for complete product details.

INCH BALL SCREW AND NUT TECHNICAL DATA

1000-0200 SGT

LEAD ACCURACY: ±0.0005 in./ft.

Single Start

- 1.000** Ball Circle Diameter
- 0.200** Lead
- 0.865** Root Diameter
- 0.125** Nominal Ball Diameter
- 2.2** Screw Weight (lbs./ft.)

Standard Screw Lengths	PART NUMBERS
6 FT.	GT10020R72
Custom cut lengths available up to 6', contact Customer Service.	

INCH BALL SCREW AND NUT TECHNICAL DATA

SSN Preloaded Flanged Ball Nut with Wipers

107 bearing balls per circuit - 214 total per nut

PRODUCT SPECIFICATIONS	RH
Dynamic Load (lbs.)	1,565
Static Load (lbs.)	13,073
Torque to Raise 1 lb. (in.-lb.)	.035
Spring Rate x 10 ⁶ (lb./in.)	3.50
Nut Weight (lbs.)	1.5
Ball Nut Number	SSN0391
Flange	INTEGRAL
Wiper Type	ELASTOMER

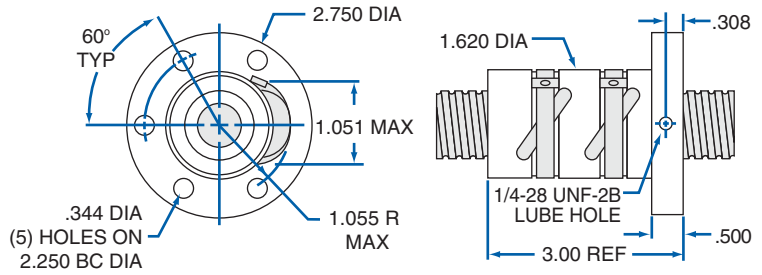

BALL SCREW ASSEMBLIES

These assemblies are shipped with screw, nut, flange, and bearing supports.

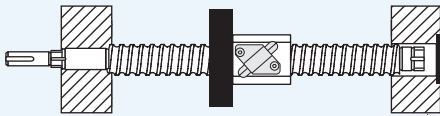

See page 145 for complete product details.

EZZE-MOUNT™ END BEARING SUPPORTS

A convenient solution for mounting ball screw assemblies.

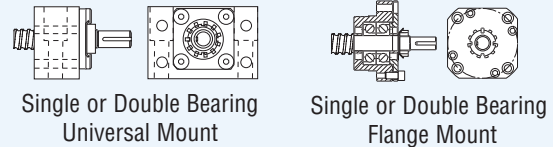

See page 214 for complete product details.

END MACHINING

Machining for Nook standard ends or custom requirement available.

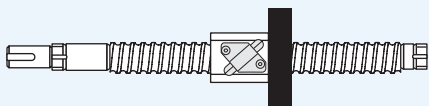

See page 212 for complete product details.

LUBRICANT

Prolong ball screw and nut performance with this special lubricant.



E-900 12oz. Spray or 32oz. Liquid
See page 95 for complete product details.



Standard Screw Lengths	PART NUMBERS		
	RH	LH	RHSS
4 FT.	SRT5005	SRT5499	SRT6668
8 FT.	SRT5013	SRT5507	SRT6676
12 FT.	SRT5021	SRT5515	SRT6684
16 FT.	SRT0426	SRT0428	—

Custom cut lengths available up to 24' for alloy, up to 12' for stainless.
For longer lengths contact Customer Service.

1000-0250 SRT

LEAD ACCURACY: ±0.004 in./ft.

Single Start

- 1.000** Ball Circle Diameter
- 0.250** Lead
- 0.820** Root Diameter
- 0.156** Nominal Ball Diameter
- 2.2** Screw Weight (lbs./ft.)

SBN Single Circuit Ball Nut				86 bearing balls total per nut
PRODUCT SPECIFICATIONS	RH	LH	RHSS	
Dynamic Load (lbs.)	1,612	1,612	290	
Static Load (lbs.)	13,913	13,913	2,504	
Torque to Raise 1 lb. (in.-lb.)	.044	.044	.044	
Nut Weight (lbs.)	.8	.8	.8	
Ball Nut Number	SBN10466	SBN10468	SBN10470	
Flange Part Number	FLG7571	FLG7571	—	
Wiper Kit Part Number	WKB1050	WKB1050	WKB1050	

SBN Double Circuit Ball Nut				86 bearing balls per circuit - 172 total per nut
PRODUCT SPECIFICATIONS	RH	LH	RHSS	
Dynamic Load (lbs.)	3,224	—	—	
Static Load (lbs.)	27,826	—	—	
Torque to Raise 1 lb. (in.-lb.)	.044	—	—	
Nut Weight (lbs.)	1.2	—	—	
Ball Nut Number	SBN10472	—	—	
Flange Part Number	FLG7571	—	—	
Wiper Kit Part Number	WKB1050	—	—	

SBN Double Circuit Flanged Ball Nut				86 bearing balls per circuit - 172 total per nut
PRODUCT SPECIFICATIONS	RH	LH	RHSS	
Dynamic Load (lbs.)	3,224	3,224	—	
Static Load (lbs.)	27,826	27,826	—	
Torque to Raise 1 lb. (in.-lb.)	.044	.044	—	
Nut Weight (lbs.)	1.5	1.5	—	
Ball Nut Number	SBN8278	SBN8284	—	
Flange	INTEGRAL	INTEGRAL	—	
Wiper Kit Part Number	WKB2651	WKB2651	—	

Flange - FLG7571

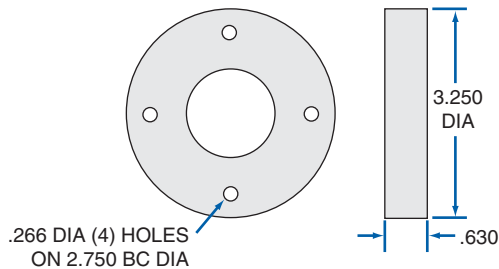

Brush Wiper Kit - WKB1050

2 wipers and 1 retainer

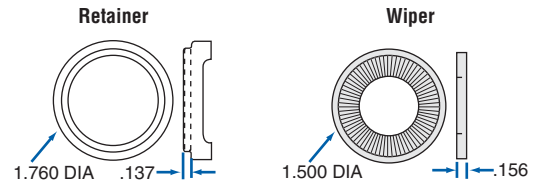

Brush Wiper Kit - WKB2651

2 wipers and 1 retainer

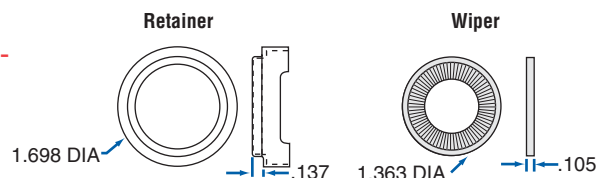

1000-0250 SRT continued

LEAD ACCURACY: ±0.004 in./ft.

Single Start

- 1.000** Ball Circle Diameter
- 0.250** Lead
- 0.820** Root Diameter
- 0.156** Nominal Ball Diameter
- 2.2** Screw Weight (lbs./ft.)

Standard Screw Lengths	PART NUMBERS		
	RH	LH	RHSS
4 FT.	SRT5005	SRT5499	SRT6668
8 FT.	SRT5013	SRT5507	SRT6676
12 FT.	SRT5021	SRT5515	SRT6684
16 FT.	SRT0426	SRT0428	—

Custom cut lengths available up to 24' for alloy, up to 12' for stainless.
For longer lengths contact Customer Service.

INCH BALL SCREW AND NUT TECHNICAL DATA

SEL Preload Ball Nut

86 bearing balls per circuit - 172 total per nut

PRODUCT SPECIFICATIONS	RH	LH	RHSS
Dynamic Load (lbs.)	1,612	1,612	—
Static Load (lbs.)	13,913	13,913	—
Torque to Raise 1 lb. (in.-lb.)	.044	.044	—
Preload (lbs.)	330	330	—
Nut Weight (lbs.)	1.9	1.9	—
Ball Nut Number	SEL10474	SEL10477	—
Flange Part Number	FLG7571	FLG7571	—
Wiper Kit Part Number	WKB1050	WKB1050	—

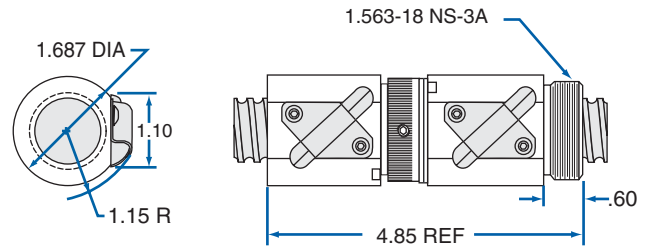

SAR Adjustable Preload Flanged Ball Nut

86 bearing balls per circuit - 172 total per nut

PRODUCT SPECIFICATIONS	RH	LH	RHSS
Dynamic Load (lbs.)	1,612	—	—
Static Load (lbs.)	13,913	—	—
Torque to Raise 1 lb. (in.-lb.)	.044	—	—
Preload Range (lbs.)	330	—	—
Nut Weight (lbs.)	2.0	—	—
Ball Nut Number	SAR3041	—	—
Flange	INTEGRAL	—	—
Wiper Type	—	—	—

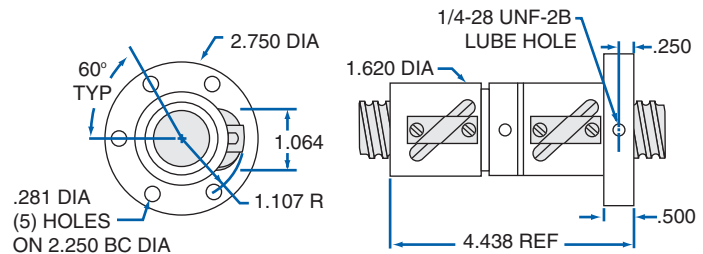

BALL SCREW ASSEMBLIES

These assemblies are shipped with screw, nut, flange, and bearing supports.

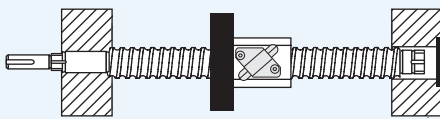

See page 145 for complete product details.

EZZE-MOUNT™ END BEARING SUPPORTS

A convenient solution for mounting ball screw assemblies.

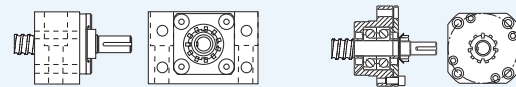

Single or Double Bearing Universal Mount

Single or Double Bearing Flange Mount

See page 214 for complete product details.

TWIN-LEAD SCREW

Single piece twin-lead screws offer opposing motion through a single drive system.

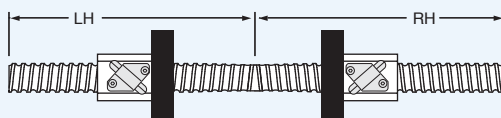

See page 148 for complete product details.

LUBRICANT

Prolong ball screw and nut performance with this special lubricant.



E-900 12oz. Spray or 32oz. Liquid
See page 95 for complete product details.

Standard Screw Lengths	PART NUMBERS	
	XPR RH	SGT RH
6 FT.	XPR10025R72	GT10025R72
12 FT.	XPR10025R144	—

XPR custom cut lengths available up to 12',
SGT custom cut lengths available up to 6', contact Customer Service.

1000-0250 XPR and SGT

LEAD ACCURACY: XPR ±0.001 in./ft. SGT ±0.0005 in./ft.

Single Start

- 1.000** Ball Circle Diameter
- 0.250** Lead
- 0.820** Root Diameter
- 0.156** Nominal Ball Diameter
- 2.2** Screw Weight (lbs./ft.)

PRN Preloaded Ball Nut with Wipers 86 bearing balls per circuit - 172 total per nut

PRODUCT SPECIFICATIONS	RH
Dynamic Load (lbs.)	2,285
Static Load (lbs.)	15,815
Torque to Raise 1 lb. (in.-lb.)	.044
Spring Rate x 10 ⁶ (lb./in.)	1.7
Nut Weight (lbs.)	3.50
Ball Nut Number	PRN10111
Flange Part Number	FLG7576*
Wiper Type	ELASTOMER

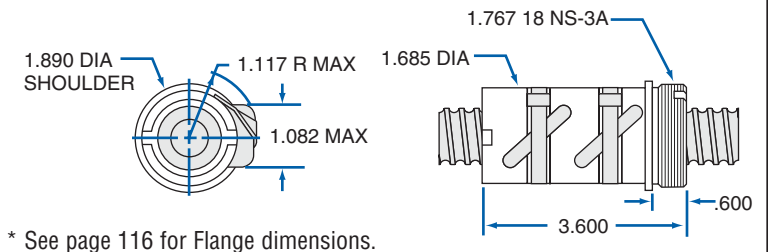

SGN Ball Nut or PRN Preloaded Ball Nut 86 bearing balls per circuit - 172 total per nut

PRODUCT SPECIFICATIONS	SGN-RH	PRN-RH
Dynamic Load (lbs.)	4,570	2,285
Static Load (lbs.)	31,630	15,815
Torque to Raise 1 lb. (in.-lb.)	.044	.044
Spring Rate x 10 ⁶ (lb./in.)	No Preload	2.50
Nut Weight (lbs.)	1.5	1.5
Ball Nut Number	SGN10117	PRN10115
Flange Part Number	FLG7571	FLG7571
Wiper Kit Part Number	—	—

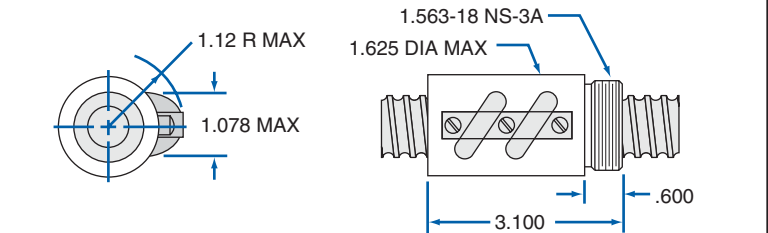

SSN Preloaded Flanged Ball Nut with Wipers 86 bearing balls per circuit - 172 total per nut

PRODUCT SPECIFICATIONS	RH
Dynamic Load (lbs.)	2,285
Static Load (lbs.)	15,815
Torque to Raise 1 lb. (in.-lb.)	.044
Spring Rate x 10 ⁶ (lb./in.)	3.50
Nut Weight (lbs.)	2.0
Ball Nut Number	SSN0404
Flange	INTEGRAL
Wiper Type	ELASTOMER

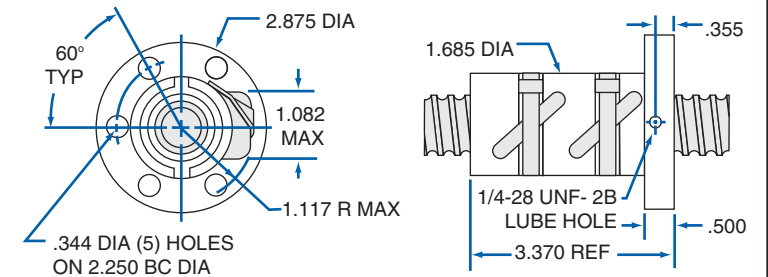

SAG Adjustable Preload Flanged Ball Nut with Wipers 86 bearing balls per circuit - 172 total per nut

PRODUCT SPECIFICATIONS	RH
Dynamic Load (lbs.)	2,285
Static Load (lbs.)	15,815
Torque to Raise 1 lb. (in.-lb.)	.044
Preload (lbs.)	330
Nut Weight (lbs.)	2.0
Ball Nut Number	SAG0703
Flange	INTEGRAL
Wiper Type	BRUSH

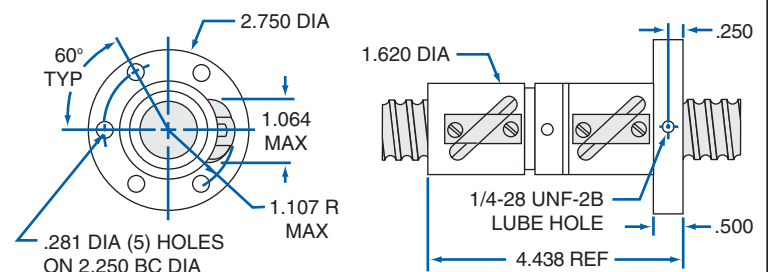

INCH BALL SCREW AND NUT TECHNICAL DATA

1000-0500 SRT

LEAD ACCURACY: ±0.004 in./ft.

Double Start

- 1.000** Ball Circle Diameter
- 0.500** Lead
- 0.820** Root Diameter
- 0.156** Nominal Ball Diameter
- 2.2** Screw Weight (lbs./ft.)

Standard Screw Lengths	PART NUMBERS
	RH
4 FT.	SRT9990
8 FT.	SRT9991
12 FT.	SRT9992
16 FT.	SRT9993

Custom cut lengths available up to 24'. For longer lengths contact Customer Service.

INCH BALL SCREW AND NUT TECHNICAL DATA

SBN Double Circuit Ball Nut

91 bearing balls per circuit - 182 total per nut

PRODUCT SPECIFICATIONS	RH
Dynamic Load (lbs.)	3,440
Static Load (lbs.)	25,250
Torque to Raise 1 lb. (in.-lb.)	.088
Nut Weight (lbs.)	1.2
Ball Nut Number	SBN1050
Flange Part Number	FLG7571
Wiper Kit Part Number	WKB1050

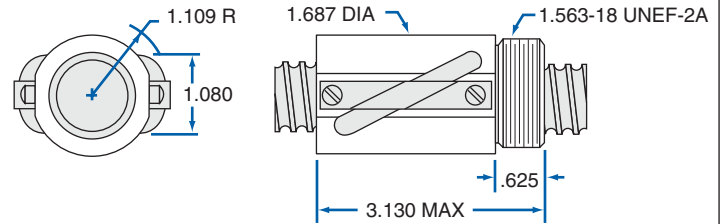

SEL Adjustable Preload Integral Wipers Ball Nut

91 bearing balls per circuit - 364 total per nut

PRODUCT SPECIFICATIONS	RH
Dynamic Load (lbs.)	3,440
Static Load (lbs.)	25,250
Torque to Raise 1 lb. (in.-lb.)	.088
Preload Range (lbs.)	272-817
Nut Weight (lbs.)	2.6
Ball Nut Number	SEL10066
Flange Part Number	FLG7571
Wiper Kit Part Number	WKB1050

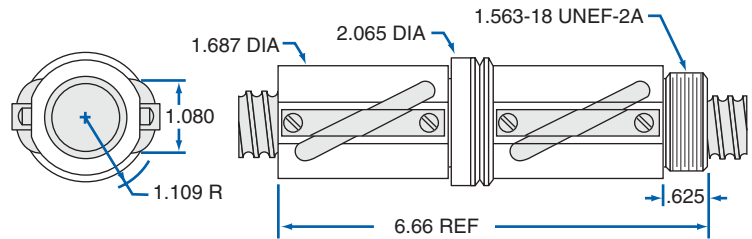

Flange - FLG7571

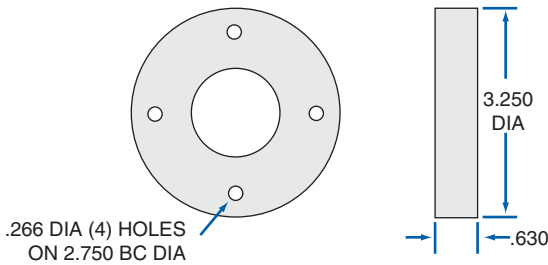

**Brush
Wiper Kit -
WKB1050**
2 wipers and
1 retainer

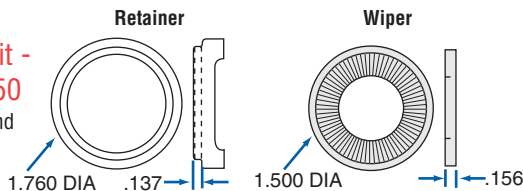

BALL SCREW ASSEMBLIES

These assemblies are shipped with screw, nut, flange, and bearing supports.

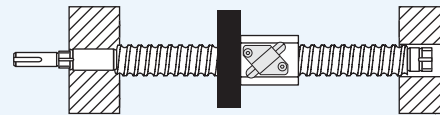

See page 145 for complete product details.

EZZE-MOUNT™ END BEARING SUPPORTS

A convenient solution for mounting ball screw assemblies.

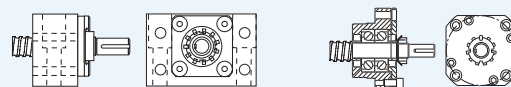

Single or Double Bearing
Universal Mount

Single or Double Bearing
Flange Mount

See page 214 for complete product details.

Standard Screw Lengths	PART NUMBERS	
	RH	
4 FT.	SRT6814	
8 FT.	SRT6822	
12 FT.	SRT6830	
16 FT.	SRT0429	

Custom cut lengths available up to 24'. For longer lengths contact Customer Service.

1000-1000 SRT

LEAD ACCURACY: ±0.004 in./ft.

Four Start

- 1.000** Ball Circle Diameter
- 1.000** Lead
- 0.820** Root Diameter
- 0.156** Nominal Ball Diameter
- 2.2** Screw Weight (lbs./ft.)

SBN Double Circuit Ball Nut

50 bearing balls per circuit - 100 total per nut

PRODUCT SPECIFICATIONS	RH
Dynamic Load (lbs.)	2,142
Static Load (lbs.)	11,925
Torque to Raise 1 lb. (in.-lb.)	.177
Nut Weight (lbs.)	1.11
Ball Nut Number	SBN10461
Flange Part Number	FLG7571
Wiper Kit Part Number	WKB1050

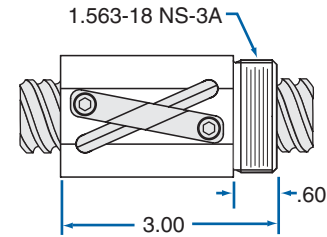
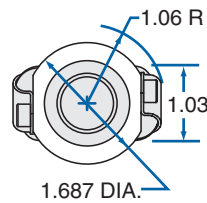

SEL Adjustable Preload Ball Nut

50 bearing balls per circuit - 200 total per nut

PRODUCT SPECIFICATIONS	RH
Dynamic Load (lbs.)	2,142
Static Load (lbs.)	11,925
Torque to Raise 1 lb. (in.-lb.)	.177
Preload (lbs.)	300
Nut Weight (lbs.)	2.5
Ball Nut Number	SEL10462
Flange Part Number	FLG7571
Wiper Kit Part Number	WKB1050

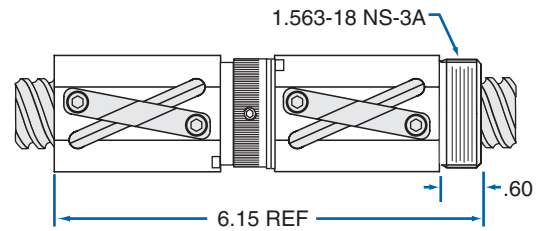
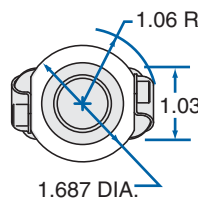

Flange - FLG7571

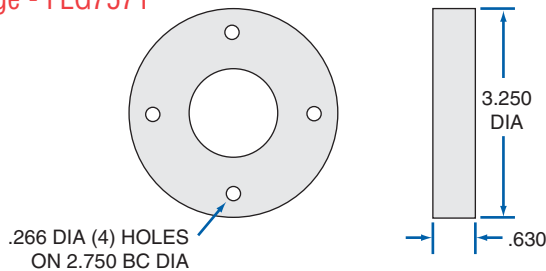

Brush Wiper Kit - WKB1050

2 wipers and
1 retainer

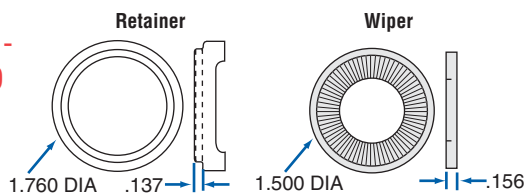

BALL SCREW ASSEMBLIES

These assemblies are shipped with screw, nut, flange, and bearing supports.

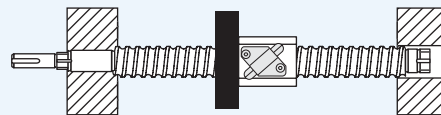

See page 145 for complete product details.

EZZE-MOUNT™ END BEARING SUPPORTS

A convenient solution for mounting ball screw assemblies.

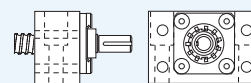

Single or Double Bearing
Universal Mount

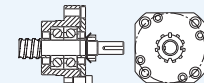

Single or Double Bearing
Flange Mount

See page 214 for complete product details.

1150-0200 SRT

LEAD ACCURACY: ±0.004 in./ft.

Single Start

- 1.150** Ball Circle Diameter
- 0.200** Lead
- 1.015** Root Diameter
- 0.125** Nominal Ball Diameter
- 3.18** Screw Weight (lbs./ft.)

Standard Screw Lengths	PART NUMBERS	
	RH	LH
4 FT.	SRT8738	SRT0285
8 FT.	SRT8746	SRT0286
12 FT.	SRT8753	SRT0287
16 FT.	SRT0430	SRT0431

Custom cut lengths available up to 24'. For longer lengths contact Customer Service.

INCH BALL SCREW AND NUT TECHNICAL DATA

SBN Double Circuit Ball Nut

121 bearing balls per circuit - 242 total per nut

PRODUCT SPECIFICATIONS	RH	LH
Dynamic Load (lbs.)	2,370	2,370
Static Load (lbs.)	26,180	26,180
Torque to Raise 1 lb. (in.-lb.)	.035	.035
Nut Weight (lbs.)	.9	.9
Ball Nut Number	SBN1566	SBN0207
Flange Part Number	FLG8283	FLG8283
Wiper Kit Part Number	WKB2652	WKB2652

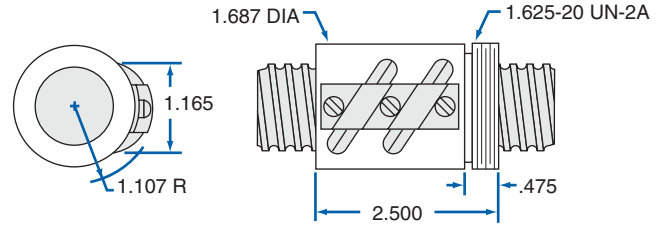

SEL Adjustable Preload Ball Nut

121 bearing balls per circuit - 242 total per nut

PRODUCT SPECIFICATIONS	RH	LH
Dynamic Load (lbs.)	1,185	1,185
Static Load (lbs.)	13,090	13,090
Torque to Raise 1 lb. (in.-lb.)	.035	.035
Preload (lbs.)	240	240
Nut Weight (lbs.)	1.34	1.34
Ball Nut Number	SEL4270	SEL0206
Flange Part Number	FLG8283	FLG8283
Wiper Kit Part Number	WKB2652	WKB2652

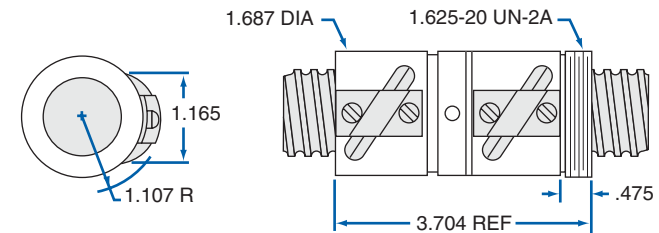

SAR Adjustable Preload Flanged Ball Nut

121 bearing balls per circuit - 242 total per nut

PRODUCT SPECIFICATIONS	RH	LH
Dynamic Load (lbs.)	1,185	—
Static Load (lbs.)	13,090	—
Torque to Raise 1 lb. (in.-lb.)	.035	—
Preload (lbs.)	240	—
Nut Weight (lbs.)	1.8	—
Ball Nut Number	SAR3042	—
Flange	INTEGRAL	—
Wiper Type	BRUSH	—

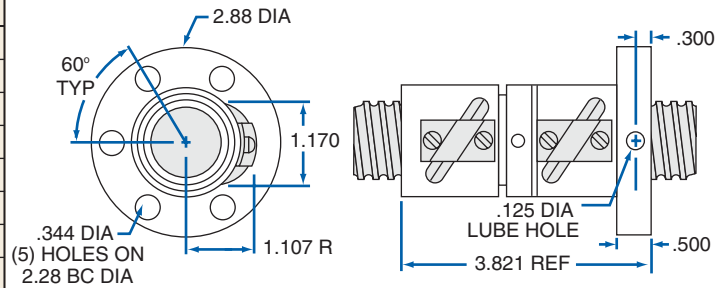

Flange - FLG8283

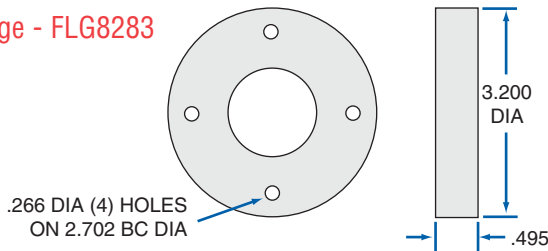

Brush
Wiper Kit -
WKB2652

2 wipers and
1 retainer

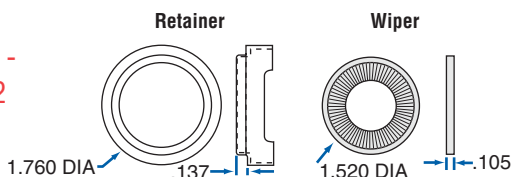

TWIN-LEAD SCREW

Single piece twin-lead screws offer opposing motion through a single drive system.

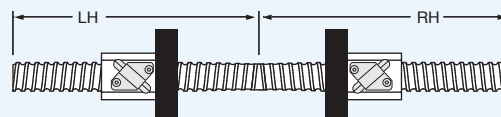

See page 148 for complete product details.

LUBRICANT

Prolong ball screw and nut performance with this special lubricant.

See page 95 for complete product details.

Standard Screw Lengths	PART NUMBERS	
	XPR RH	SGT RH
6 FT.	XPR11520R72	GT11520R72
12 FT.	XPR11520R144	—

XPR custom cut lengths available up to 12',
SGT custom cut lengths available up to 6', contact Customer Service.

1150-0200 XPR and SGT

LEAD ACCURACY: XPR ±0.001 in./ft. SGT ±0.0005 in./ft.

Single Start

- 1.150** Ball Circle Diameter
- 0.200** Lead
- 1.015** Root Diameter
- 0.125** Nominal Ball Diameter
- 3.18** Screw Weight (lbs./ft.)

PRN Preloaded Ball Nut with Wipers		121 bearing balls per circuit - 242 total per nut
PRODUCT SPECIFICATIONS	RH	
Dynamic Load (lbs.)	1,680	
Static Load (lbs.)	14,886	
Torque to Raise 1 lb. (in.-lb.)	.035	
Spring Rate x 10 ⁶ (lb./in.)	4.25	
Nut Weight (lbs.)	1.45	
Ball Nut Number	PRN10112	
Flange Part Number	FLG7576*	
Wiper Type	ELASTOMER	

* See page 116 for Flange dimensions.

SSN Preloaded Flanged Ball Nut with Wipers		121 bearing balls per circuit - 242 total per nut
PRODUCT SPECIFICATIONS	RH	
Dynamic Load (lbs.)	1,680	
Static Load (lbs.)	14,886	
Torque to Raise 1 lb. (in.-lb.)	.035	
Spring Rate x 10 ⁶ (lb./in.)	4.25	
Nut Weight (lbs.)	2.0	
Ball Nut Number	SSN0392	
Flange	INTEGRAL	
Wiper Type	ELASTOMER	

SAG Adjustable Preload Flanged Ball Nut		121 bearing balls per circuit - 242 total per nut
PRODUCT SPECIFICATIONS	RH	
Dynamic Load (lbs.)	1,680	
Static Load (lbs.)	14,886	
Torque to Raise 1 lb. (in.-lb.)	.035	
Preload (lbs.)	240	
Nut Weight (lbs.)	1.8	
Ball Nut Number	SAG0704	
Flange	INTEGRAL	
Wiper Type	BRUSH	

BALL SCREW ASSEMBLIES

These assemblies are shipped with screw, nut, flange, and bearing supports.

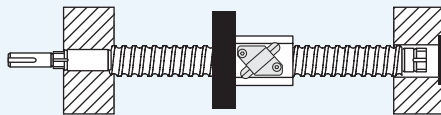

See page 145 for complete product details.

EZZE-MOUNT™ END BEARING SUPPORTS

A convenient solution for mounting ball screw assemblies.

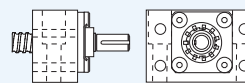

Single or Double Bearing
Universal Mount

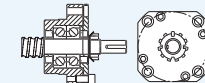

Single or Double Bearing
Flange Mount

See page 214 for complete product details.

1171-0413 SRT

LEAD ACCURACY: ±0.004 in./ft.

Single Start

- 1.171** Ball Circle Diameter
- 0.413** Lead
- 0.870** Root Diameter
- 0.281** Nominal Ball Diameter
- 2.77** Screw Weight (lbs./ft.)

Standard Screw Lengths	PART NUMBERS
	RH
4 FT.	SRT9569
8 FT.	SRT5035
12 FT.	SRT5043
16 FT.	SRT0432

Custom cut lengths available up to 24'. For longer lengths contact Customer Service.

INCH BALL SCREW AND NUT TECHNICAL DATA

SBN Double Circuit Ball Nut

28 bearing balls per circuit - 56 total per nut

PRODUCT SPECIFICATIONS	RH
Dynamic Load (lbs.)	3,894
Static Load (lbs.)	22,917
Torque to Raise 1 lb. (in.-lb.)	.073
Nut Weight (lbs.)	1.9
Ball Nut Number	SBN7511
Flange Part Number	FLG7572
Wiper Kit Part Number	WKB2653

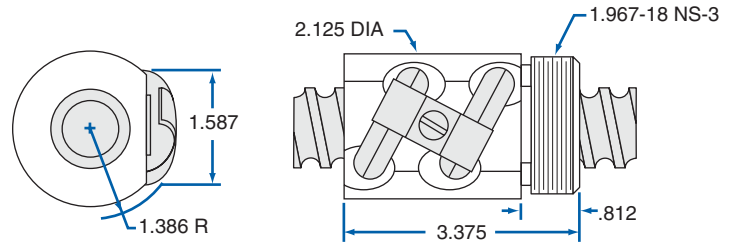

Flange - FLG7572

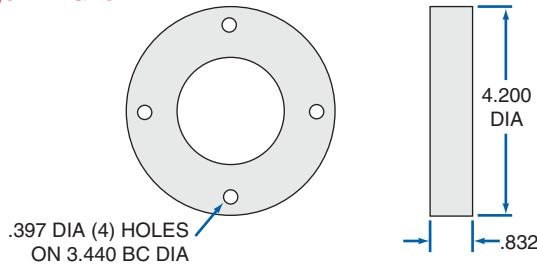

BALL SCREW ASSEMBLIES

These assemblies are shipped with screw, nut, flange, and bearing supports.

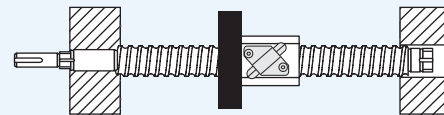

See page 145 for complete product details.

Brush Wiper Kit - WKB2653

2 wipers and 1 retainer

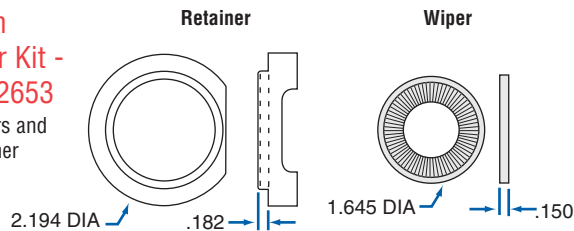

EZZE-MOUNT™ END BEARING SUPPORTS

A convenient solution for mounting ball screw assemblies.

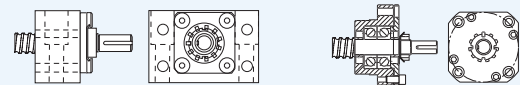

Single or Double Bearing Universal Mount

Single or Double Bearing Flange Mount

See page 214 for complete product details.

LUBRICANT

Prolong ball screw and nut performance with this special lubricant.



E-900 12oz. Spray or 32oz. Liquid
See page 95 for complete product details.



END MACHINING

Machining for Nook standard ends or custom requirement available.

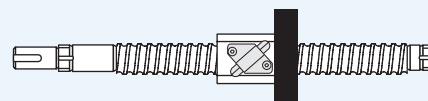

See page 212 for complete product details.

Standard Screw Lengths	PART NUMBERS	
	RH	LH
4 FT.	SRT1224	SRT1223
8 FT.	SRT1228	SRT1227
12 FT.	SRT1222	SRT1221
16 FT.	SRT1226	SRT1225

Custom cut lengths available up to 24'. For longer lengths contact Customer Service.

1250-0200 SRT

LEAD ACCURACY: ±0.004 in./ft.

Single Start

- 1.250** Ball Circle Diameter
- 0.200** Lead
- 1.115** Root Diameter
- 0.125** Nominal Ball Diameter
- 3.7** Screw Weight (lbs./ft.)

SBN Double Circuit Ball Nut			130 bearing balls per circuit - 260 total per nut
PRODUCT SPECIFICATIONS	RH	LH	
Dynamic Load (lbs.)	3,336	3,336	
Static Load (lbs.)	34,688	34,688	
Torque to Raise 1 lb. (in.-lb.)	.035	.035	
Nut Weight (lbs.)	1.8	1.8	
Ball Nut Number	SBN10187	SBN10189	
Flange Part Number	FLG8283	FLG8283	
Wiper Type	ELASTOMER	ELASTOMER	

Flange - FLG8283

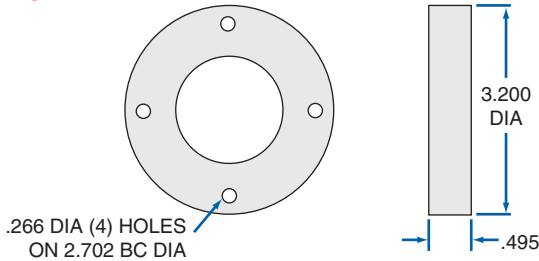

BALL SCREW ASSEMBLIES

These assemblies are shipped with screw, nut, flange, and bearing supports.

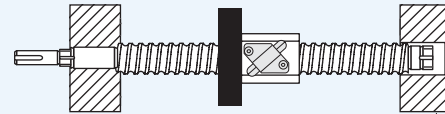

See page 145 for complete product details.

END MACHINING

Machining for Nook standard ends or custom requirement available.

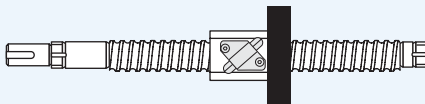

See page 212 for complete product details.

EZZE-MOUNT™ END BEARING SUPPORTS

A convenient solution for mounting ball screw assemblies.

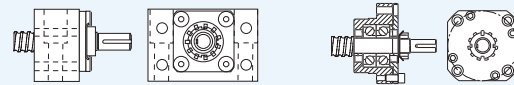

Single or Double Bearing
Universal Mount

Single or Double Bearing
Flange Mount

See page 214 for complete product details.

LUBRICANT

Prolong ball screw and nut performance with this special lubricant.

E-900 12oz. Spray or 32oz. Liquid
See page 95 for complete product details.



TWIN-LEAD SCREW

Single piece twin-lead screws offer opposing motion through a single drive system.

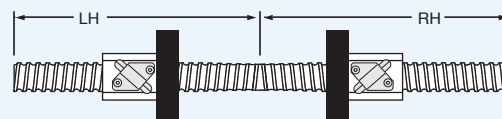

See page 148 for complete product details.

1250-0200 XPR and SGT

LEAD ACCURACY: XPR ±0.001 in./ft. SGT ±0.0005 in./ft.

Single Start

- 1.250 Ball Circle Diameter
- 0.200 Lead
- 1.115 Root Diameter
- 0.125 Nominal Ball Diameter
- 3.7 Screw Weight (lbs./ft.)

Standard Screw Lengths	PART NUMBERS		
	XPR-RH	SGT-RH	SGT-LH
6 FT.	XPR12520R72	GT12520R72	GT12520L72
12 FT.	XPR12520R144	—	—

XPR custom cut lengths available up to 12',
SGT custom cut lengths available up to 6', contact Customer Service.

INCH BALL SCREW AND NUT TECHNICAL DATA

PRN Preloaded Ball Nut with Wipers			130 bearing balls per circuit - 260 total per nut
PRODUCT SPECIFICATIONS	RH	LH	
Dynamic Load (lbs.)	1,668	1,668	
Static Load (lbs.)	17,344	17,344	
Torque to Raise 1 lb. (in.-lb.)	.035	.035	
Spring Rate x 10 ⁶ (lb./in.)	4.25	4.25	
Nut Weight (lbs.)	1.8	1.8	
Ball Nut Number	PRN10191	PRN10193	
Flange Part Number	—	—	
Wiper Type	ELASTOMER	ELASTOMER	

SSN Preloaded Flanged Ball Nut with Wipers			130 bearing balls per circuit - 260 total per nut
PRODUCT SPECIFICATIONS	RH	LH	
Dynamic Load (lbs.)	1,668	1,668	
Static Load (lbs.)	17,344	17,344	
Torque to Raise 1 lb. (in.-lb.)	.035	.035	
Spring Rate x 10 ⁶ (lb./in.)	4.25	4.25	
Nut Weight (lbs.)	1.8	1.8	
Ball Nut Number	SSN0393	SSN0398	
Flange	INTEGRAL	INTEGRAL	
Wiper Type	ELASTOMER	ELASTOMER	

BALL SCREW ASSEMBLIES

These assemblies are shipped with screw, nut, flange, and bearing supports.

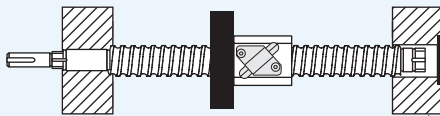

See page 145 for complete product details.

EZZE-MOUNT™ END BEARING SUPPORTS

A convenient solution for mounting ball screw assemblies.

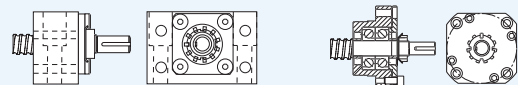

Single or Double Bearing Universal Mount

Single or Double Bearing Flange Mount

See page 214 for complete product details.

TWIN-LEAD SCREW

Single piece twin-lead screws offer opposing motion through a single drive system.

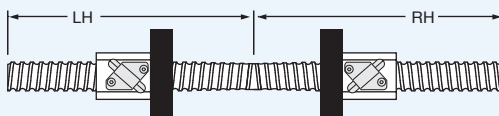

See page 148 for complete product details.

LUBRICANT

Prolong ball screw and nut performance with this special lubricant.



E-900 12oz. Spray or 32oz. Liquid
See page 95 for complete product details.

Standard Screw Lengths	PART NUMBERS
	RH
4 FT.	SRT1254
8 FT.	SRT1258
12 FT.	SRT1252
16 FT.	SRT1256

Custom cut lengths available up to 24'. For longer lengths contact Customer Service.

1250-0500 SRT

LEAD ACCURACY: ±0.004 in./ft.

Single Start

- 1.250** Ball Circle Diameter
- 0.500** Lead
- 1.050** Root Diameter
- 0.188** Nominal Ball Diameter
- 3.7** Screw Weight (lbs./ft.)

SBN Double Circuit Ball Nut		46 bearing balls per circuit - 92 total per nut
PRODUCT SPECIFICATIONS	RH	
Dynamic Load (lbs.)	2,745	
Static Load (lbs.)	17,235	
Torque to Raise 1 lb. (in.-lb.)	.088	
Nut Weight (lbs.)	1.8	
Ball Nut Number	SBN10104	
Flange Part Number	FLG7572	
Wiper Type	ELASTOMER	

Flange - FLG7572

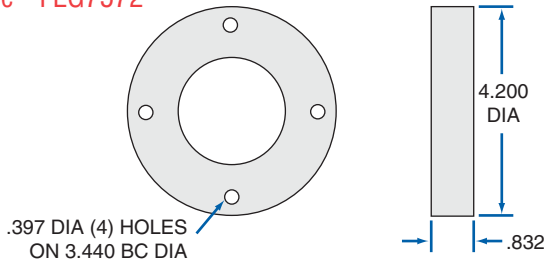

BALL SCREW ASSEMBLIES

These assemblies are shipped with screw, nut, flange, and bearing supports.

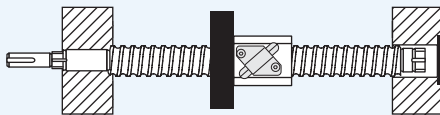

See page 145 for complete product details.

EZZE-MOUNT™ END BEARING SUPPORTS

A convenient solution for mounting ball screw assemblies.

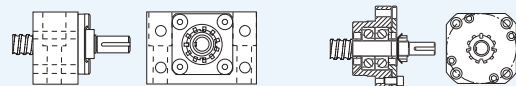

Single or Double Bearing
Universal Mount

Single or Double Bearing
Flange Mount

See page 214 for complete product details.

END MACHINING

Machining for Nook standard ends or custom requirement available.

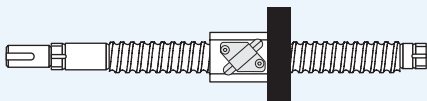

See page 212 for complete product details.

LUBRICANT

Prolong ball screw and nut performance with this special lubricant.

E-900 12oz. Spray or 32oz. Liquid
See page 95 for complete product details.



1250-0500 XPR and SGT

LEAD ACCURACY: XPR ± 0.001 in./ft. SGT ± 0.0005 in./ft.

Single Start

- 1.250** Ball Circle Diameter
- 0.500** Lead
- 1.050** Root Diameter
- 0.188** Nominal Ball Diameter
- 3.7** Screw Weight (lbs./ft.)

Standard Screw Lengths	PART NUMBERS	
	XPR RH	SGT RH
6 FT.	XPR12550R72	GT12550R72
12 FT.	XPR12550R144	—

XPR custom cut lengths available up to 12',
SGT custom cut lengths available up to 6', contact Customer Service.

INCH BALL SCREW AND NUT TECHNICAL DATA

PRN Preloaded Ball Nut with Wipers 46 bearing balls per circuit - 92 total per nut

PRODUCT SPECIFICATIONS	RH
Dynamic Load (lbs.)	1,765
Static Load (lbs.)	11,080
Torque to Raise 1 lb. (in.-lb.)	.088
Spring Rate x 10 ⁶ (lb./in.)	4.25
Nut Weight (lbs.)	2.75
Ball Nut Number	PRN10087
Flange Part Number	FLG7572
Wiper Type	ELASTOMER

SSN Preloaded Flanged Ball Nut with Wipers 46 bearing balls per circuit - 92 total per nut

PRODUCT SPECIFICATIONS	RH
Dynamic Load (lbs.)	1,765
Static Load (lbs.)	11,080
Torque to Raise 1 lb. (in.-lb.)	.088
Spring Rate x 10 ⁶ (lb./in.)	4.25
Nut Weight (lbs.)	3.2
Ball Nut Number	SSN0399
Flange	INTEGRAL
Wiper Type	ELASTOMER

BALL SCREW ASSEMBLIES

These assemblies are shipped with screw, nut, flange, and bearing supports.

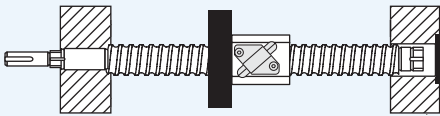

See page 145 for complete product details.

EZZE-MOUNT™

END BEARING SUPPORTS

A convenient solution for mounting ball screw assemblies.

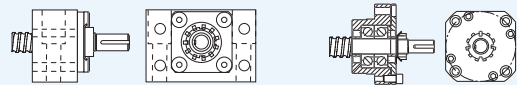

Single or Double Bearing
Universal Mount

Single or Double Bearing
Flange Mount

See page 214 for complete product details.

END MACHINING

Machining for Nook standard ends or custom requirement available.

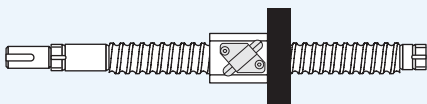

See page 212 for complete product details.

LUBRICANT

Prolong ball screw and nut performance with this special lubricant.



E-900 12oz. Spray or 32oz. Liquid
See page 95 for complete product details.



Standard Screw Lengths	PART NUMBERS
	SGT RH
6 FT.	GT15020R72
10 FT.	GT15020R120
Custom cut lengths available up to 10', contact Customer Service.	

1500-0200 SGT

LEAD ACCURACY: ±0.0005 in./ft.

Single Start

- 1.500** Ball Circle Diameter
- 0.200** Lead
- 1.349** Root Diameter
- 0.141** Nominal Ball Diameter
- 5.65** Screw Weight (lbs./ft.)

SSN Preloaded Flanged Ball Nut with Wipers		137 bearing balls per circuit - 548 total per nut
PRODUCT SPECIFICATIONS	RH	
Dynamic Load (lbs.)	4,745	
Static Load (lbs.)	45,073	
Torque to Raise 1 lb. (in.-lb.)	.035	
Spring Rate x 10 ⁶ (lb./in.)	5.00	
Nut Weight (lbs.)	3.8	
Ball Nut Number	SSN0394	
Flange	INTEGRAL	
Wiper Type	ELASTOMER	

INCH BALL SCREW AND NUT TECHNICAL DATA

BALL SCREW ASSEMBLIES

These assemblies are shipped with screw, nut, flange, and bearing supports.

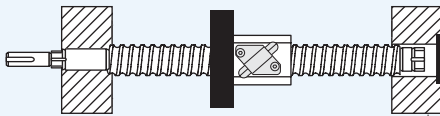

See page 145 for complete product details.

EZZE-MOUNT™ END BEARING SUPPORTS

A convenient solution for mounting ball screw assemblies.

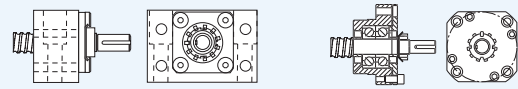

Single or Double Bearing
Universal Mount

Single or Double Bearing
Flange Mount

See page 214 for complete product details.

END MACHINING

Machining for Nook standard ends or custom requirement available.

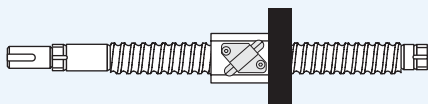

See page 212 for complete product details.

LUBRICANT

Prolong ball screw and nut performance with this special lubricant.

E-900 12oz. Spray or 32oz. Liquid
See page 95 for complete product details.



1500-0250 SRT

LEAD ACCURACY: ±0.004 in./ft.

Single Start

- 1.500** Ball Circle Diameter
- 0.250** Lead
- 1.320** Root Diameter
- 0.156** Nominal Ball Diameter
- 5.16** Screw Weight (lbs./ft.)

Standard Screw Lengths	PART NUMBERS	
	RH	LH
4 FT.	SRT7012	SRT3252
8 FT.	SRT7020	SRT3253
12 FT.	SRT7028	SRT3254
16 FT.	SRT0433	SRT0434
20 FT.	SRT0595	SRT0596

Custom cut lengths available up to 24'. For longer lengths contact customer service.

INCH BALL SCREW AND NUT TECHNICAL DATA

SBN Double Circuit Ball Nut

125 bearing balls per circuit - 250 total per nut

PRODUCT SPECIFICATIONS	RH	LH
Dynamic Load (lbs.)	4,198	4,198
Static Load (lbs.)	44,030	44,030
Torque to Raise 1 lb. (in.-lb.)	.044	.044
Nut Weight (lbs.)	1.7	1.7
Ball Nut Number	SBN9587	SBN1990
Flange Part Number	FLG6754	FLG6754
Wiper Kit Part Number	WKB2654	WKB2654

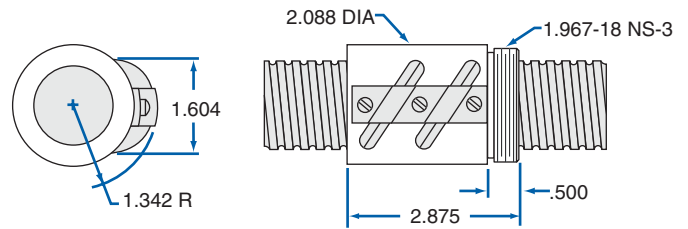

SEL Preload Ball Nut

125 bearing balls per circuit - 500 total per nut

PRODUCT SPECIFICATIONS	RH	LH
Dynamic Load (lbs.)	4,198	4,198
Static Load (lbs.)	44,030	44,030
Torque to Raise 1 lb. (in.-lb.)	.044	.044
Nut Weight (lbs.)	3.0	3.0
Preload (lbs.)	920	920
Ball Nut Number	SEL4271	SEL4573
Flange Part Number	FLG6754	FLG6754
Wiper Kit Part Number	WKB2654	WKB2654

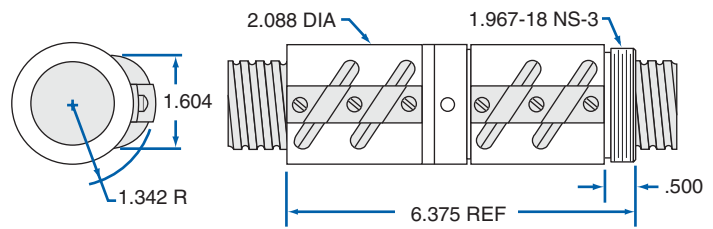

SAR Adjustable Preload Flanged Ball Nut

125 bearing balls per circuit - 500 total per nut

PRODUCT SPECIFICATIONS	RH	LH
Dynamic Load (lbs.)	4,198	—
Static Load (lbs.)	44,030	—
Torque to Raise 1 lb. (in.-lb.)	.044	—
Nut Weight (lbs.)	6.0	—
Preload (lbs.)	920	—
Ball Nut Number	SAR3043	—
Flange	INTEGRAL	—
Wiper Type	BRUSH	—

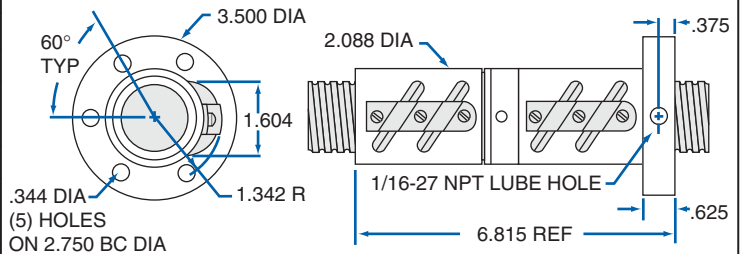

Flange - FLG6754

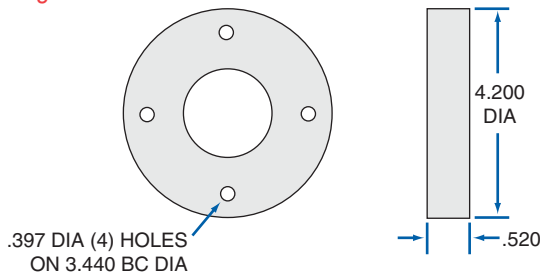

Brush Wiper Kit - WKB2654

2 wipers and 1 retainer

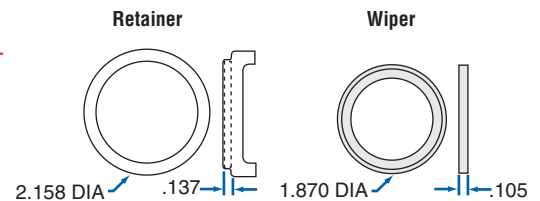

TWIN-LEAD SCREW

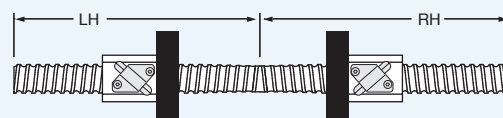

See page 148 for complete product details.

Standard Screw Lengths	PART NUMBERS	
	XPR RH	SGT RH
6 FT.	XPR15025R72	GT15025R72
10 FT.	—	GT15025R120
12 FT.	XPR15025R144	—

XPR custom cut lengths available up to 12',
SGT custom cut lengths available up to 10', contact Customer Service.

1500-0250 XPR and SGT

LEAD ACCURACY: XPR ±0.001 in./ft. SGT ±0.0005 in./ft.

- Single Start
- 1.500** Ball Circle Diameter
 - 0.250** Lead
 - 1.320** Root Diameter
 - 0.156** Nominal Ball Diameter
 - 5.41** Screw Weight (lbs./ft.)

PRN Preloaded Ball Nut with Wipers 95 bearing balls per circuit - 380 total per nut

PRODUCT SPECIFICATIONS	RH
Dynamic Load (lbs.)	5,075
Static Load (lbs.)	27,250
Torque to Raise 1 lb. (in.-lb.)	.044
Spring Rate x 10 ⁶ (lb./in.)	5.0
Nut Weight (lbs.)	2.7
Ball Nut Number	PRN10113
Flange Part Number	—
Wiper Type	ELASTOMER

SSN Preloaded Flanged Ball Nut with Wipers 95 bearing balls per circuit - 380 total per nut

PRODUCT SPECIFICATIONS	RH
Dynamic Load (lbs.)	5,075
Static Load (lbs.)	27,250
Torque to Raise 1 lb. (in.-lb.)	.044
Spring Rate x 10 ⁶ (lb./in.)	5.0
Nut Weight (lbs.)	3.8
Ball Nut Number	SSN0400
Flange	INTEGRAL
Wiper Type	ELASTOMER

SAG Adjustable Preload Flanged Ball Nut 95 bearing balls per circuit - 380 total per nut

PRODUCT SPECIFICATIONS	RH
Dynamic Load (lbs.)	5,950
Static Load (lbs.)	44,030
Torque to Raise 1 lb. (in.-lb.)	.044
Preload (lbs.)	920
Nut Weight (lbs.)	6
Ball Nut Number	SAG0705
Flange	INTEGRAL
Wiper Type	BRUSH

BALL SCREW ASSEMBLIES

These assemblies are shipped with screw, nut, flange, and bearing supports.

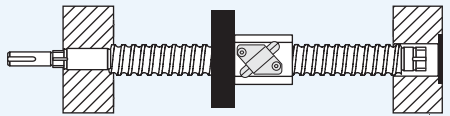

See page 145 for complete product details.

EZZE-MOUNT™ END BEARING SUPPORTS

A convenient solution for mounting ball screw assemblies.

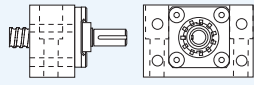

Single or Double Bearing Universal Mount

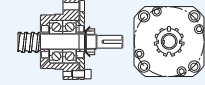

Single or Double Bearing Flange Mount

See page 214 for complete product details.

INCH BALL SCREW AND NUT TECHNICAL DATA

1500-0473 SRT

LEAD ACCURACY: ±0.004 in./ft.

Single Start

- 1.500** Ball Circle Diameter
- 0.473** Lead*
- 1.140** Root Diameter
- 0.344** Nominal Ball Diameter
- 4.47** Screw Weight (lbs./ft.)

* actual lead 0.47368

Standard Screw Lengths	PART NUMBERS
	RH
4 FT.	SRT9610
8 FT.	SRT9127
12 FT.	SRT9624
16 FT.	SRT0435
20 FT.	SRT0597

Custom cut lengths available up to 24'. For longer lengths contact Customer Service.

INCH BALL SCREW AND NUT TECHNICAL DATA

SBN Double Circuit Ball Nut

43 bearing balls per circuit - 86 total per nut

PRODUCT SPECIFICATIONS	RH
Dynamic Load (lbs.)	10,050
Static Load (lbs.)	57,770
Torque to Raise 1 lb. (in.-lb.)	.084
Nut Weight (lbs.)	3.9
Ball Nut Number	SBN7513
Flange Part Number	FLG7573
Wiper Kit Part Number	WKB2655

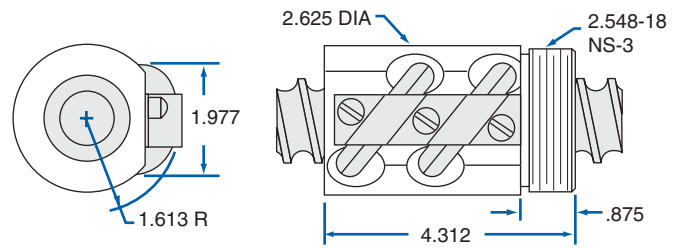

SBN Keyed Double Circuit Ball Nut

43 bearing balls per circuit - 86 total per nut

PRODUCT SPECIFICATIONS	RH
Dynamic Load (lbs.)	10,050
Static Load (lbs.)	57,770
Torque to Raise 1 lb. (in.-lb.)	.084
Nut Weight (lbs.)	3.9
Ball Nut Number	SBN8345
Flange Part Number	—
Wiper Kit Part Number	WKB2656

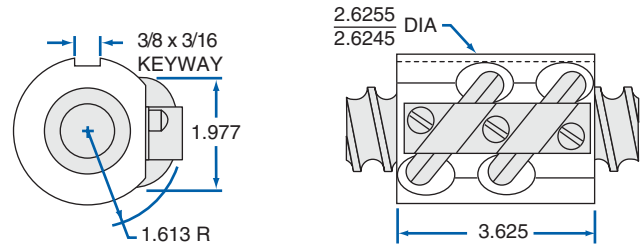

Flange - FLG7573

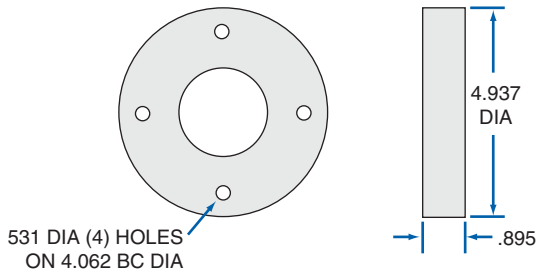

Brush Wiper Kit - WKB2656

2 wipers and 2 retainers

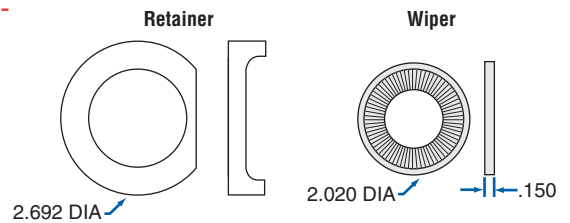

Brush Wiper Kit - WKB2655

2 wipers, 1 retainer and 1 retaining ring

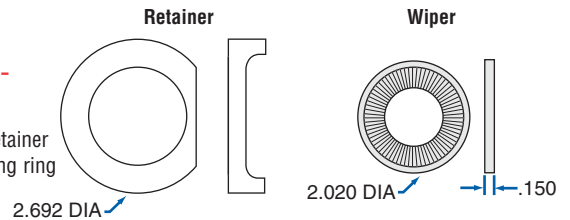

Standard Screw Lengths	PART NUMBERS	
	RH	
4 FT.	SRT9994	
8 FT.	SRT9995	
12 FT.	SRT9996	
16 FT.	SRT9997	

Custom cut lengths available up to 24'. For longer lengths contact Customer Service.

1500-0500 SRT

LEAD ACCURACY: ±0.004 in./ft.

Single Start

- 1.500** Ball Circle Diameter
- 0.500** Lead
- 1.174** Root Diameter
- 0.312** Nominal Ball Diameter
- 5.25** Screw Weight (lbs./ft.)

SBN Double Circuit Ball Nut

65 bearing balls per circuit - 130 total per nut

PRODUCT SPECIFICATIONS	RH
Dynamic Load (lbs.)	12,320
Static Load (lbs.)	97,696
Torque to Raise 1 lb. (in.-lb.)	.088
Nut Weight (lbs.)	5.2
Ball Nut Number	SBN1550
Flange Part Number	FLG10060
Wiper Type	BRUSH

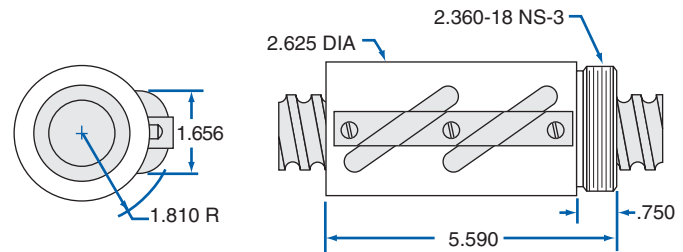

SEL Adjustable Preload Ball Nut

65 bearing balls per circuit - 260 total per nut

PRODUCT SPECIFICATIONS	RH
Dynamic Load (lbs.)	12,320
Static Load (lbs.)	97,696
Torque to Raise 1 lb. (in.-lb.)	.088
Preload Range (lbs.)	1,232-3,696
Nut Weight (lbs.)	11.7
Ball Nut Number	SEL10072
Flange Part Number	FLG10060
Wiper Type	BRUSH

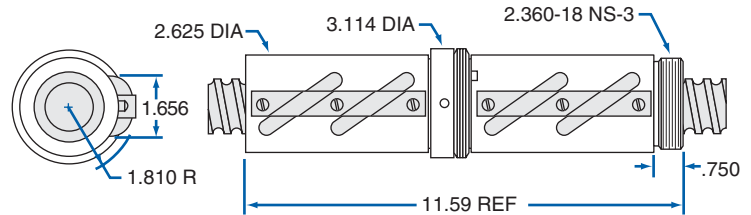

Flange - FLG10060

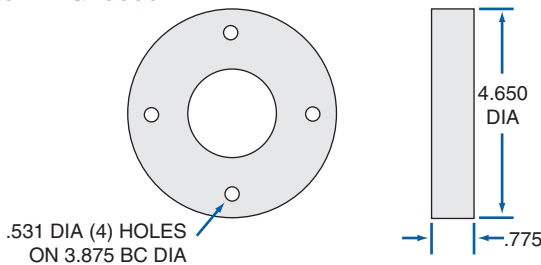

BALL SCREW ASSEMBLIES

These assemblies are shipped with screw, nut, flange, and bearing supports.

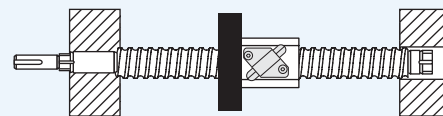

See page 145 for complete product details.

EZZE-MOUNT™ END BEARING SUPPORTS

A convenient solution for mounting ball screw assemblies.

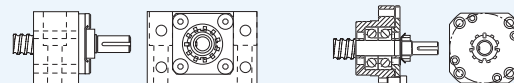

Single or Double Bearing
Universal Mount

Single or Double Bearing
Flange Mount

See page 214 for complete product details.



LUBRICANT

Prolong ball screw and nut performance with this special lubricant.

E-900 12oz. Spray or 32oz. Liquid
See page 95 for complete product details.



1500-0500 XPR

LEAD ACCURACY: ±0.001 in./ft.

Single Start

- 1.500 Ball Circle Diameter
- 0.500 Lead
- 1.174 Root Diameter
- 0.312 Nominal Ball Diameter
- 5.3 Screw Weight (lbs./ft.)

Standard Screw Lengths	PART NUMBERS
	XPR RH
6 FT.	XPR15050R72
12 FT.	XPR15050R144
Custom cut lengths available up to 12', contact Customer Service.	

INCH BALL SCREW AND NUT TECHNICAL DATA

PRN Preloaded Ball Nut with Wipers

48 bearing balls per circuit - 96 total per nut

PRODUCT SPECIFICATIONS	RH
Dynamic Load (lbs.)	5,650
Static Load (lbs.)	35,522
Torque to Raise 1 lb. (in.-lb.)	.088
Spring Rate x 10 ⁶ (lb./in.)	5.2
Nut Weight (lbs.)	3.5
Ball Nut Number	PRN10114
Flange Part Number	—
Wiper Type	ELASTOMER

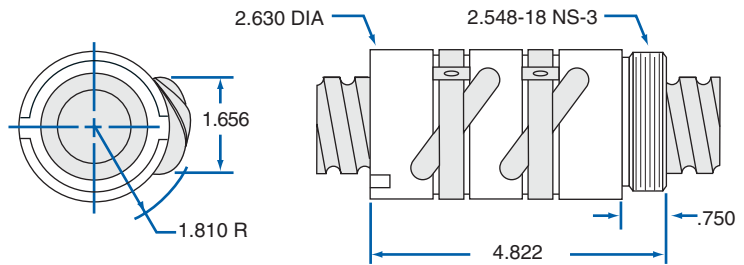

1500-0500 SGT

LEAD ACCURACY: ±0.0005 in./ft.

Single Start

- 1.500 Ball Circle Diameter
- 0.500 Lead
- 1.230 Root Diameter
- 0.250 Nominal Ball Diameter
- 5.3 Screw Weight (lbs./ft.)

Standard Screw Lengths	PART NUMBERS
	SGT RH
6 FT.	GT15050R72
10 FT.	GT15050R120
Custom cut lengths available up to 10', contact Customer Service.	

SSN Preloaded Flanged Ball Nut with Wipers

48 bearing balls per circuit - 96 total per nut

PRODUCT SPECIFICATIONS	RH
Dynamic Load (lbs.)	4,250
Static Load (lbs.)	35,770
Torque to Raise 1 lb. (in.-lb.)	.088
Spring Rate x 10 ⁶ (lb./in.)	5.0
Nut Weight (lbs.)	3.8
Ball Nut Number	SSN0401
Flange	INTEGRAL
Wiper Type	ELASTOMER

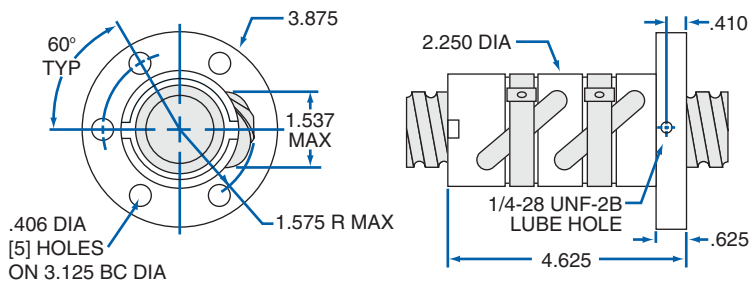

BALL SCREW ASSEMBLIES

These assemblies are shipped with screw, nut, flange, and bearing supports.

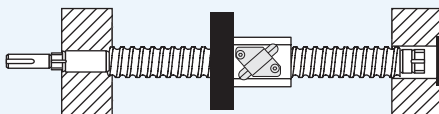

See page 145 for complete product details.

EZZE-MOUNT™ END BEARING SUPPORTS

A convenient solution for mounting ball screw assemblies.

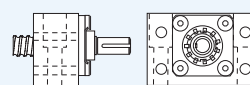

Single or Double Bearing Universal Mount

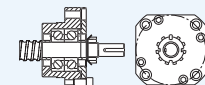

Single or Double Bearing Flange Mount

See page 214 for complete product details.

Standard Screw Lengths	PART NUMBERS	
	RH	LH
4 FT.	SRT8837	SRT1991
8 FT.	SRT8845	SRT1992
12 FT.	SRT8853	SRT2203
16 FT.	SRT0436	SRT0437
20 FT.	SRT0598	SRT0615

Custom cut lengths available up to 24'. For longer lengths contact customer service.

1500-1000 SRT

LEAD ACCURACY: ±0.004 in./ft.

Double Start

- 1.500** Ball Circle Diameter
- 1.000** Lead
- 1.140** Root Diameter
- 0.344** Nominal Ball Diameter
- 4.47** Screw Weight (lbs./ft.)

SBN Double Circuit Ball Nut			30 bearing balls per circuit - 60 total per nut
PRODUCT SPECIFICATIONS	RH	LH	
Dynamic Load (lbs.)	7,560	7,560	
Static Load (lbs.)	34,662	34,662	
Torque to Raise 1 lb. (in.-lb.)	.177	.177	
Nut Weight (lbs.)	3.9	3.9	
Ball Nut Number	SBN8280	SBN1995	
Flange Part Number	FLG7777	FLG7777	
Wiper Kit Part Number	WKB2657	WKB2657	

SEL Adjustable Preload Ball Nut			30 bearing balls per circuit - 60 total per nut
PRODUCT SPECIFICATIONS	RH	LH	
Dynamic Load (lbs.)	7,560	7,560	
Static Load (lbs.)	34,662	34,662	
Torque to Raise 1 lb. (in.-lb.)	.177	.177	
Preload Range (lbs.)	1,650	1,650	
Nut Weight (lbs.)	9.1	9.1	
Ball Nut Number	SEL0698	SEL0697	
Flange Part Number	FLG7777	FLG7777	
Wiper Kit Part Number	WKB2657	WKB2657	

Flange - FLG7777

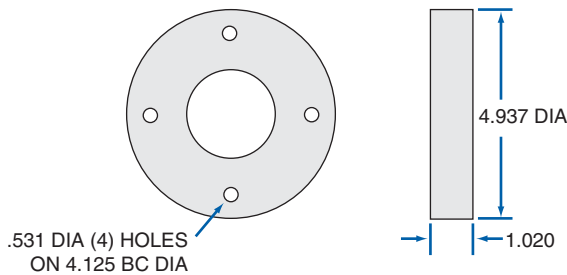

Brush Wiper Kit - WKB2657

2 wipers and
1 retainer

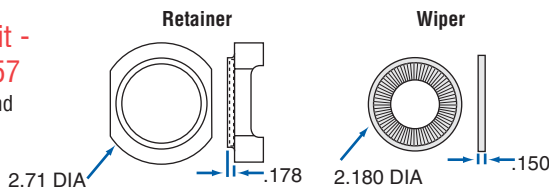

BALL SCREW ASSEMBLIES

These assemblies are shipped with screw, nut, flange, and bearing supports.

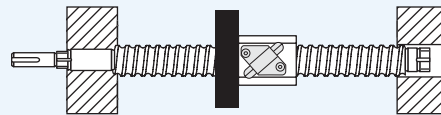

See page 145 for complete product details.

TWIN-LEAD SCREW

Single piece twin-lead screws offer opposing motion through a single drive system.

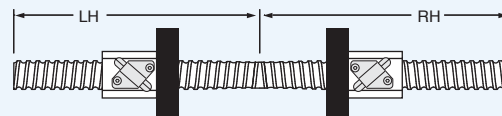

See page 148 for complete product details.

1500-1875 SRT

LEAD ACCURACY: ±0.004 in./ft.

Four Start

- 1.500** Ball Circle Diameter
- 1.875** Lead
- 1.188** Root Diameter
- 0.281** Nominal Ball Diameter
- 5.25** Screw Weight (lbs./ft.)

Standard Screw Lengths	PART NUMBERS
	RH
4 FT.	SRT7702
8 FT.	SRT7710
12 FT.	SRT7718
16 FT.	SRT0438
20 FT.	SRT0599

Custom cut lengths available up to 24'. For longer lengths contact Customer Service.

INCH BALL SCREW AND NUT TECHNICAL DATA

SBN Double Circuit Ball Nut

44 bearing balls per circuit - 88 total per nut

PRODUCT SPECIFICATIONS	RH
Dynamic Load (lbs.)	7,242
Static Load (lbs.)	29,895
Torque to Raise 1 lb. (in.-lb.)	.332
Nut Weight (lbs.)	4.2
Ball Nut Number	SBN7654
Flange Part Number	FLG7777
Wiper Kit Part Number	WKB2657

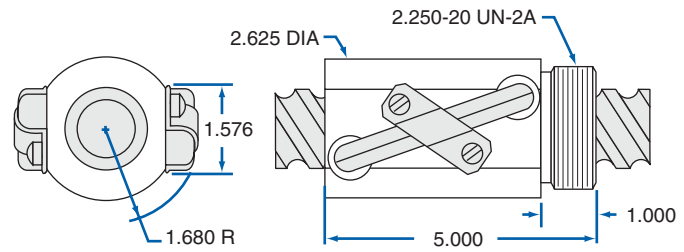

SEL Adjustable Preload Integral Wipers Ball Nut

44 bearing balls per circuit - 176 total per nut

PRODUCT SPECIFICATIONS	RH
Dynamic Load (lbs.)	7,242
Static Load (lbs.)	29,895
Torque to Raise 1 lb. (in.-lb.)	.332
Preload Range (lbs.)	1,650
Nut Weight (lbs.)	9.9
Ball Nut Number	SEL4272
Flange Part Number	FLG7777
Wiper Kit Part Number	WKB2657

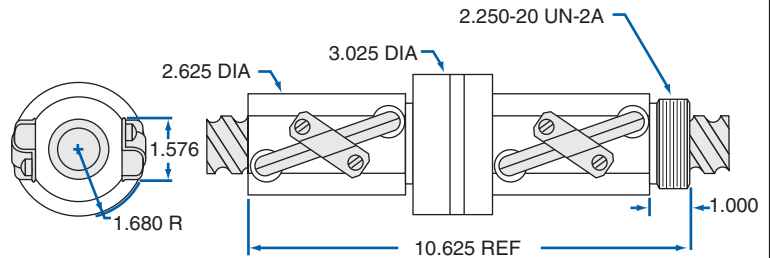

Flange - FLG7777

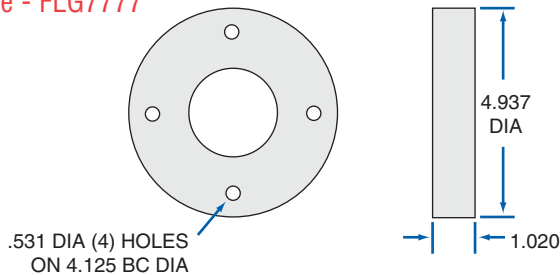

Brush Wiper Kit - WKB2657

2 wipers and 1 retainer

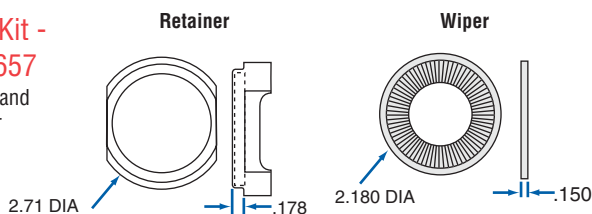

BALL SCREW ASSEMBLIES

These assemblies are shipped with screw, nut, flange, and bearing supports.

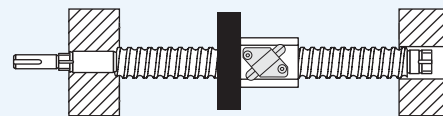

See page 145 for complete product details.

EZZE-MOUNT™ END BEARING SUPPORTS

A convenient solution for mounting ball screw assemblies.



Single or Double Bearing
Universal Mount

Single or Double Bearing
Flange Mount

See page 214 for complete product details.

Standard Screw Lengths	PART NUMBERS
	SGT RH
6 FT.	GT17525R72
Custom cut lengths available up to 6', contact Customer Service.	

1750-0250 SGT

LEAD ACCURACY: ±0.0005 in./ft.

Single Start

- 1.750** Ball Circle Diameter
- 0.250** Lead
- 1.613** Root Diameter
- 0.156** Nominal Ball Diameter
- 7.56** Screw Weight (lbs./ft.)

SSN Preloaded Flanged Ball Nut with Wipers		112 bearing balls per circuit - 448 total per nut
PRODUCT SPECIFICATIONS	RH	
Dynamic Load (lbs.)	5,600	
Static Load (lbs.)	32,500	
Torque to Raise 1 lb. (in.-lb.)	.044	
Spring Rate x 10 ⁶ (lb./in.)	5.8	
Nut Weight (lbs.)	3.25	
Ball Nut Number	SSN10277	
Flange	INTEGRAL	
Wiper Type	ELASTOMER	

BALL SCREW ASSEMBLIES

These assemblies are shipped with screw, nut, flange, and bearing supports.

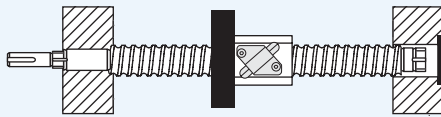

See page 145 for complete product details.

EZZE-MOUNT™ END BEARING SUPPORTS

A convenient solution for mounting ball screw assemblies.

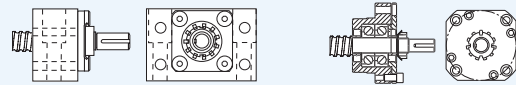

Single or Double Bearing
Universal Mount

Single or Double Bearing
Flange Mount

See page 214 for complete product details.

END MACHINING

Machining for Nook standard ends or custom requirement available.

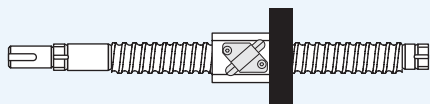

See page 212 for complete product details.

LUBRICANT

Prolong ball screw and nut performance with this special lubricant.

E-900 12oz. Spray or 32oz. Liquid
See page 95 for complete product details.



2000-0200 SGT

LEAD ACCURACY: ±0.0005 in./ft.

Single Start

- 2.000** Ball Circle Diameter
- 0.200** Lead
- 1.849** Root Diameter
- 0.141** Nominal Ball Diameter
- 9.9** Screw Weight (lbs./ft.)

Standard Screw Lengths	PART NUMBERS	
	SGT RH	SGT LH
6 FT.	GT20020R72	GT20020L48
10 FT.	GT20020R120	GT20020L120

Custom cut lengths available up to 10', contact Customer Service.

SSN Preloaded Flanged Ball Nut with Wipers

138 bearing balls per circuit - 828 total per nut

PRODUCT SPECIFICATIONS	RH	LH
Dynamic Load (lbs.)	6,181	6,181
Static Load (lbs.)	65,903	65,903
Torque to Raise 1 lb. (in.-lb.)	.035	.035
Spring Rate x 10⁶ (lb./in.)	6.50	6.50
Nut Weight (lbs.)	4.5	4.5
Ball Nut Number	SSN0396	SSN10267
Flange	INTEGRAL	INTEGRAL
Wiper Type	ELASTOMER	ELASTOMER

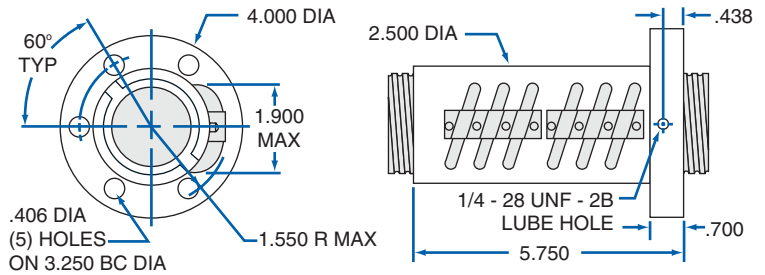

2000-0400 SGT

LEAD ACCURACY: ±0.0005 in./ft.

Single Start

- 2.000** Ball Circle Diameter
- 0.400** Lead
- 1.742** Root Diameter
- 0.250** Nominal Ball Diameter
- 9.4** Screw Weight (lbs./ft.)

Standard Screw Lengths	PART NUMBERS	
	SGT RH	
6 FT.	GT20040R72	
10 FT.	GT20040R120	

Custom cut lengths available up to 10', contact Customer Service.

SSN Preloaded Flanged Ball Nut with Wipers

79 bearing balls per circuit - 316 total per nut

PRODUCT SPECIFICATIONS	RH
Dynamic Load (lbs.)	12,830
Static Load (lbs.)	72,360
Torque to Raise 1 lb. (in.-lb.)	.070
Spring Rate x 10⁶ (lb./in.)	11.00
Nut Weight (lbs.)	6.7
Ball Nut Number	SSN10005
Flange	INTEGRAL
Wiper Type	ELASTOMER

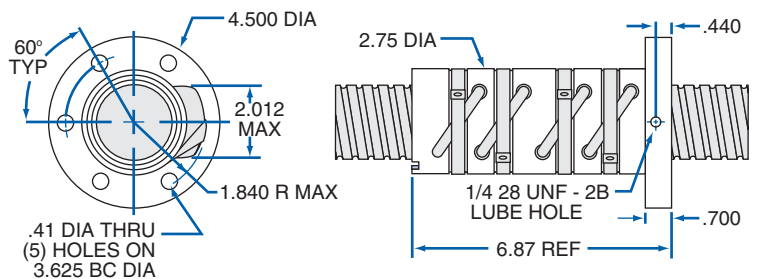

BALL SCREW ASSEMBLIES

These assemblies are shipped with screw, nut, flange, and bearing supports.

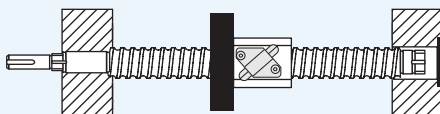

See page 145 for complete product details.

EZZE-MOUNT™ END BEARING SUPPORTS

A convenient solution for mounting ball screw assemblies.

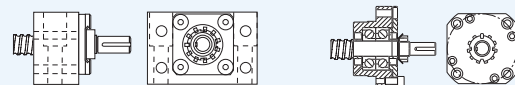

Single or Double Bearing Universal Mount

Single or Double Bearing Flange Mount

See page 214 for complete product details.

Standard Screw Lengths	PART NUMBERS	
	RH	LH
4 FT.	SRT5051	SRT4001
8 FT.	SRT5059	SRT4002
12 FT.	SRT5067	SRT4003
16 FT.	SRT0439	SRT0440
20 FT.	SRT0600	SRT0602

Custom cut lengths available up to 24'. For longer lengths contact customer service.

2250-0500 SRT

LEAD ACCURACY: ±0.004 in./ft.

Single Start

- 2.250** Ball Circle Diameter
- 0.500** Lead
- 1.850** Root Diameter
- 0.375** Nominal Ball Diameter
- 10.9** Screw Weight (lbs./ft.)

SBN Double Circuit Ball Nut

78 bearing balls per circuit - 156 total per nut

PRODUCT SPECIFICATIONS	RH	LH
Dynamic Load (lbs.)	21,306	21,306
Static Load (lbs.)	142,660	142,660
Torque to Raise 1 lb. (in.-lb.)	.088	.088
Nut Weight (lbs.)	9.0	9.0
Ball Nut Number	SBN7516	SBN4000
Flange Part Number	FLG7574	FLG7574
Wiper Kit Part Number	WKB2659/WKF3890	WKB2659/WKF0456

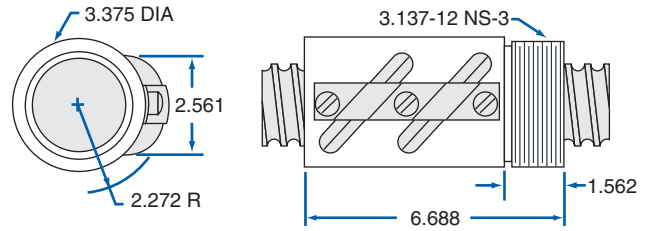

SBN Keyed Double Circuit Ball Nut

78 bearing balls per circuit - 156 total per nut

PRODUCT SPECIFICATIONS	RH	LH
Dynamic Load (lbs.)	21,306	21,306
Static Load (lbs.)	142,660	142,660
Torque to Raise 1 lb. (in.-lb.)	.088	.088
Nut Weight (lbs.)	8.2	8.2
Ball Nut Number	SBN8346	SBN4005
Flange Part Number	—	—
Wiper Kit Part Number	WKB2659	WKB2659

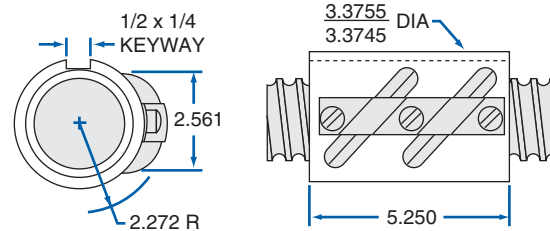

SAR Preloaded Flanged Ball Nut or SEL Preloaded Ball Nut

78 bearing balls per circuit - 312 total per nut

PRODUCT SPECIFICATIONS	SAR RH	SEL RH*	SEL LH*
Dynamic Load (lbs.)	21,306	21,306	21,306
Static Load (lbs.)	142,660	142,660	142,660
Torque to Raise 1 lb. (in.-lb.)	.088	.088	.088
Nut Weight (lbs.)	24.2	22.2	22.2
Preload Range (lbs.)	2,130-6,390	2,130-6,390	2,130-6,390
Ball Nut Number	SAR3044	SEL10084	SEL10090
Flange Part Number	INCLUDED	FLG7574	FLG7574
Wiper Type/Kit Part Number	BRUSH	WKB2659	WKF3890

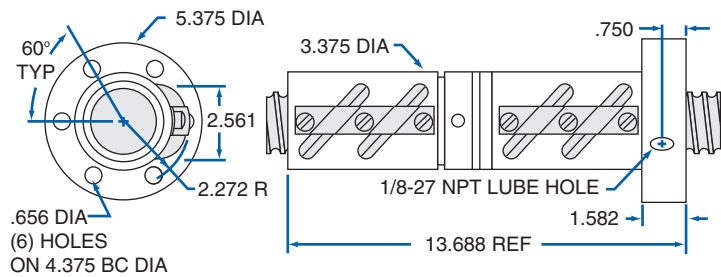

* No Integral Flange - Threaded End same as SBN7516/SBN4000

Flange - FLG7574

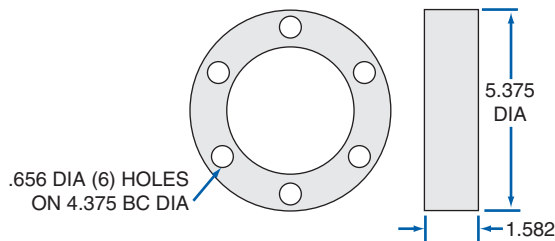

Felt Wiper Kit - WKF3890

2 wipers and 2 retainers

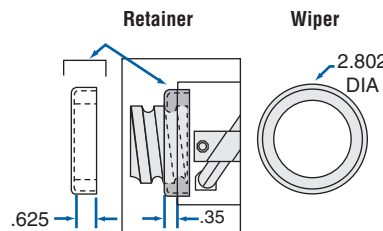

Brush Wiper Kit - WKB2659

2 wipers and 2 retainer rings

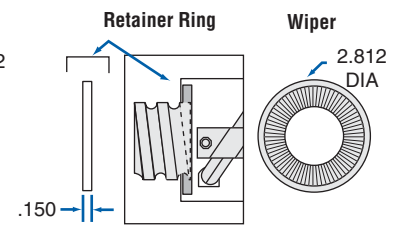

2250-0500 XPR and SGT

LEAD ACCURACY: XPR ± 0.001 in./ft. SGT ± 0.0005 in./ft.

Single Start

- 2.250** Ball Circle Diameter
- 0.500** Lead
- 1.850** Root Diameter
- 0.375** Nominal Ball Diameter
- 10.8** Screw Weight (lbs./ft.)

Standard Screw Lengths	PART NUMBERS	
	XPR RH	SGT RH
6 FT.	XPR22550R72	GT22550R72
10 FT.	—	GT22550R120
12 FT.	XPR22550R144	—

XPR custom cut lengths available up to 12',
SGT custom cut lengths available up to 10', contact Customer Service.

INCH BALL SCREW AND NUT TECHNICAL DATA

PRN Preloaded Ball Nut with Wipers		99 bearing balls per circuit - 198 total per nut
PRODUCT SPECIFICATIONS	RH	
Dynamic Load (lbs.)	20,106	
Static Load (lbs.)	108,325	
Torque to Raise 1 lb. (in.-lb.)	.088	
Spring Rate x 10 ⁶ (lb./in.)	7.25	
Nut Weight (lbs.)	10.5	
Ball Nut Number	PRN10089	
Flange Part Number	—	
Wiper Type	ELASTOMER	

SSN Preloaded Flanged Ball Nut with Wipers		99 bearing balls per circuit - 198 total per nut
PRODUCT SPECIFICATIONS	RH	
Dynamic Load (lbs.)	20,106	
Static Load (lbs.)	108,325	
Torque to Raise 1 lb. (in.-lb.)	.088	
Spring Rate x 10 ⁶ (lb./in.)	7.25	
Nut Weight (lbs.)	15.2	
Ball Nut Number	SSN0402	
Flange	INTEGRAL	
Wiper Type	ELASTOMER	

SAG Adjustable Preload Flanged Ball Nut		99 bearing balls per circuit - 396 total per nut
PRODUCT SPECIFICATIONS	RH	
Dynamic Load (lbs.)	30,000	
Static Load (lbs.)	142,660	
Torque to Raise 1 lb. (in.-lb.)	.088	
Preload (lbs.)	2,130-6,390	
Nut Weight (lbs.)	24.2	
Ball Nut Number	SAG0706	
Flange	INCLUDED	
Wiper Type	BRUSH	

BALL SCREW ASSEMBLIES

These assemblies are shipped with screw, nut, flange, and bearing supports.

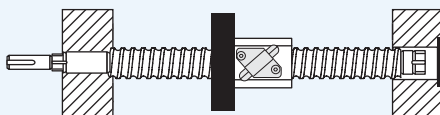

See page 145 for complete product details.

EZZE-MOUNT™ END BEARING SUPPORTS

A convenient solution for mounting ball screw assemblies.

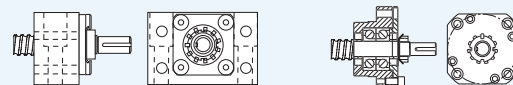

Single or Double Bearing Universal Mount

Single or Double Bearing Flange Mount

See page 214 for complete product details.

Standard Screw Lengths	PART NUMBERS
	RH
4 FT.	SRT4556
8 FT.	SRT4557
12 FT.	SRT4558
16 FT.	SRT0441
20 FT.	SRT0604

Custom cut lengths available up to 24'. For longer lengths contact Customer Service.

2250-1000 SRT

LEAD ACCURACY: ±0.004 in./ft.

Double Start

- 2.250** Ball Circle Diameter
- 1.000** Lead
- 1.850** Root Diameter
- 0.375** Nominal Ball Diameter
- 10.9** Screw Weight (lbs./ft.)

SBN Double Circuit Ball Nut

83 bearing balls per circuit - 166 total per nut

PRODUCT SPECIFICATIONS	RH
Dynamic Load (lbs.)	26,538
Static Load (lbs.)	142,660
Torque to Raise 1 lb. (in.-lb.)	.177
Nut Weight (lbs.)	9.0
Ball Nut Number	SBN4555
Flange Part Number	FLG7574
Wiper Kit Part Number	WKB2659/WKF0457

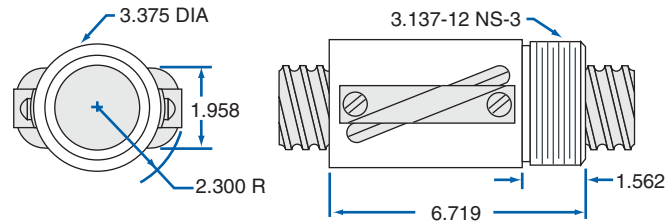

SAR Preloaded Integral Flange Ball Nut

83 bearing balls per circuit - 332 total per nut

PRODUCT SPECIFICATIONS	RH
Dynamic Load (lbs.)	26,538
Static Load (lbs.)	142,660
Torque to Raise 1 lb. (in.-lb.)	.177
Nut Weight (lbs.)	24.2
Preload Range (lbs.)	2,650-7,960
Ball Nut Number	SAR2210
Flange	INCLUDED
Wiper Type	BRUSH

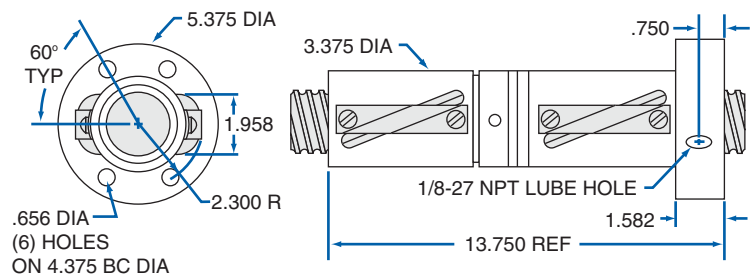

Flange - FLG7574

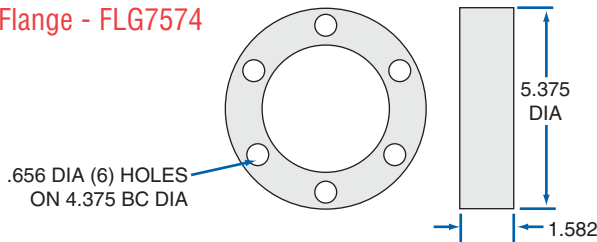

Felt Wiper Kit - WKF0457

2 wipers and 2 retainers

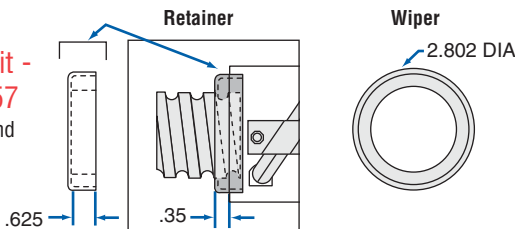

Brush Wiper Kit - WKB2659

2 wipers and 2 retainer rings

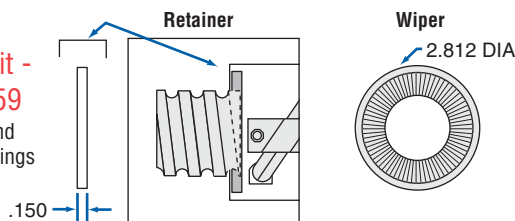

BALL SCREW ASSEMBLIES

These assemblies are shipped with screw, nut, flange, and bearing supports.

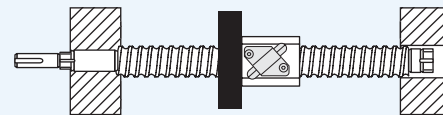

See page 145 for complete product details.

EZZE-MOUNT™ END BEARING SUPPORTS

A convenient solution for mounting ball screw assemblies.

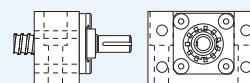

Single or Double Bearing Universal Mount

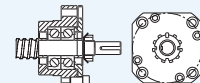

Single or Double Bearing Flange Mount

See page 214 for complete product details.

2500-0250 SRT & SGT

LEAD ACCURACY: ±0.004 in./ft.

Single Start

- 2.500** Ball Circle Diameter
- 0.250** Lead
- 2.320** Root Diameter-SRT
- 2.333** Root Diameter-SGT
- 0.156** Nominal Ball Diameter
- 15.45** Screw Weight (lbs./ft.)

Standard Screw Lengths	PART NUMBERS		
	SRT - RH	SRT - LH	SGT - RH
4 FT.	SRT3255	SRT0400	—
6 FT.	—	—	GT25025R72
8 FT.	SRT3256	SRT0401	—
12 FT.	SRT3257	SRT0402	GT25025R144
16 FT.	SRT0442	SRT0403	—
20 FT.	SRT0606	SRT0404	—

Custom cut lengths available up to 24'. For longer lengths contact customer service.

INCH BALL SCREW AND NUT TECHNICAL DATA

SBN Triple Circuit Ball Nut

158 bearing balls per circuit - 474 total per nut

PRODUCT SPECIFICATIONS	RH	LH
Dynamic Load (lbs.)	6,315	6,315
Static Load (lbs.)	81,938	81,938
Torque to Raise 1 lb. (in.-lb.)	.044	.044
Nut Weight (lbs.)	4.7	4.7
Ball Nut Number	SBN3243	SBN10329
Flange Part Number	FLG3263	FLG3263
Wiper Kit Part Number	WKB3324	WKB3324

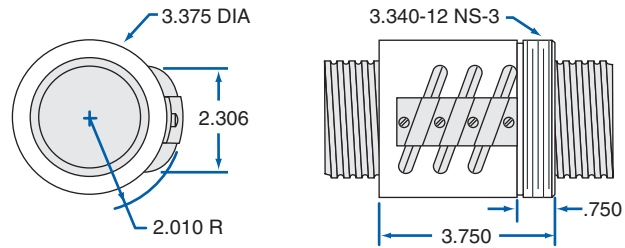

SAR Preloaded Integral Flange Ball Nut

SAG Adjustable Preload Integral Flange Ball Nut

158 bearing balls per circuit - 948 total per nut

PRODUCT SPECIFICATIONS	SAR RH	SAG RH
Dynamic Load (lbs.)	6,315	8,945
Static Load (lbs.)	81,938	93,165
Torque to Raise 1 lb. (in.-lb.)	.044	.044
Nut Weight (lbs.)	9.9	631-1,895
Preload Range (lbs.)	631-1,895	9.9
Ball Nut Number	SAR3242	SAG0707
Flange	INTEGRAL	INTEGRAL
Wiper Type	BRUSH	BRUSH

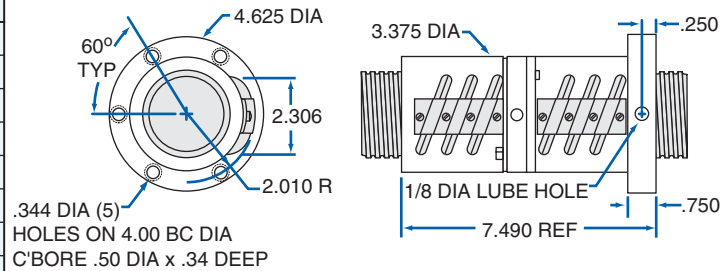

SSN Integral Preload Integral Flange Ball Nut

158 bearing balls per circuit - 948 total per nut

PRODUCT SPECIFICATIONS	RH
Dynamic Load (lbs.)	8,945
Static Load (lbs.)	93,165
Torque to Raise 1 lb. (in.-lb.)	.044
Spring Rate x 10 ⁶ (lb./in.)	8.00
Nut Weight (lbs.)	9.0
Ball Nut Number	SSN0403
Flange	INTEGRAL
Wiper Type	ELASTOMER

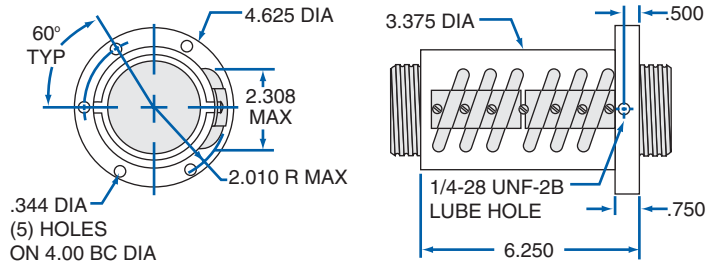

Flange - FLG3263

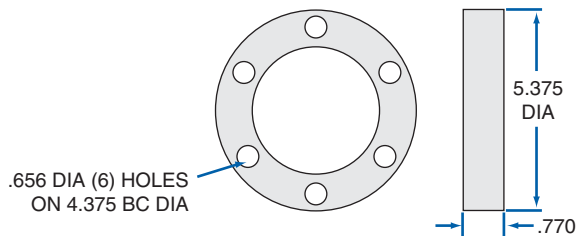

Brush Wiper Kit - WKB3324

2 wipers and 2 retainers

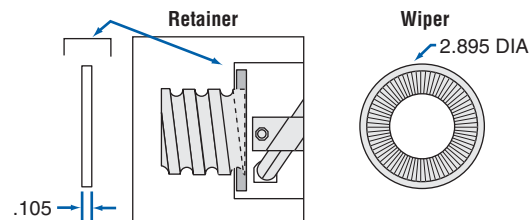

Standard Screw Lengths	PART NUMBERS
	RH
4 FT.	SRT0405
8 FT.	SRT0406
12 FT.	SRT0407
16 FT.	SRT0408
20 FT.	SRT0409

Custom cut lengths available up to 24'. For longer lengths contact Customer Service.

2500-0500 SRT

LEAD ACCURACY: ±0.004 in./ft.

Single Start

- 2.500** Ball Circle Diameter
- 0.500** Lead
- 2.116** Root Diameter
- 0.375** Nominal Ball Diameter
- 14.0** Screw Weight (lbs./ft.)

SBN Double Circuit Ball Nut

88 bearing balls per circuit - 176 total per nut

PRODUCT SPECIFICATIONS	RH
Dynamic Load (lbs.)	21,200
Static Load (lbs.)	186,000
Torque to Raise 1 lb. (in.-lb.)	.088
Nut Weight (lbs.)	12.7
Ball Nut Number	SBN10316
Flange Part Number	70600
Wiper Kit Part Number	—

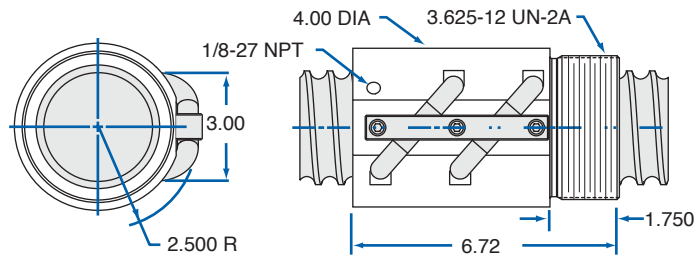

Flange - 70600

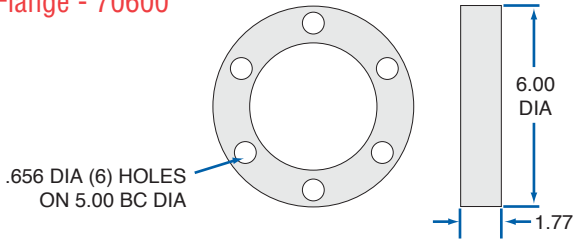

BALL SCREW ASSEMBLIES

These assemblies are shipped with screw, nut, flange, and bearing supports.

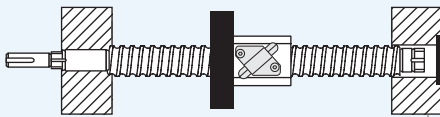

See page 145 for complete product details.

EZZE-MOUNT™ END BEARING SUPPORTS

A convenient solution for mounting ball screw assemblies.

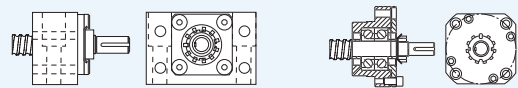

Single or Double Bearing
Universal Mount

Single or Double Bearing
Flange Mount

See page 214 for complete product details.

END MACHINING

Machining for Nook standard ends or custom requirement available.

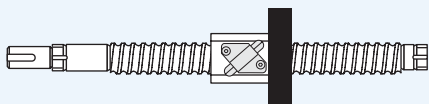

See page 212 for complete product details.

LUBRICANT

Prolong ball screw and nut performance with this special lubricant.



E-900 12oz. Spray or 32oz. Liquid
See page 95 for complete product details.

3000-0660 SRT

LEAD ACCURACY: ±0.008 in./ft.

Single Start

- 3.000** Ball Circle Diameter
- 0.660** Lead
- 2.480** Root Diameter
- 0.500** Nominal Ball Diameter
- 19.6** Screw Weight (lbs./ft.)

Standard Screw Lengths	PART NUMBERS	
	RH	LH
4 FT.	SRT5073	SRT0410
8 FT.	SRT5080	SRT0411
12 FT.	SRT5087	SRT0412
16 FT.	SRT0433	SRT0413
20 FT.	SRT0607	SRT0414

Custom cut lengths available up to 24'. For longer lengths contact customer service.

INCH BALL SCREW AND NUT TECHNICAL DATA

SBN Triple Circuit Ball Nut with Load-Lock Feature

57 bearing balls per circuit - 171 total per nut

PRODUCT SPECIFICATIONS	RH	RH w/safety thread	LH
Dynamic Load (lbs.)	44,316	44,316	44,316
Static Load (lbs.)	271,733	271,733	271,733
Torque to Raise 1 lb. (in.-lb.)	.117	.117	.117
Nut Weight (lbs.)	26	26	26
Ball Nut Number	SBN7519	SBN10202	SBN10257
Flange Part Number	FLG7575	FLG7575	FLG7575
Wiper Kit Part Number	WKB2661/ WKF3891	WKB2661/ WKF3891	WKB2661

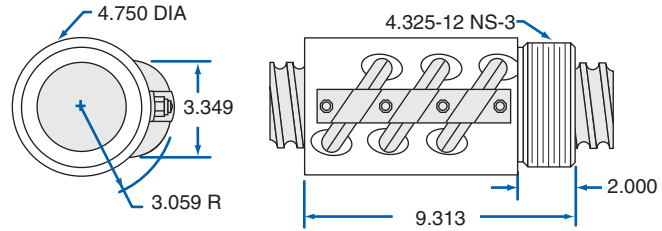

SBN Keyed Triple Circuit Ball Nut

57 bearing balls per circuit - 171 total per nut

PRODUCT SPECIFICATIONS	RH
Dynamic Load (lbs.)	44,316
Static Load (lbs.)	271,733
Torque to Raise 1 lb. (in.-lb.)	.117
Nut Weight (lbs.)	22
Ball Nut Number	SBN8347
Flange Part Number	—
Wiper Kit Part Number	—

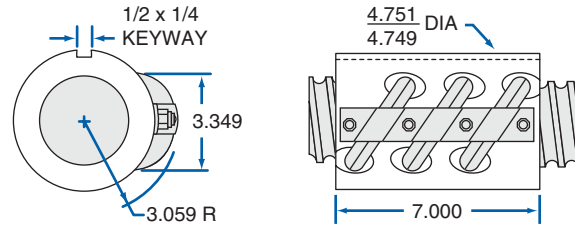

SAR Preloaded Flanged Ball Nut with Wipers or SEL Preloaded Ball Nut

57 bearing balls per circuit - 342 total per nut

PRODUCT SPECIFICATIONS	SAR RH	SEL RH*	SEL LH*
Dynamic Load (lbs.)	44,316	44,316	44,316
Static Load (lbs.)	271,733	271,733	271,733
Torque to Raise 1 lb. (in.-lb.)	.117	.117	.117
Nut Weight (lbs.)	67.5	51.5	51.5
Preload Range (lbs.)	4,430-13,295	4,430-13,295	4,430-13,295
Ball Nut Number	SAR3045	SEL10085	SEL10330
Flange Part Number	INCLUDED	FLG7575	FLG7575
Wiper Type/Kit Part Number	BRUSH	WKB2661/WKF3891	WKB2661

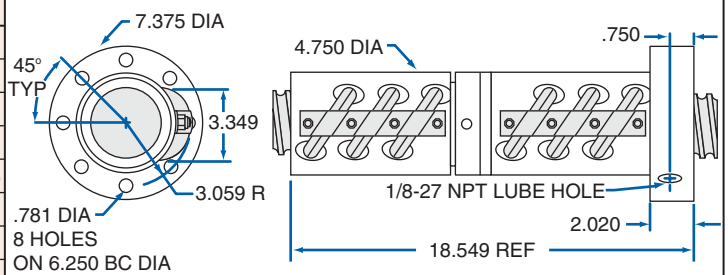

* No Integral Flange - Threaded End same as SBN4986

Flange - FLG7575

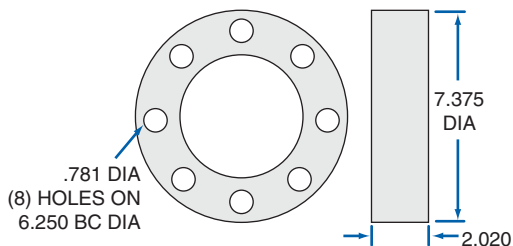

Felt Wiper Kit - WKF3891

2 wipers and 2 retainers

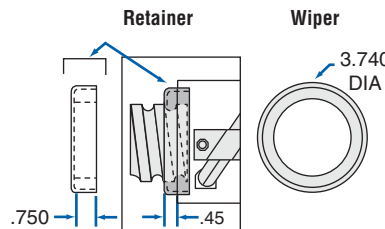

Brush Wiper Kit - WKB2661

2 wipers and 2 retainer rings

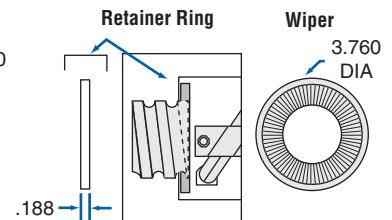

Standard Screw Lengths	PART NUMBERS
	RH
4 FT.	SRT4987
8 FT.	SRT4988
12 FT.	SRT4989
16 FT.	SRT0444
20 FT.	SRT0609

Custom cut lengths available up to 24'. For longer lengths contact Customer Service.

3000-1500 SRT

LEAD ACCURACY: ±0.008 in./ft.

Double Start

- 3.000** Ball Circle Diameter
- 1.500** Lead
- 2.480** Root Diameter
- 0.500** Nominal Ball Diameter
- 19.3** Screw Weight (lbs./ft.)

SBN Double Circuit Ball Nut

83 bearing balls per circuit - 166 total per nut

PRODUCT SPECIFICATIONS	RH
Dynamic Load (lbs.)	53,646
Static Load (lbs.)	253,617
Torque to Raise 1 lb. (in.-lb.)	.266
Nut Weight (lbs.)	27.2
Ball Nut Number	SBN4986
Flange Part Number	FLG7575
Wiper Kit Part Number	WKB2661/WKF0458

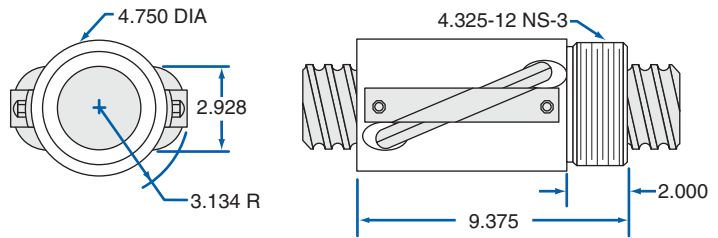

SAR Adjustable Preload Flanged Ball Nut with Wipers

83 bearing balls per circuit - 332 total per nut

PRODUCT SPECIFICATIONS	RH
Dynamic Load (lbs.)	53,646
Static Load (lbs.)	213,617
Torque to Raise 1 lb. (in.-lb.)	.266
Nut Weight (lbs.)	67.5
Preload Range (lbs.)	5,365-16,904
Ball Nut Number	SAR3015
Flange	INCLUDED
Wiper Type	BRUSH

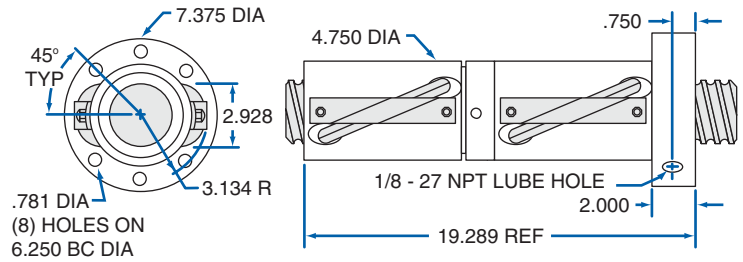

Flange - FLG7575

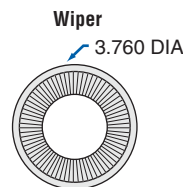
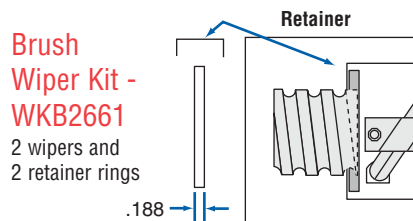
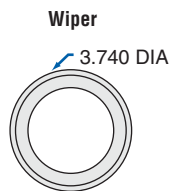
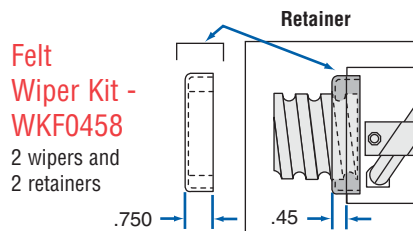
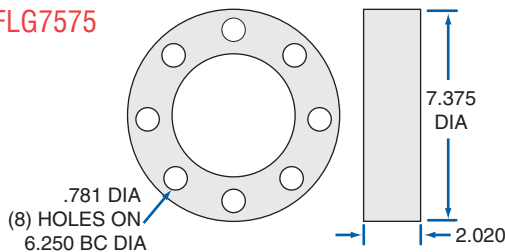

BALL SCREW ASSEMBLIES

These assemblies are shipped with screw, nut, flange, and bearing supports.

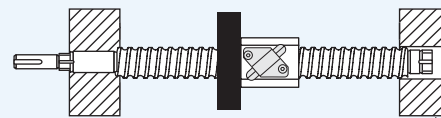

See page 145 for complete product details.

EZZE-MOUNT™ END BEARING SUPPORTS

A convenient solution for mounting ball screw assemblies.

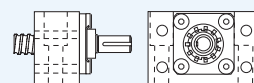

Single or Double Bearing
Universal Mount

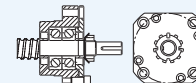

Single or Double Bearing
Flange Mount

See page 214 for complete product details.

4000-1000 SRT

LEAD ACCURACY: ±0.008 in./ft.

Single Start

- 4.000** Ball Circle Diameter
- 1.000** Lead
- 3.338** Root Diameter
- 0.625** Nominal Ball Diameter
- 34.4** Screw Weight (lbs./ft.)

Standard Screw Lengths	PART NUMBERS
	RH
4 FT.	SRT3259
8 FT.	SRT3260
12 FT.	SRT3261
16 FT.	SRT0624
20 FT.	SRT3262

Custom cut lengths available up to 24'. For longer lengths contact Customer Service.

INCH BALL SCREW AND NUT TECHNICAL DATA

SBN Triple Circuit Ball Nut with Load-Lock Feature

61 bearing balls per circuit - 183 total per nut

PRODUCT SPECIFICATIONS	RH
Dynamic Load (lbs.)	85,758
Static Load (lbs.)	476,970
Torque to Raise 1 lb. (in.-lb.)	.177
Nut Weight (lbs.)	53.5
Ball Nut Number	SBN3258
Flange Part Number	FLG3307
Wiper Kit Part Number	WKB3006/WKF4057

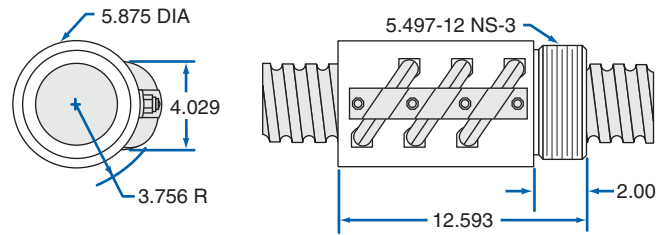

SAR Adjustable Preload Flanged Ball Nut with Wipers

61 bearing balls per circuit - 366 total per nut

PRODUCT SPECIFICATIONS	RH
Dynamic Load (lbs.)	85,758
Static Load (lbs.)	476,970
Torque to Raise 1 lb. (in.-lb.)	.177
Nut Weight (lbs.)	167.5
Preload Range (lbs.)	8,575-25,725
Ball Nut Number	SAR4625
Flange	INCLUDED
Wiper Type	BRUSH

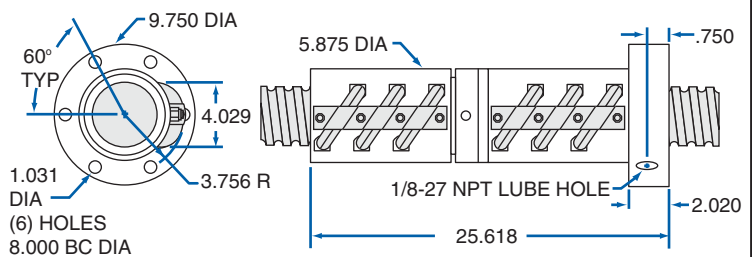

Flange - FLG3307

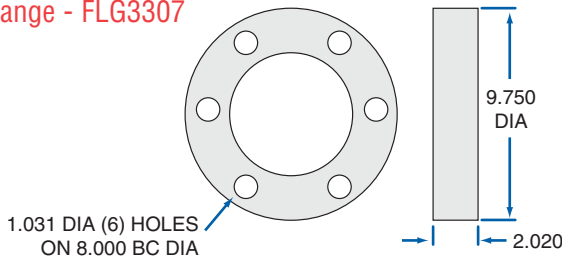

Felt Wiper Kit - WKF0457

2 wipers and
2 retainers

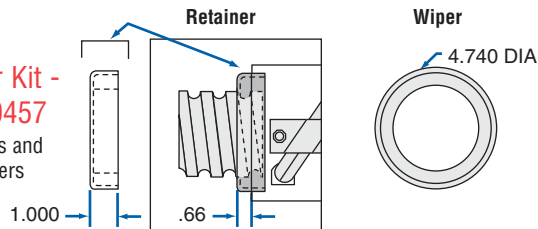

Brush Wiper Kit - WKB3306

2 wipers and
2 retainer rings

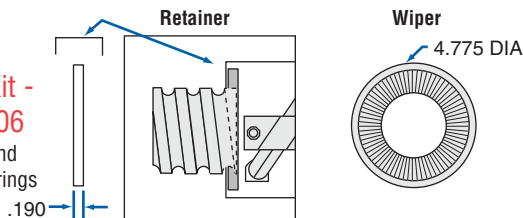

END MACHINING

Machining for Nook standard ends or custom requirement available.

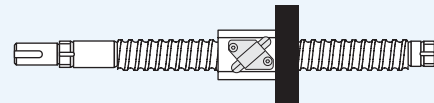

See page 212 for complete product details.

LUBRICANT

Prolong ball screw and nut performance with this special lubricant.

E-900 12oz. Spray or 32oz. Liquid
See page 95 for complete product details.



Standard Screw Lengths	RH
	NO STANDARD LENGTHS, ALL LENGTHS WILL BE QUOTED PER DRAWING

6000-1000 SRT

LEAD ACCURACY: ±0.002 in./ft.

Single Start

- 6.000** Ball Circle Diameter
- 1.000** Lead
- 5.232** Root Diameter
- 1.514** Nominal Ball Diameter
- 34.4** Screw Weight (lbs./ft.)

SBN Integral Return Ball Nut		25 bearing balls per circuit - 200 total per nut
PRODUCT SPECIFICATIONS	RH	
Dynamic Load (lbs.)	115,507	
Static Load (lbs.)	443,548	
Torque to Raise 1 lb. (in.-lb.)	.177	
Nut Weight (lbs.)	170	
Ball Nut Number	SBN10438	
Flange Part Number	FLG10437	
Wiper Kit Part Number	WKP10441	

SBN Internal Return Ball Nut with Integral Flange		25 bearing balls per circuit - 200 total per nut
PRODUCT SPECIFICATIONS	RH	
Dynamic Load (lbs.)	115,507	
Static Load (lbs.)	443,548	
Torque to Raise 1 lb. (in.-lb.)	.177	
Nut Weight (lbs.)	225	
Ball Nut Number	SBN10442	
Flange	INTEGRAL	
Wiper Type	PLASTIC	

Flange - FLG10437

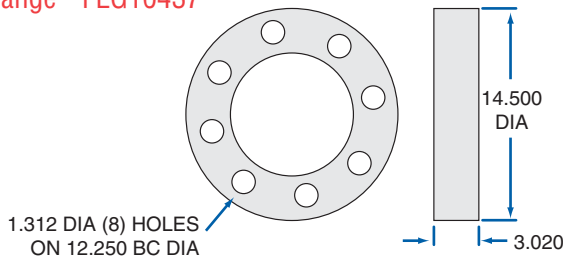

INCH BALL SCREW AND NUT TECHNICAL DATA

INCH QUICK REFERENCE: SRT, XPR AND SGT SCREWS AND NUTS

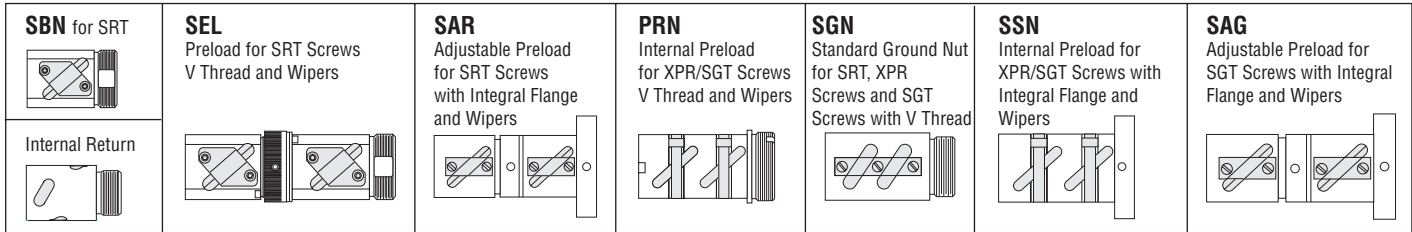

INCH BALL SCREW AND NUT TECHNICAL DATA

SCREW SELECTION											NUT SELECTION											Page Ref	
NOMINAL DIA-LEAD	Root Dia.	SRT 0.004"/ft			XPR 0.001"/ft		SGT 0.0005"/ft		LOAD RATING*		Torque To Raise 1lb. (in-lb)	SBN		SEL		SAR	PRN		SGN	SSN			SAG
		ALLOY RH	SS LH	SS RH	RH	LH	RH	LH	Static lbs.	Dynamic lbs.		ALLOY RH	SS LH	RH	LH		RH	LH		RH	LH		
0.375-0.125	0.300	●	●	●					1,415	136	0.022	●	●	●									99
0.500-0.200	0.405	●							7,071	973	0.035	●			●								100
0.500-0.500	0.360	●		●					4,131	786	0.088	●											101
0.631-0.200	0.500	●	●	●	●	●	●	●	6,384	815	0.035	●	●	●	●	●		●		●	●		102
0.631-0.500	0.500	●							5,565	960	0.088	●			●								106
0.631-1.000	1.000	●							2,580	620	0.177	●											106
0.750-0.200	0.602	●				●		●	8,569	1,100	0.035	●			●			●			●		107
0.750-0.500	0.602	●							17,425	2,723	0.088	●			●								109
0.875-0.200	0.735	●				●		●	18,063	1,942	0.035	●				●	●			●		●	110
1.000-0.200	0.865							●	13,073	1,565	0.035										●	●	112
1.000-0.250	0.820	●	●	●	●	●		●	13,913	1,612	0.044	●	●	●	●	●	●	●	●	●	●	●	113
1.000-0.500	0.820	●							25,250	2,142	0.088	●			●								116
1.000-1.000	0.820	●							11,925	2,370	0.177	●			●								117
1.150-0.200	1.015	●	●		●		●		28,180	3,894	0.035	●	●		●	●	●	●		●		●	118
1.171-0.413	0.870	●							22,917	3,894	0.073	●											120
1.250-0.200	1.115	●	●		●	●	●		34,688	3,336	0.035	●	●		●	●		●	●		●	●	121
1.250-0.500	1.050	●				●		●	17,235	2,745	0.088	●			●						●		123
1.500-0.200	1.349							●	45,073	4,745	0.035										●		125
1.500-0.250	1.320	●	●		●		●		44,030	4,198	0.044	●	●		●	●	●	●		●		●	126
1.500-0.473	1.140	●							57,770	10,050	0.084	●											128
1.500-0.500	1.174	●				●		●	97,696	12,320	0.088	●			●						●		129
1.500-1.000	1.140	●	●						34,662	7,560	0.177	●	●		●	●					●	●	131
1.500-1.875	1.188	●							28,895	7,242	0.332	●			●								132
1.750-0.250	1.613							●	32,500	5,600	0.044										●		133
2.000-0.200	1.849							●	65,903	6,181	0.035										●	●	134
2.000-0.400	1.742							●	72,360	12,830	0.070										●		134
2.250-0.500	1.850	●	●		●		●		142,660	21,306	0.088	●	●		●	●	●				●	●	135
2.250-1.000	1.850	●							142,660	26,538	0.177	●			●								137
2.500-0.250	2.320	●	●					●	81,938	6,315	0.044	●	●		●						●	●	138
2.500-0.500	2.116	●							186,000	21,200	0.088	●											139
3.000-0.660	2.480	●	●						271,733	44,316	0.117	●	●		●		●						140
3.000-1.500	2.480	●							253,617	53,646	0.266	●					●						141
4.000-1.000	3.338	●							253,167	53,646	0.177	●					●						142

* Load rating listed is for SBN nut, except for 1.000-0.200, 2.000-0.200, 2.000-0.400 and 2.000-0.400 which list the SSN Load rating. Refer to the screw page for specific nut style load ratings.

CONVENIENCE AND MODULARITY

PowerTrac™ modular assemblies are pre-engineered and feature an SRT ball screw, steel mounting flange with an SBN ball nut, one single and one double bearing EZZE-MOUNT™ support. One end of the mounted screw is provided with a drive shaft and keyway for coupling the assembly to a drive mechanism.



Use the reference number below to select the assembly that meets the design requirement. See page 214-218 for EZZE-MOUNT™ information and page 212-213 for End Machining information.

EXAMPLE:

0631-0200 SRT RH / EK / CN / 24.5 / SBN10325 / FS

Is a 0631-0200 SRT right hand alloy steel rolled Screw with an SBN10325 ball nut Universal Double and a Universal Single EZZE-MOUNT™ overall Length of 24.50".

Note: Ball nut direction must be specified at the time of order.

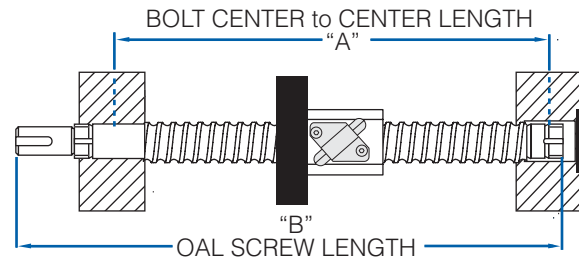

NOTE: "A" & "B" Dimensions reflect a 1/2" over travel at each end.

SCREW DIA.	LEAD	BOLT CENTER "A"	O.A.L. "B"	REFERENCE NUMBER	Page
0375-0125	0.125	3.00" + Travel	4.78" + Travel	0375-0125 SRT RH / EK / CN / "B" / SBN9574 / FS	99
0500-0200	0.200	4.71" + Travel	7.16" + Travel	0500-0200 SRT RH / EK / CN / "B" / SBN10094 / FS	100
0500-0500	0.500	4.03" + Travel	5.90" + Travel	0500-0500 SRT RH / EK / CN / "B" / SBN9582 / FS	101
0631-0200	0.200	4.09" + Travel	7.14" + Travel	0631-0200 SRT RH / EK / CN / "B" / SBN10325 / FS	102
0631-0500	0.500	4.09" + Travel	7.14" + Travel	0631-0500 SRT RH / EK / CN / "B" / SBN10113 / FS	106
0750-0200	0.200	4.25" + Travel	7.23" + Travel	0750-0200 SRT RH / EK / CN / "B" / SBN7201 / FS	107
0750-0500	0.500	5.31" + Travel	8.28" + Travel	0750-0500 SRT RH / EK / CN / "B" / SBN7500 / FS	109
0875-0200	0.200	5.38" + Travel	8.65" + Travel	0875-0200 SRT RH / EK / CN / "B" / SBN8277 / FS	110
1000-0250	0.250	5.08" + Travel	9.00" + Travel	1000-0250 SRT RH / EK / CN / "B" / SBN7508 / FS	113
1000-0500	0.500	5.85" + Travel	9.77" + Travel	1000-0500 SRT RH / EK / CN / "B" / SBN1050 / FS	116
1000-1000	1.000	5.72" + Travel	9.64" + Travel	1000-1000 SRT RH / EK / CN / "B" / SBN7509 / FS	117
1150-0200	0.200	5.44" + Travel	9.59" + Travel	1150-0200 SRT RH / EK / CN / "B" / SBN1566 / FS	118
1250-0200	0.200	6.23" + Travel	10.38" + Travel	1250-0200 SRT RH / EK / CN / "B" / SBN10187 / FS	121
1250-0500	0.500	6.52" + Travel	10.67" + Travel	1250-0500 SRT RH / EK / CN / "B" / SBN10104 / FS	123
1500-0250	0.250	5.81" + Travel	10.41" + Travel	1500-0250 SRT RH / EK / CN / "B" / SBN9587 / FS	126
1500-0473	0.413	7.25" + Travel	11.40" + Travel	1500-0473SRT RH / EK / CN / "B" / SBN7513 / FS	128
1500-0500	0.500	8.53" + Travel	12.68" + Travel	1500-0500 SRT RH / EK / CN / "B" / SBN1550 / FS	129
1500-1000	1.000	6.57" + Travel	10.72" + Travel	1500-1000 SRT RH / EK / CN / "B" / SBN8280 / FS	131
1500-1875	1.875	7.94" + Travel	12.54" + Travel	1500-1875 SRT RH / EK / CN / "B" / SBN7654 / FS	132



CONVENIENCE AND MODULARITY

PowerTrac™ modular assemblies are pre-engineered and feature an SRT ball screw, steel mounting flange with an SBN ball nut, one single and one double bearing EZZE-MOUNT™ support with motor mount. One end of the mounted screw is provided with a drive shaft and keyway for coupling the motor mount assembly.

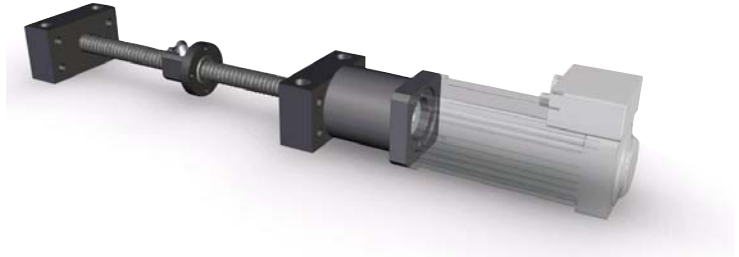

Use the reference number below to select the assembly that meets the design requirement. See page 214-218 for EZZE-MOUNT™ information and page 212-213 for End Machining information.

EXAMPLE:

0631-0200 SRT RH / U2 / CN / 24.5 / SBN10325 / FS

Is a 0631-0200 SRT right hand alloy steel rolled Screw with an SBN0827 ball nut EZM-3012-23 Universal Double Bearing Support with Motor Mount and a Universal Single EZZE-MOUNT™ overall Length of 24.50".

Note: Ball nut direction must be specified at the time of order.

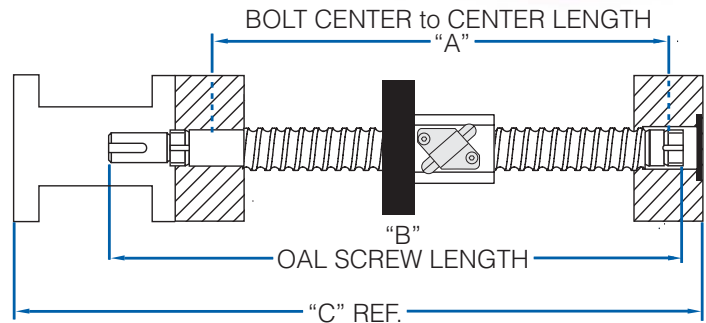

NOTE: "A" & "B" Dimensions reflect a 1/2" over travel at each end.

PRECISION BALL SCREW ASSEMBLY TECHNICAL INTRODUCTION

SCREW DIA.	LEAD	ADD MEASUREMENT BELOW + TRAVEL			REFERENCE NUMBER	MOTOR MOUNT	PAGE
		BOLT CENTER "A"	O.A.L "B"	"C" REF.			
0500-0200	0.200	4.71"	7.16"	8.88"	0500-0200 SRT RH / U2 / CN / "B" / SBN10094 / FS	EZM-3010-23	100
0500-0500	0.500	4.03"	5.90"	7.44"	0500-0500 SRT RH / U1 / CN / "B" / SBN9582 / FS	EZM-1008-17	101
0631-0200	0.200	4.09"	7.14"	8.57"	0631-0200 SRT RH / U2 / CN / "B" / SBN10325 / FS	EZM-3012-23	102
0631-0500	0.500	4.09"	7.14"	8.57"	0631-0500 SRT RH / U2 / CN / "B" / SBN10113 / FS	EZM-3012-23	106
0750-0200	0.200	4.25"	7.23"	8.95"	0750-0200 SRT RH / U2 / CN / "B" / SBN7201 / FS	EZM-3015-23	107
0750-0500	0.500	5.31"	8.28"	10.00"	0750-0500 SRT RH / U2 / CN / "B" / SBN7500 / FS	EZM-3015-23	109
0875-0200	0.200	5.38"	8.65"	10.64"	0875-0200 SRT RH / U3 / CN / "B" / SBN8277 / FS	EZM-3017-34	110
1000-0250	0.250	5.08"	9.00"	11.04"	1000-0250 SRT RH / U3 / CN / "B" / SBN7508 / FS	EZM-2020-34	113
1000-0500	0.500	5.85"	9.77"	11.81"	1000-0500 SRT RH / U3 / CN / "B" / SBN1050 / FS	EZM-2020-34	116
1000-1000	1.000	5.72"	9.64"	11.68"	1000-1000 SRT RH / U3 / CN / "B" / SBN7509 / FS	EZM-2020-34	117
1150-0200	0.200	5.44"	9.59"	11.88"	1150-0200 SRT RH / U3 / CN / "B" / SBN1566 / FS	EZM-3025-34	118
1250-0200	0.200	6.23"	10.38"	12.67"	1250-0200 SRT RH / U3 / CN / "B" / SBN10187 / FS	EZM-3025-34	121
1250-0500	0.500	6.52"	10.67"	12.96"	1250-0500 SRT RH / U3 / CN / "B" / SBN10104 / FS	EZM-3025-34	123
1500-0250	0.250	5.81"	10.41"	12.79"	1500-0250 SRT RH / U3 / CN / "B" / SBN9587 / FS	EZM-2030-34	126
1500-0473	0.413	7.25"	11.40"	13.70"	1500-0473SRT RH / U3 / CN / "B" / SBN7513 / FS	EZM-3025-34	128
1500-0500	0.500	8.53"	12.68"	14.97"	1500-0500 SRT RH / U3 / CN / "B" / SBN1550 / FS	EZM-3025-34	129
1500-1000	1.000	6.57"	10.72"	13.01"	1500-1000 SRT RH / U3 / CN / "B" / SBN8280 / FS	EZM-3025-34	131
1500-1875	1.875	7.94"	12.54"	14.91"	1500-1875 SRT RH / U3 / CN / "B" / SBN7654 / FS	EZM-2030-34	132

CONVENIENCE AND MODULARITY

These PowerTrac™ modular assemblies are pre-engineered and feature a rolled ball screw, steel mounting flange with ball nut, one single and one double bearing EZZE-MOUNT™ support. Drive end of the mounted screw is provided with a HandWheel for manual operation.

Use the reference number below to select the assembly that meets the design requirement. See page 214-218 for EZZE-MOUNT™ information, page 212-213 for End Machining information and page 287 for HandWheel information.

EXAMPLE:

0631-0200 SRT RH / EQ / CN / 24.5 / SBN10325 / FS

Is a 0631-0200 SRT right hand alloy steel rolled screw with an SBN0827 ball nut Universal Double and Universal Single EZZE-MOUNT™ overall length of 24.50", with HandWheel 4" diameter.

Note: Ball nut direction must be specified at the time of order.

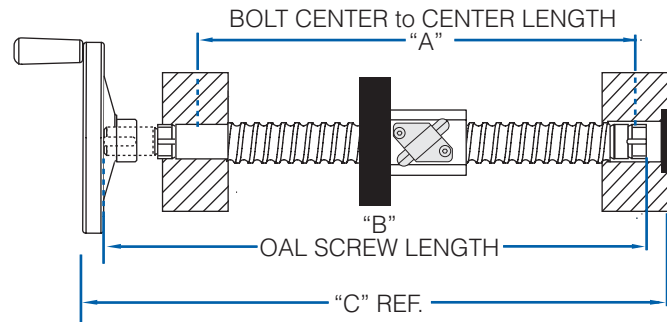

NOTE: "A" & "B" Dimensions reflect a 1/2" over travel at each end.

SCREW DIA.	LEAD	ADD MEASUREMENT BELOW + TRAVEL			REFERENCE NUMBER	HANDWHEEL		PAGE
		BOLT CENTER "A"	O.A.L "B"	"C" REF.		SIZE	PART NO.	
0631-0200	0.200	4.09"	7.14"	7.88"	0631-0200 SRT RH / EQ / CN / "B" / SBN10325 / FS	4"	HO43*	102
0631-0500	0.500	4.09"	7.14"	7.88"	0631-0500 SRT RH / EQ / CN / "B" / SBN10113 / FS	4"	HO43*	106
0750-0200	0.200	4.25"	7.23"	7.94"	0750-0200 SRT RH / EQ / CN / "B" / SBN7201 / FS	4"	HO44	107
0750-0500	0.500	5.31"	8.28"	8.99"	0750-0500 SRT RH / EQ / CN / "B" / SBN7500 / FS	4"	HO44	109
0875-0200	0.200	5.38"	8.65"	9.48"	0875-0200 SRT RH / EQ / CN / "B" / SBN8277 / FS	6"	HO64	110
1000-0250	0.250	5.08"	9.00"	9.86"	1000-0250 SRT RH / EQ / CN / "B" / SBN7508 / FS	6"	HO65**	113
1000-0500	0.500	5.85"	9.77"	10.63"	1000-0500 SRT RH / EQ / CN / "B" / SBN1050 / FS	6"	HO65**	116
1000-1000	1.000	5.72"	9.64"	10.50"	1000-1000 SRT RH / EQ / CN / "B" / SBN7509 / FS	6"	HO65**	117
1150-0200	0.200	5.44"	9.59"	10.64"	1150-0200 SRT RH / EQ / CN / "B" / SBN1566 / FS	8"	HO86	118
1250-0200	0.200	6.23"	10.38"	11.43"	1250-0200 SRT RH / EQ / CN / "B" / SBN10187 / FS	8"	HO86	121
1250-0500	0.500	6.52"	10.67"	11.72"	1250-0500 SRT RH / EQ / CN / "B" / SBN10104 / FS	8"	HO86	123
1500-0250	0.250	5.81"	10.41"	11.43"	1500-0250 SRT RH / EQ / CN / "B" / SBN9587 / FS	8"	HO88	126
1500-0473	0.413	7.25"	11.40"	12.46"	1500-0473SRT RH / EQ / CN / "B" / SBN7513 / FS	8"	HO86	128
1500-0500	0.500	8.53"	12.68"	13.73"	1500-0500 SRT RH / EQ / CN / "B" / SBN1550 / FS	8"	HO86	129
1500-1000	1.000	6.57"	10.72"	11.77"	1500-1000 SRT RH / EQ / CN / "B" / SBN8280 / FS	8"	HO86	131
1500-1875	1.875	7.94"	12.54"	13.55"	1500-1875 SRT RH / EQ / CN / "B" / SBN7654 / FS	8"	HO88	132

*Indicates modified Type III End Machining required.

**HO65 HandWheel has the same outer dimensions as HO64, but different bore.

Other combinations of screw assemblies and handwheels available upon request.



Twin-lead ball screws offer dual opposing motion using a single drive system. These one-piece high performance ball screws are made from high alloy steel that is black oxidized for protection. Twin-lead ball screw assemblies can be assembled with Nook PowerTrac™ ball nuts, flanges and EZZE-MOUNT™ (see page 214-218) bearing supports to form cost effective systems. Twin-lead ball screws can be used in molding machines, packaging equipment, food processing machinery, robotics, material handling equipment, tire manufacturing and assembly applications.



Twin-lead ball screws can be used in molding machines, packaging equipment, food processing machinery, robotics, material handling equipment, tire manufacturing and assembly applications.

- Lead accuracy of ± 0.004 "/foot is standard
- For a shorter unthreaded center section, contact Nook Industries customer service. 800-321-7800

Twin-Lead screws are stocked for quick delivery without machined ends in the sizes in the left chart below. To order a twin-lead cut to a custom length and/or with machined ends, select a size from the Twin-Lead Chart, determine OAL, LH and RH thread length, nut, flange and, if required, EZZE-MOUNT™ bearing support.

Consult the Twin-Lead Reference Number System on the next page to complete your part number.

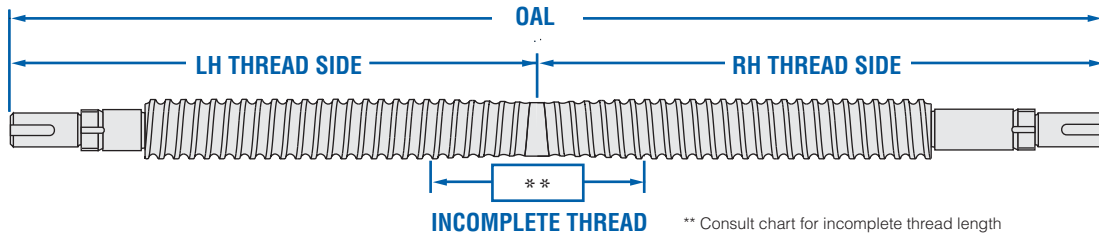

STOCKED SIZES WITHOUT END MACHINING

SCREW SIZE DIA-LEAD	ROOT DIA. (min)	MAX OVERALL LENGTH	MAX USEABLE LH & RH THREAD	INCOMPLETE OVERLAPPING THREAD LENGTH	PAGE
0375-0125	0.300	36	16.50	2.50	99
0631-0200	0.500	72	34.25	3.00	102
1000-0250	0.820	96	46.25	3.00	113
1150-0200	1.015	108	52.50	3.00	118
1250-0200	1.115	108	52.50	3.00	121
1500-0250	1.320	108	52.25	3.50	126
1500-1000	1.140	192	94.00	4.00	131

SIZES AVAILABLE ON ORDER

SCREW SIZE DIA-LEAD	ROOT DIA. (min)	MAX OVERALL LENGTH	MAX USEABLE LH & RH THREAD	INCOMPLETE OVERLAPPING THREAD LENGTH	PAGE
2000-0200†	1.849	140	69.00	2.00	134
2250-0500	1.850	192	93.50	5.00	135
2500-0250	2.320	192	94.00	4.00	138
3000-0660	2.480	192	93.50	5.00	140

Measurements in inches † SGT - Ground Screw Only

1000-0250 SRT TA / EK / 4N / 33.50 / 16.75 / 16.75 / SBN7535A / SBN7508A / FS

TWIN-LEAD BALL SCREW

Thread Form Codes

Part#	Dia. - Lead	Part#	Dia. - Lead
0375-0125	= 0.375-0.125	1500-1000	= 1.500-1.000
0631-0200	= 0.631-0.200	2000-0200	= 2.000-0.200
1000-0250	= 1.000-0.250	2250-0500	= 2.250-0.500
1150-0200	= 1.150-0.200	2500-0250	= 2.500-0.250
1250-0200	= 1.250-0.200	3000-0660	= 3.000-0.660
1500-0250	= 1.500-0.250		

PRECISION

SRT = Standard Rolled Thread ±0.004"/ft.
SGT = Precision Ground Thread ±0.0005"/ft.

NOTE: Not all precisions are available for all sizes.

MATERIAL

TA = Twin-Lead Alloy
TS = Twin-Lead Stainless Steel

NOTE: Not all materials are available for all sizes.

FIRST END CONFIGURATION

EZZE-MOUNT™ / End Machining

(see page 214 & 212)

- 1 = Type 1 3 = Type 3
- 2 = Type 2 4 = Type 4

- B** = Universal Double Bearing Support End Cap Facing Screw Thread
- C** = Universal Single Bearing Support
- D** = Flanged Single Bearing Support Flange Facing Screw Thread
- E** = Universal Double Bearing Support End Cap Facing Away From Screw Thread
- F** = Flanged Double Bearing Support Flange Facing Screw Thread
- G** = Flanged Single Bearing Support Flange Facing Away From Screw Thread
- H** = Flanged Double Bearing Support Flange Facing Away From Screw Thread
- U** = Universal Double Bearing Support with Motor Mount (see page 217)
- Y** = Flanged Double Bearing Support with Motor Mount (see page 218)

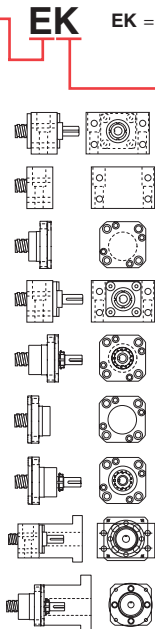

EK EK = Universal Double Bearing Support, with Keyway

Shaft Extension
(see page 188)

- K** = Shaft Extension with Keyway
- L** = Shaft Extension without Keyway
- Q** = HandWheel
- N** = No Shaft Extension

NOTE: Both Ends must be specified.

Single Bearing Supports are used in conjunction with Type 1N end machining.

Double Bearing Supports are used in conjunction with Type 3K, 3L, or 3N end machining.

00 = No End Machining (Screw will be cut to desired length).
XX = Custom Machining (Print or specified data must be provided).

SECOND END CONFIGURATION

Refer to the First End Configuration section above.

NOTE: Both Ends must be specified.

OVER - ALL - LENGTH (OAL)

Length in inches, 2 place decimal

LEFT HAND THREAD

Length in inches, 2 place decimal **NOTE:** See figure on page 148

RIGHT HAND THREAD

Length in inches, 2 place decimal **NOTE:** See figure on page 148

LEFT HAND BALL NUT

000000 = No Nut

RIGHT HAND BALL NUT

000000 = No Nut

NOTE: To Select the Nut Direction After Nut Part # Add
A = Nut Thread or Flange installed towards center of screw
B = Nut Thread or Flange installed towards end of screw

MODIFIER LIST

F and/or W Optional

F = Round Flange W = Wiper

S or M Required

S = Standard, no additional description required M = Modified, additional description required