



MODEL EZ2

BACKLASH FREE LINE SHAFTS

with split clamping hubs

Series
10 - 800

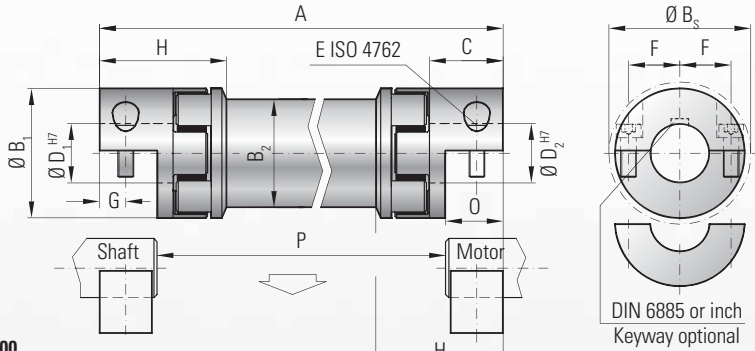

Series
2500 - 9500

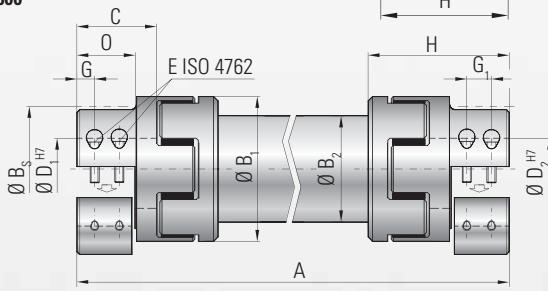

DIN 6885 or inch
Keyway optional

Properties:

- Radial mounting possible with split hubs
- Spans distances of up to 4 m (13.12 ft)
- No intermediate support bearing required
- Low moment of inertia
- Damps vibrations
- Press-fit design
- Backlash-free

Material:

Clamping hub: up to series 450 high strength aluminum, from series 800 and up steel.
Elastomer insert: precision molded, wear resistant, and thermally stable polymer.
Intermediate tube: precision machined aluminum tube; steel and composite tubes are also available.

Design:

Two coupling hubs are concentrically machined with concave driving jaws.
Elastomer inserts are available in type A or B.
The two coupling elements are connected with a precise and concentrically machined aluminum tube.

Speed:

Please advise the application speed when ordering or inquiring about EZ Line shafts.

Tolerance:

On the hub/shaft connection 0.01 to 0.05 mm

Ordering example

EZ2 / 20 / 1200 / A / 24 / 19 / XX

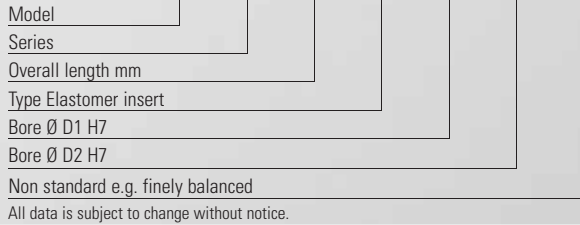

Model EZ 2

Model EZ 2	Series																			
	10		20		60		150		300		450		800		2500		4500		9500	
Type (Elastomer insert)	A	B	A	B	A	B	A	B	A	B	A	B	A	B	A	B	A	B	A	B
Rated torque (Nm) T_{KN}	12.5	16	17	21	60	75	160	200	325	405	530	660	950	1100	1950	2450	5000	6200	10000	12500
Max. torque* (Nm) T_{Kmax}	25	32	34	42	120	150	320	400	650	810	1060	1350	1900	2150	3900	4900	10000	12400	20000	25000
Overall length (mm) A	95 - 4000		130 - 4000		175 - 4000		200 - 4000		245 - 4000		280 - 4000		320 - 4000		460 - 4000		580 - 4000		710 - 4000	
Outer diameter hub (mm) B_1	32		42		56		66.5		82		102		136.5		160		225		290	
Outer diameter tube (mm) B_2	28		35		50		60		76		90		120		150		175		220	
Outer diameter with screwhead (mm) B_s	32		44.5		57		68		85		105		139		155		190		243	
Fit length (mm) C	20		25		40		47		55		65		79		85		110		140	
Inner diameter range from \emptyset to \emptyset H7 (mm) $D_{1/2}$	5 - 16		8 - 25		14 - 32		19 - 36		19 - 45		24 - 60		35 - 80		35 - 90		40 - 120		50 - 140	
Mounting screw ISO 4762 E	4 x M4		4 x M5		4 x M6		4 x M8		4 x M10		4 x M12		4 x M16		4 x M16		8 x M16		8 x M24	
Tightening torque of the mounting screw (Nm)	4		8		15		35		70		120		290		300		300		980	
Distance between centers (mm) F	10.5		15.5		21		24		29		38		50.5		57		72.5		90	
Distance (mm) G/G_1	7.5		8.5		15		17.5		20		25		30		36		24 / 34		30 / 48	
Mounting length (mm) O	16.6		18.6		32		37		42		52		62		67		85		105	
Moment of inertia per Hub half (10^{-3} kgm ²) J_1/J_2	0.01		0.02		0.15		0.21		1.02		2.3		17		30		140		450	
Inertia of tube per meter (10^{-3} kgm ²) J_3	0.075		0.183		0.66		1.18		2.48		10.6		38		360		750		1800	

* Max. transmittable torque of the clamping hub see table 3 (page 10)

Further information EK brochure page 14/15