

optional  
stainless  
steel

single-position  
multi-position  
load holding  
full disengagement



Pulley not included.

# MODEL SKN

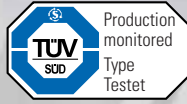

## BACKLASH FREE TORQUE LIMITER

with clamping hub

### Series 15 - 1500 Nm

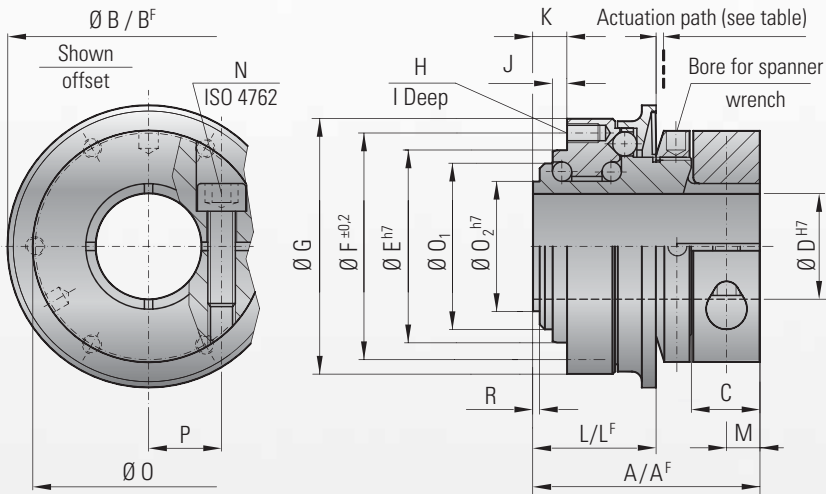

#### Material:

Torque limiting portion: high-strength, hardened steel  
Clamping hub: up to series 500, aluminium;  
from series 800, steel

#### Design:

With clamping hub and 1 radial screw ISO 4762  
Absolutely backlash free through frictional  
clamping connection

#### Temperature range:

-30 to +120° C

#### Service life:

Maintenance free when operated within the  
technical specifications

#### Fit tolerance:

Tolerance between hub and shaft 0.01 - 0.05 mm

**Optional sealed version for food-grade  
applications (see page 26)**

### Easy mounting and dismounting

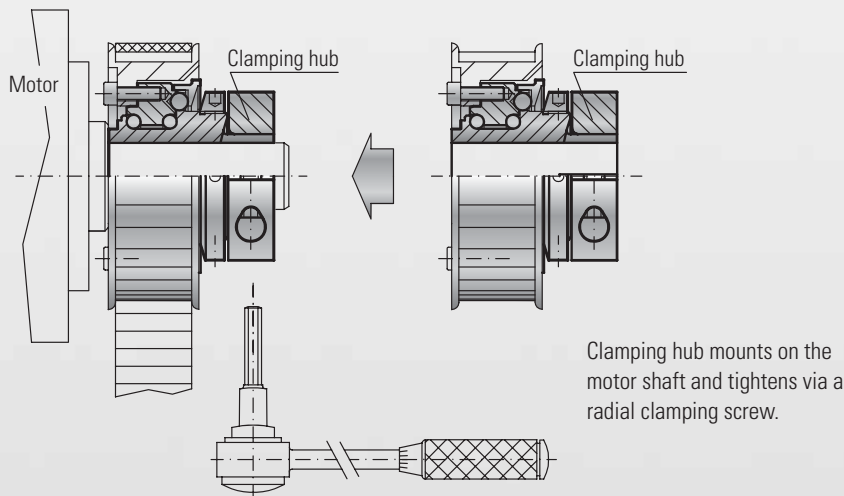

### Option ATEX

**Certified under the ATEX 95a directive for  
the hazardous zones 1/21 and 2/22**



### Ordering specifications

SKN / 60 / W / 20 / 60/25-80 / xx

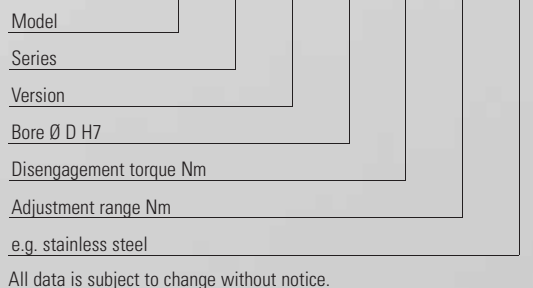

#### Possible versions

- W = Single-position engagement
- D = Multi-position engagement
- G = Load holding
- F = Full disengagement

**For the maximum permissible radial  
load capacity for all SKN models,  
see installation instructions on page 22/23.**



single-position  
multi-position  
load holding  
full disengagement

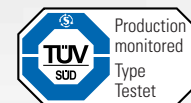

MODEL SKN			15	30	60	150	200	300	500	800	1500
Adjustment range available from - to (approx. values) (Nm)	$T_{KN}$		5-10 or 8-20	10-25 or 20-40	10-30 or 25-80	20-70 45-150 80-180	30-90 60-160 120-240	100-200 150-240 200-320	80-200 200-350 300-500	400-650 500-800 600-850	600-800 700-1200 1000-1800
Adjustment range available from - to (approx. values) ("F" Version) (Nm)	$T_{KN}$		7-15	8-20 or 16-30	10-30 20-40 30-60	20-60 40-80 80-150	80-140 or 130-200	120-180 or 160-300	50-150 100-300 250-500	200-400 or 450-800	1000-1250 or 1250-1500
Overall length (mm)	A		47	59	65	71	80	84	101	115	145
Overall length ("F" Version) (mm)	A <sup>F</sup>		47	59	65	73	83	87	107	126	154
Actuation ring Ø (mm)	B		55	65	73	92	99	120	135	152	174
Actuation ring Ø ("F" Version) (mm)	B <sup>F</sup>		62	70	83	98	117	132	155	177	187
Clamping fit length (mm)	C		13.5	16	20	23	26	26	30	35	46
Inner diameter from Ø to Ø H7 (mm)	D		12-22	14-25.4	16-32	19-40	24-44	30-56	35-60	40-62	50-72
Inner Diameter from Ø to Ø H7 with keyway (mm)	D		8-19	12-25.4	12-30	15-38	20-44	25-50	25-58	30-60	35-72
Pilot diameter h7 (mm)	E		40	47	55	68	75	82	90	100	125
Bolt-hole circle diameter ± 0,2 (mm)	F		47	54	63	78	85	98	110	120	148
Flange outside diameter -0,2 (mm)	G		53	63	72	87	98	112	128	140	165
Thread	H		6xM4	6xM5	6xM5	6xM6	6xM6	6xM8	6xM8	6xM10	6xM12
Thread depth (mm)	I		6	8	9	10	10	10	12	15	16
Centering length -0,2 (mm)	J		3	5	5	5	5	6	9	10	13.5
Distance (mm)	K		8	11	11	12	12	15	21	19	25
Distance (mm)	L		27	35	37	39	44	47	59	67	82
Distance ("F" Version) (mm)	L <sup>F</sup>		27	37	39	41.5	47	51.5	62	75	94
Distance (mm)	M		6.5	7.5	9.5	11	13	13	14.5	18	22.5
Screw ISO 4762	N		M5	M6	M8	M10	M12	M12	M14	M16	M20
Tightening torque (Nm)	N		8	15	40	70	120	130	210	270	500
Clamp ring Ø (mm)	O		49	55	67	85	94	110	121	134	157
Diameter (mm)	O <sub>1</sub>		35	42	49	62	67	75	84	91	112
Diameter h7 (mm)	O <sub>2</sub>		27	36	39	50	55	65	72	75	92
Distance between centers (mm)	P		17.5	19	23.5	30	32.5	39	43.5	45	52
Distance (mm)	R		2.5	2.5	2.5	2.5	3	3	4	4	4.5
Moment of inertia (10 <sup>-3</sup> kgm <sup>2</sup> )	J <sub>ges</sub>		0.15	0.25	0.50	1.60	2.70	5.20	8.60	20	31.5
Approx. weight (kg)			0.4	0.7	1.0	1.3	2.0	3.0	4.0	5.5	10
Actuation path (mm)			1.5	1.5	1.7	1.9	2.2	2.2	2.2	2.2	3.0

A<sup>F</sup>, B<sup>F</sup>, L<sup>F</sup> = Full disengagement version